

2014 NDSPLS MEMBERSHIP DIRECTORY

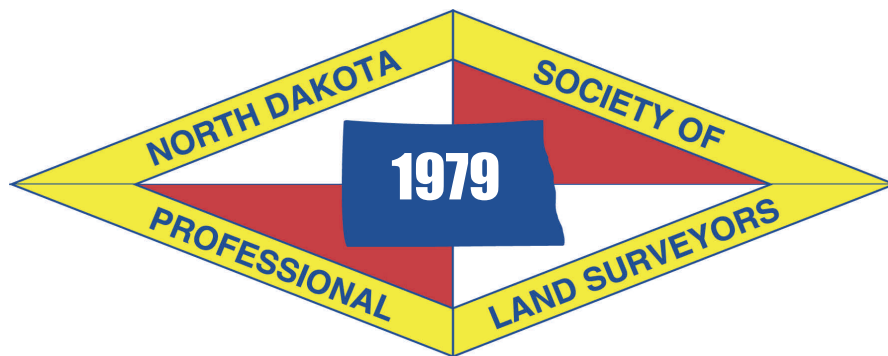

NORTH DAKOTA SOCIETY OF PROFESSIONAL LAND SURVEYORS

Affiliate of the National Society of Professional Surveyors

North Dakota Society of Professional Land Surveyors

1811 East Thayer Avenue
Bismarck, ND 58501

Phone: 701-222-3499

Fax: 701-222-0103

Email: info@ndspls.org

Website: www.ndspls.org

TABLE OF CONTENTS

Officers and Directors..... 1	Section 4. The Secretary Shall.....9
Committees and Chairmen..... 1	Section 5. The Treasurer Shall.....9
Past Presidents..... 2	Section 6 The Past President Shall. 10
Survey Excellence Award..... 2	Bylaw V - Committees..... 10
Constitution and Bylaws 3	Section 1. Standing Committees 10
Article 1..... 3	Section 2. Education 10
Section 1. Name and Location..... 3	Section 3. Ethics..... 10
Article 2 --Objectives..... 3	Section 4. Legislation and By-laws.... 10
Section 1..... 3	Section 5. Manual..... 10
Section 2..... 3	Section 6. Membership..... 11
Section 3..... 3	Section 7. Nominating 11
Section 4..... 3	Section 8. Public Information..... 11
Section 5..... 3	Section 9. Education Assistance
Section 6..... 3	Program 11
Section 7..... 3	Section 10. Administrative Secretary 11
Section 8..... 3	Section 11. Policy & Procedures 11
Article 3 -- Bylaws 4	Section 12. Special Committees 11
Bylaw I - Members 4	Bylaw VI - Chapters 12
Section 1. Qualification of Members ... 4	Section 1. Organization 12
Section 2. Classes of Members 4	Section 2. Purpose..... 12
Section 3. Application 4	Section 3. Members 12
Section 4. Delinquency 5	Section 4. Officers..... 12
Section 5. Expulsion 5	Section 5. Meetings..... 12
Section 6. Property Rights 5	Section 6. Dues..... 13
Bylaw II -- Members' Meetings 6	Bylaw VII - Finances 13
Section 1. Annual Meeting..... 6	Section 1. Fiscal Year 13
Section 2. Special Meetings..... 6	Bylaw VIII - Dues..... 13
Section 3. Quorum 6	Section 1. Annual Dues..... 13
Section 4. Notice..... 6	Bylaw IV - Amendments 13
Section 5. Membership Call..... 6	Section 1 13
Section 6. Votes..... 6	Section 2 13
Section 7. Mail Votes 6	Section 3 13
Section 8. Rules of Order..... 7	Ethics 14
Bylaw III - Directors..... 7	Standards of Integrity..... 14
Section 1. The Board of Directors..... 7	Rules of Professional Conduct..... 14
Section 2. Chartering 7	2014 Alpha Membership Listing..... 19
Section 3. Meetings 7	2014 LS Numbers 22
Section 4. A Quorum..... 7	2014 Members 26
Section 5. Reimbursement..... 7	Membership Data..... 47
Section 6. Financial Statements 7	
Section 7. Borrowing..... 8	
Section 8. Corporate Seal..... 8	
Section 9. Executive Committee 8	
Bylaw IV - Officers 8	
Section 1. Election of Officers..... 8	
Section 2. The President Shall..... 9	
Section 3. The President-elect Shall... 9	

**NORTH DAKOTA SOCIETY OF
PROFESSIONAL LAND SURVEYORS**

Affiliate of the National Society of Professional Surveyors

Administrative Office

1811 East Thayer Avenue
Bismarck, ND 58501
Nancy Buechler & Mona Livdahl, Administrative Secretary
Phone: 701-222-3499
Fax: 701-222-0103
Email: info@ndspls.org
Website: www.ndspls.org

Officers and Director

President Steve Langlie
President Elect Gregg Orvik
Secretary Andra Marquardt
Treasurer Aaron Hummert
Past President Chris Jordheim
NSPS Governor Curt Glasoe
Flatlanders Chapter Ryan Link
Badlands Chapter Brian Schmalz
Great Plains Chapter Jeff Jelinek
Missouri Breaks Chapter VACANT
Missouri River Chapter Tim Langerud
Northern Lights Gregg Orvik

Committees and Chairmen

Admin Secretary Steve Ackerman & Gary Ness
Awards Steve Rutzen
2015 Convention Great Plains Chapter
Education Gregg Orvik
Education Assistance Program Matt Weeks
Ethics Alan Erickson
GIS Aaron Norby
Historical LeRoy Kautz
Legislation & Bylaws Larry Smith & Curt Glasoe
Membership Aaron Hummert
Nominations Chris Jordheim
Policy/Procedures Manual Great Plains Chapter
Public Information Todd Norton
Recommended Guidelines for
Standards of Practice Manual Greg Johnson
Trigstar Jeff Jelinek
Web Page Kent Orvik

Official Publication
49th Parallel
printed quarterly
February, May, August, November

2014 NDSPLS MEMBERSHIP DIRECTORY

SURVEY EXCELLENCE AWARD

Russell E. Kastle	1987
Carl S. Vender	1988
Harold G. Lusk	1989
Alan W. Erickson	1990
Kenneth J. Link	1992
Doug Herzog	1996
Greg Johnson	1997
Steve Ackerman	1998
Ray LeClerc	1999
Mark Aughtman	2002
Rolly Ackerman	2003
Larry Smith	2004
Rick Leach	2005
Larry Smith	2006
Leland Krein	2008
LeRoy Kautz	2010
Brian Portwood	2013
Curt Glasoe	2014

PAST PRESIDENTS

T. S. Madson	Feb 16, 1979	
DeLane R. Meier	1979	1981
Carl S. Vender	1981	1983
Kenneth J. Link	1983	1984
Rodney A. Westrum	1984	1985
Rolly B. Ackerman	1985	1986
Douglas A. Herzog	1986	1987
Gregory L. Johnson	1987	1988
Michael P. Fandrich	1988	1989
Curtis W. Glasoe	1989	1990
Brian J. Rittenhouse	1990	1991
Donald F. Kaufman	1991	1992
Larry J. Smith	1992	1993
Rodney A. Westrum	1993	1994
Leo J. Horgan	1994	1995
Gary Bean	1995	1996
Steve Ackerman	1996	1997
Michael Zimny	1997	1998
Gary Ness	1998	1999
Robert D. Zahn	1999	2000
Roger Grimsley	2000	2001
Matt Weeks	2001	2002
Michael Sansom	2002	2003
Mark Aughtman	2003	2004
Rick Leach	2004	2005
Kent Orvik	2005	2006
Jim Alber	2006	2007
Steve Volesky	2007	2008
Dan Fischer	2008	2009
Robert Procive	2009	2010
Holly Beck	2010	2011
Kirk Jorgenson	2011	2012
Tim Langerud	2012	2013
Chris Jordheim	2013	2014

CONSTITUTION AND BYLAWS
(Amended February, 2014)

Article 1

Section 1. Name and Location.

The name of this corporation shall be North Dakota Society of Professional Land Surveyors. Incorporated under the laws of the State of North Dakota for a perpetual term, from and after the date of filing the Articles of Incorporation, located at 1811 East Thayer Avenue, Bismarck, North Dakota 58501, County of Burleigh, State of North Dakota, or in such other place or places as the Board of Directors may appoint and find necessary or convenient.

Article 2 – OBJECTIVES

The principle objectives of the North Dakota Society of Professional Land Surveyors are:

Section 1.

To unite all the Professional Land Surveyors in the State of North Dakota.

Section 2.

To elevate the standards of the surveying profession in the State of North Dakota.

Section 3.

To establish basic minimum requirements for surveys.

Section 4.

To assist in promoting legislation and educational programs to improve the professional status of the land surveyor.

Section 5.

To work in cooperation with local, county, state, and federal governments in our field of endeavor.

Section 6.

To uphold a rigid code of ethics.

Section 7.

To strive to improve our relations with our clients and the public by doing our work with precision and integrity.

Section 8.

To maintain a good relationship between Land Surveyors and Engineers.

Article 3 – BYLAW I – MEMBERS

Section 1. Qualification of Members

The members of this society shall be those persons who

Shall be eligible for membership under the provisions of Section 2, and
Shall have been elected to membership, upon the recommendation of the Membership
Committee.

Section 2. Classes of Members

The members of this society shall be classified in the following classes:

PROFESSIONAL MEMBERS are those members who are registered as Land Surveyors pursuant to the laws of the State of North Dakota.

LAND SURVEYOR INTERN are those members who have met the requirements pursuant to the laws of the State of North Dakota.

ASSOCIATE MEMBERS are those members who are registered and in good standing as land surveyors either in any State of the United States other than North Dakota or in any Province of Canada or are those members who have an affiliate interest in the surveying profession.

SUSTAINING MEMBERS are those members, either individuals, or partnerships, or corporations, who or which are engaged either in the manufacture or distribution of surveying instruments or equipment, or in the compilation or reproduction of maps, or in the performance of services for land surveyors.

STUDENT MEMBERS are those members who are full-time students studying surveying.

HONORARY MEMBERS are those members who have attained unusual professional recognition by their contributions to the profession of Land Surveying.

LIFE MEMBERS are those members who have attained 60 years of age and have retired from active practice as Land Surveyors and who have paid dues for each of the nine years preceding and also in the year which they attained such age or so retired, whichever is later.

Section 3. Application

All applications for membership shall be presented to the Secretary upon a form prescribed by the Executive Committee and accompanied by the dues for the current membership year.

Section 4. Delinquency

Dues notices shall be mailed to the last known address of each member by November 15 of each year from the Secretary to each member. Dues shall be paid on or before January 1 and membership

2014 NDSPLS MEMBERSHIP DIRECTORY

shall automatically and without any notice or hearing or any other action by anyone, expire on the thirty-first (31) day in January, unless said member shall have paid said annual dues on or before said thirty-first (31) day of January.

Section 5. Expulsion

If and when the Ethics Committee shall notify the Secretary that any member either

- Has ceased to be eligible for membership in the class in which they are a member, or
- Has been found guilty for any felony, or
- Has violated any provision or any code of ethics therefore adopted by this society, or
- Has willfully or repeatedly obstructed any purpose or proper activity of this society, or
- Has been guilty of any other conduct detrimental to either this Society or the profession of Land Surveying.

Then the Secretary shall mail to said member written notice specifying one or more of said grounds for expulsion that said member will, automatically and without any further notice or hearing or other action by anyone, be expelled from membership in this society on the thirtieth (30) day following the date of the mailing of such notice, unless said member shall show cause, in a written statement delivered to the Secretary within thirty (30) days following the date of said mailing why said member should not be expelled from membership. If and when Secretary shall have received any such written statement of cause, the Secretary shall notify said member of the time and place of the next meeting of the Executive Committee when and where said member may be heard with respect to their expulsion. After said hearing, said member may be expelled by the Executive Committee, may appeal to the next Annual Meeting of the members held not earlier than thirty (30) days after such expulsion, and such expelled member may be reinstated by the votes of a majority of the members who vote on a motion to reinstate said former member.

Section 6. Property Rights

No member as such shall have any right, title or interest in or to any property of this Society. Upon the death or dissolution of any member or any other expiration of any membership or the expulsion of any member, no payment of any kind or amount shall become payable by this Society to the former member whose membership has expired or who or which has been expelled.

Article 3 – BYLAW II – MEMBERS' MEETINGS

Section 1. Annual Meeting

There shall be one Annual Meeting held each year at such time and place as the Board of Directors may ordain, and at which time, the President, President-Elect, Vice President, Secretary, and Treasurer shall be installed, annual reports received, and other business which rightfully may come before the meeting, may be transacted.

2014 NDSPLS MEMBERSHIP DIRECTORY

Section 2. Special Meetings

Special meetings of the Society may be called whenever and wherever the President or the Board of Directors may deem advisable.

Section 3. Quorum

At each Annual or Special meeting of the members, ten (10) of the total number of Professional Members shall constitute a quorum.

Section 4. Notice

Notice of an Annual Meeting shall be mailed to every member's last known post office address, not less than thirty (30) days prior to such meeting and for special meetings, not less than five (5) days notice so mailed shall be given. Such notice shall state the time of such meetings and may be either an individual notice or part of any publication of the Society.

Section 5. Membership Call

A Special Meeting of the Society may be called upon the written request of twenty (20) voting members of the Society upon notice as above provided for special meetings.

Section 6. Votes

Each Professional Member shall be entitled and restricted to one vote in the affairs of this Society; and there shall be no cumulative voting. Honorary Members, Associate Members, Sustaining Members, and Student Members shall have no vote.

Section 7. Mail Votes

Any member who is entitled to vote at, but who is absent from, any meeting of the members may vote by mail on the ballot herein prescribed upon any election, motion, resolution, or amendment which the Board of Directors may, in its discretion, submit to the members for vote by them. Such ballot may be in the form prescribed by the Board of Directors and shall set forth the exact text of the proposed election, motion, resolution, or amendment to be voted upon at such meeting, and spaces in which such members may indicate his/her affirmative or negative vote thereon. Such member shall express his/her vote by making an "x" in the appropriate space upon such ballot. Such ballot may be embossed by the NDSPLSs Corporate Seal and when received by this association, before said meeting shall have been called to order, shall be accepted and counted as the vote of such absent member at such meeting.

Section 8. Rules of Order

Except as otherwise provided in these bylaws or in any standing rules of procedures not inconsistent with these bylaws which shall have been adopted at any meeting of the members, "Roberts Rules of Order – Revised" shall be the parliamentary authority for the conduct of meetings of the members.

Article 3 – BYLAW III – DIRECTORS

Section 1. The Board of Directors

Shall be comprised of a body of Directors who shall be Professional Members in good standing. The members of the Board shall be the Past President, President, President-Elect, Vice President, Secretary, Treasurer, and the Governor to the National Society of Professional Surveyors of the Society plus the President of each Chapter. The maximum number of Chapters in North Dakota shall be eight (8). The President of the North Dakota Society of Professional Engineers shall be an ex-officio member. Ex-officio members have no voting privileges on the Board of Directors.

Section 2. Chartering

The Board shall have authority to make rules and regulations for chartering, combining, or dissolving chapters.

Section 3. Meetings

The Board of Directors shall meet regularly at such times and places as the board may determine. Special meetings may be called by the President, or the Board of Directors, or a majority of the Directors. All meetings shall be held on such notice, if any, as the Board may prescribe, but any business may be transacted at any meeting without mention of such business in the notice, if any, of the meeting.

Section 4. A Quorum

Shall consist of a majority of the Directors. A majority vote of the Directors present shall decide all questions, except where a greater vote is expressly required by law of these bylaws.

Section 5. Reimbursement

The reimbursement, if any, of the Directors or Officers or both may be fixed at any Annual Meeting of the members.

Section 6. Financial Statements

The Board of Directors shall have the books of this Society examined by an outside source at least once in each alternate fiscal year. The report of the findings shall be made at the next Annual Meeting of the members.

Section 7. Borrowing

The Board of Directors shall have power which may be exercised only by a vote of a majority of all the Directors, to authorize and approve the borrowing of money and the pledging and mortgaging of any or all of the assets of the Society as a security for the sums to be borrowed.

Section 8. Corporate Seal

The Board of Directors may adopt, alter, or abandon the use of a Corporate Seal.

2014 NDSPLS MEMBERSHIP DIRECTORY

Section 9. Executive Committee

The Board of Directors may appoint an Executive Committee of not less than three (3) Directors, one of whom shall be the President. Such committee shall not have any authority either

To fill any vacancy either in any elective office or in its own membership or on the Board of Directors, or

To employ or discharge any Executive Secretary for this Society, or

To call any meeting of the membership, or

To meet or otherwise to act at any time when either the Board of Directors or the members are holding a meeting, or

To do anything which is required by law to be done only by the Board of Directors and which said board cannot lawfully delegate to such a committee.

But said committee shall have such other powers and duties as the Board of Directors may delegate to or require of it.

Article 3 – BYLAW IV – OFFICERS

Section 1. Election of Officers

At the annual meeting of the members, voting members, shall elect from among their number, a Vice President for a regular term of one administrative year commencing after the Annual Meeting is adjourned following the Annual Meeting of members, and on odd numbered years a Secretary, and on even numbered years a Treasurer for regular terms of two administrative years commencing at the adjournment of the Annual Meeting of the members, and on even numbered years an NSPS Governor for regular terms of two administrative years commencing at the adjournment of the Annual Meeting of the members.

Neither President, President-Elect, nor Vice President shall be eligible for re-election as such Officer at the expiration of the full regular term of one year each for which they have served: and neither Secretary nor Treasurer shall be eligible for re-election as such Officer at the expiration of the second of two successive full regular terms of two years each for which they have served: but an NSPS Governor shall be eligible for re-election as an NSPS Governor without any limitation on the number of terms of service.

The former President shall be designated as the Past President following the expiration of the term of service as President, the Vice President shall succeed to the office of President-Elect, and the President-Elect shall succeed to the office of President.

Section 2. The President Shall:

Preside over all meetings of the members and of the Board of Directors and of the Executive Committee.

Have all authority ordinarily held by the President of a corporation.

2014 NDSPLS MEMBERSHIP DIRECTORY

Appoint the members of all standing and special committees from any class of membership he/she desires, and he/she shall serve ex-officio as a member of all committees.

Section 3. The President-Elect Shall:

Perform such duties of the President as the President may designate; in the absence or disability of the President, the President-Elect shall perform all the duties of the President. Do and perform such other duties as from time to time may be assigned by the Board of Directors, or required by the President.

Section 4. The Secretary Shall:

Take or supervise the taking of complete minutes of all meetings of the members and of the board of directors and of the executive committee; and
Have custody of this Society's minute book and of its corporate seal, if any; and
Submit to the Annual Meeting of the members a report covering the business of this Society for the previous fiscal year and showing the condition of this Society at the close of said fiscal year; and
Give, or cause to be given, all notices as required by law or these bylaws; and
Perform such additional duties as may be required of him/her by the Board of Directors.

Section 5. The Treasurer Shall:

Have custody of and account for all funds and property of this Society; and
Keep complete books and records of all financial transactions of this Society; and
Perform such additional duties as may be required of him/her by the Board of Directors.

Section 6: The Past President Shall:

Do and perform such other duties from time to time that may be assigned by the Board of Directors or the President; and
Serve as the Nominating Committee Chairman, and supervise the counting of all votes at the Annual Meeting.

Section 7:

Each vacancy occurring in any office of the President, Vice President, Secretary, or Treasurer or an NSPS Governor, other than by the removal of such Officer by the members or the expiration of a regular term, may be filled until the next Annual Meeting of the members by a vote of the remaining Directors.

Article 3 – BYLAW V – COMMITTEES

Section 1. Standing Committees

The President, promptly following each Annual Meeting of the members, shall appoint, from among the members of this association, the members of each of the following Standing Committees: Edu-

2014 NDSPLS MEMBERSHIP DIRECTORY

cation, Ethics, Legislation and Bylaws, Manual, Membership, Nominating, Public Information, Education Assistance Program, Administrative Secretary, and Policy and Procedures.

Section 2. The Education Committee

Shall promote and encourage educational facilities and activities which the committee deems to be advantageous or beneficial to students who are preparing to follow the profession of Land Surveying.

Section 3. The Ethics Committee

Shall prepare and recommend to the Board of Directors a Code of Ethics and amendments thereof from time to time. It shall investigate all questions arising under said Code and recommend to said Board action to be taken by said Board concerning any such questions.

Section 4. The Legislation and Bylaws Committee

Shall study enacted and proposed legislation affecting land surveyors, and promote legislation which will be in the public interest and will tend to elevate the standards of land surveying. It shall review this Association's bylaws each year; and recommend to the Board of Directors such amendments as said Committee may deem to be advisable.

Section 5. The Manual Committee

Shall prepare and recommend to the Board of Directors a manual of recommended standards for the proper practice of the profession of land surveying, and amendments thereof from time to time.

Section 6. The Membership Committee

Shall review all applications for membership in this Association and shall recommend to the Secretary each applicant which said committee shall deem to be eligible for membership, together with said committee's recommendation concerning the classification of each recommended application. Said committee, without prior application, may recommend to said Board the admission of qualified persons to membership in this Association as Honorary Members, Life Members, or Sustaining Members. The Membership Committee shall also maintain a complete and current record of all the members of this association, listing them alphabetically, according to classes of members, and according to counties, states or province, and political subdivisions thereof. Said committee shall also strive to increase the membership of this association.

Section 7. The Nominating Committee

Shall, at each Annual Meeting of the members, nominate one or more nominees for election to each office and each directorship for which an election will be held at said meeting.

Section 8. The Public Information Committee

Shall promote publicity relative to this Association and its activities and programs. It shall edit and publish a publication which shall represent high standards of professional land surveying. This committee shall coordinate all programs not covered by the Education Committee. It shall assist the edi-

2014 NDSPLS MEMBERSHIP DIRECTORY

tor of the 49th Parallel by providing timely material for publication.

Section 9. The Education Assistance Program Committee

Shall promote the continuance of the land surveying professional by sponsoring surveying scholarships at institutes of higher education. This committee shall format an application form and the selection criteria for the scholarship. This committee shall recommend annually the number and dollar amount of scholarships to the Board of Directors.

Section 10. The Administrative Secretary Committee

Shall conduct the search for and recommend the hiring of the Administrative Secretary. This committee shall review annually the performance of the Administrative Secretary, and recommend any changes in duties, responsibilities, and contract rates to the Board of Directors.

Section 11. Policy and Procedures Committee

Shall review motions from each general membership meeting and Board of Director's meetings and determine if the motion dictates a policy or procedure within the organization. If so, add to the Manual, then submit a new Manual at the Spring Board of Director's meeting.

Section 12. Special Committees

May be appointed by the president, from among the members of this association for such purposes as he/she may, from time to time, deem to be expedient.

Historian

Awards

Convention

Metric

Article 3 – BYLAW VI – CHAPTERS

Section 1. Organization

Local Chapters of this Society may be established by the Board of Directors upon the petition of at least five members, who wish to form a chapter in their area. The petition should include a chapter name and a list of counties to be non-exclusively served by the chapter. This list is subject to change at any time by the Board of Directors. The chapters shall also be numbered in the order in which they are established. The maximum number of chapters in North Dakota shall be eight (8).

Section 2. Purpose

The purpose of the Chapters shall be to assist the Society in fulfilling its objectives. The chapters shall actively promote membership in the Society. The chapters shall also provide fellowship, guidance, and assistance to students and technicians seeking a place in the profession by including them in chapter activities.

2014 NDSPLS MEMBERSHIP DIRECTORY

Section 3. Members

Only members of the Society shall be eligible for membership in their respective chapters.

Section 4. Officers

The Chapter Officers shall consist of a President, who shall conduct the chapter business; a Vice President who assists the President or assumes the duties of the President in his/her absence; and a Secretary and a Treasurer, or Secretary/Treasurer who shall keep a record of the business and finances of the Chapter. Committees may be appointed by the President to assist him/her in his/her term of office. The officers shall be elected annually. All voting members shall be eligible for office.

Section 5. Meetings

The Chapter shall hold at least two meetings throughout the year. A notice and agenda of the meetings shall be mailed to the members and the NDSPLS President at least ten (10) days prior to the meeting. The meetings shall be conducted according to "Robert's Rules of Order-Revised." The minutes of the meetings shall be mailed to the members and the NDSPLS President and Secretary. One-third of the voting chapter members shall constitute a quorum.

Section 6. Dues

The Chapter shall present an annual report to the Society at the Annual Meeting containing a list of its members and summary of its activities and financial status.

Article 3 – BYLAW VII – FINANCES

Section 1. Fiscal Year

The fiscal year of this Society shall commence on the first day in July in each year and shall end on the last day of June in the following year.

Article 3 – BYLAW VIII – DUES

Section 1. Annual Dues

Each Professional Member shall be assessed, as of the first day of each calendar year; such amount of annual dues for said calendar year as shall have been adopted by the members prior to the commencement of said calendar year. No annual dues shall be assessed against any Honorary Member or any Life Member. Annual dues payable by Associate Members shall be assessed by the Board of Directors.

Article 3 – BYLAW IV – AMENDMENTS

Section 1.

2014 NDSPLS MEMBERSHIP DIRECTORY

These bylaws or any part of the same may be amended, abridged, altered, added to, or repealed by the membership of this Society and not otherwise, at any Annual Membership Meeting, by a two-thirds vote of the voting membership present or by proxy.

Section 2.

Bylaw amendments may be proposed by the Board of Directors or by a petition of twenty (20) voting members of the Society. All proposed amendments to the bylaws must be delivered to the Secretary not less than sixty (60) days prior to the date of the Annual Meeting. The Secretary must thereupon mail a copy of such proposed amendments to all members of every class, not less than thirty (30) days prior to such annual meeting.

Section 3.

The Secretary shall mail a copy of all amendments to the members of every class following adoption.



ANDRA MARQUARDT, SECRETARY

FEBRUARY, 2014

2014 NDSPLS MEMBERSHIP DIRECTORY

ETHICS

In order to establish and maintain a high standard of integrity, skills, and practice in the profession of land surveying, the following code of ethics promulgated in accordance with NDSPLS By-Law V, Section 3, and hereafter referred to as the Rules of Professional Conduct, shall be binding upon every person holding a membership in the NDSPLS.

The rules as set forth herein are specifically designed to further safeguard the life, health, property, and public welfare of the citizens of the State of North Dakota, and shall be construed to be a reasonable exercise of the police power vested in the NDSPLS by virtue of the By-Laws of the NDSPLS. NDSPLS can establish conduct, policy, and practices to be adopted in keeping with the powers hereinabove stated.

All members of the NDSPLS are charged with having knowledge of the existence of the reasonable rules and regulations hereinafter provided for his/her professional conduct as a surveyor, and also shall be deemed to be familiar with their several provisions and to understand them. Such knowledge shall encompass the understanding that the practice of land surveying is a privilege as opposed to a right, and the Surveyor shall be forthright and candid in his/her statements or written responses to the Society or its representatives on matters pertaining to professional conduct.

STANDARDS OF INTEGRITY

The member shall be guided in all his/her professional relations by the highest standards of integrity, and shall act in professional matters for each client or employer as a faithful agent or trustee.

RULES OF PROFESSIONAL CONDUCT

(SECTION 1) - THE MEMBER WILL BE GUIDED IN ALL HIS/HER PROFESSIONAL RELATIONS BY THE HIGHEST STANDARDS OF INTEGRITY, AND WILL ACT IN PROFESSIONAL MATTERS FOR EACH CLIENT OR EMPLOYER AS A FAITHFUL AGENT OR TRUSTEE.

- a. He/she will be realistic and honest in all estimates, reports, statements, and testimony.
- b. He/she will admit and accept his/her own errors when proven obviously wrong and refrain from distorting or altering the facts in an attempt to justify his/her decision.
- c. He/she will advise his/her client or employer when he/she believes a project will not be feasible.
- d. He/she will not accept outside employment to the detriment of his/her regular work or interest, or without the consent of his/her employer.

(SECTION 2) - THE MEMBER SHALL STEADFASTLY PROTECT THE SAFETY, HEALTH, AND WELFARE OF THE PUBLIC IN THE PERFORMANCE OF HIS/HER PROFESSIONAL DUTIES. IF HIS/HER JUDGEMENT IS OVERRULED BY NONTECHNICAL AUTHORITY, HE/SHE WILL CLEARLY POINT OUT THE CONSEQUENCES, HE/SHE WILL NOTIFY THE PROPER AUTHORITY OF ANY OBSERVED CONDITIONS WHICH ENDANGER PUBLIC

2014 NDSPLS MEMBERSHIP DIRECTORY

SAFETY AND HEALTH.

- a. He/she will regard his/her duty to the public welfare as paramount.
- b. He/she shall seek opportunities to be of constructive service in civic affairs and work for the advancement of the safety, health, and well-being of his/her community.
- c. He/she will not complete, sign, or seal documents which are not in the best interests of the public's health and welfare and in conformity with accepted standards. If the client or employer insists on such unprofessional conduct, he/she shall notify the proper authorities and withdraw from further service on the project.

(SECTION 3) - THE MEMBER WILL NOT ADVERTISE HIS/HER WORK OR MERIT IN A SELF-LAUDATORY MANNER, AND WILL AVOID ALL CONDUCT OR PRACTICE LIKELY TO DISCREDIT OR UNFAVORABLY REFLECT UPON THE DIGNITY OR HONOR OF THE PROFESSION.

- a. It shall be considered unprofessional and inconsistent with honorable and dignified bearing for any surveyor to advertise his/her work or merit in a self-laudatory language, or in any manner derogatory to the dignity of the profession. Professional work should come to the member by virtue of his/her experience, competence, and reputation. Solicitation of employment, criticism of competitors, or self-laudation is degrading to the professions, and is unethical. All advertising shall be in good taste, relating only the experience and the surveyor's availability to perform professional services for which he/she is qualified; and so done in a restrained manner that perpetuates the dignity of the profession.

(SECTION 4) - THE MEMBER WILL ENDEAVOR TO EXTEND PUBLIC KNOWLEDGE AND APPRECIATION OF THE SURVEYING PROFESSION AND TO PROTECT THE PROFESSION FROM MISREPRESENTATION AND MISUNDERSTANDING.

- a. He/she shall not issue statements, criticisms, or arguments on matters connected with public policy which are inspired or paid for by private interest, unless he/she indicates on whose behalf he/she is making the statement.

(SECTION 5) - THE MEMBER WILL EXPRESS AN OPINION ON SURVEYING SUBJECTS ONLY WHEN FOUNDED ON ADEQUATE KNOWLEDGE AND HONEST CONVICTION.

- a. The member will insist on the use of facts in reference to a surveying project on a group discussion, public forum, or publication of articles.

(SECTION 6) - THE MEMBER WILL UNDERTAKE ASSIGNMENTS FOR WHICH HE/SHE WILL BE RESPONSIBLE ONLY WHEN QUALIFIED BY TRAINING OR EXPERIENCE AND HE/SHE WILL ENGAGE, OR ADVISE ENGAGING, EXPERTS AND SPECIALISTS WHENEVER THE CLIENT'S OR EMPLOYER'S INTERESTS ARE BEST SERVED BY SUCH SERVICE.

(SECTION 7) - THE MEMBER WILL NOT DISCLOSE CONFIDENTIAL INFORMATION CONCERNING THE BUSINESS AFFAIRS OR TECHNICAL PROCESSES OF ANY PRESENT OR FORMER CLIENT OR EMPLOYER WITHOUT HIS/HER CONSENT.

2014 NDSPLS MEMBERSHIP DIRECTORY

- a. While in the employ of others, he/she will not enter promotional efforts or negotiations for work or make arrangements for other employment as a principal or to practice in connection with a specific project for which he/she has gained particular and specialized knowledge without the consent of all interested parties.

(SECTION 8) - THE MEMBER WILL ENDEAVOR TO AVOID A CONFLICT OF INTEREST WITH HIS/HER EMPLOYER OR CLIENT, BUT WHEN UNAVOIDABLE, SHALL FULLY DISCLOSE THE CIRCUMSTANCES TO HIS/HER EMPLOYER OR CLIENT.

- a. The member will inform his/her client or employer of any business connections, interests, or circumstances which may be deemed as influencing his/her judgment or the quality of his/her services to his/her client or employer.
- b. When in public service as a member, advisor, or employee of a governmental body or department, the member shall not participate in considerations or actions with respect to services provided by him/her or his/her organization.
- c. The member shall not solicit or accept a contract from a governmental body on which a principal or officer of his/her organization serves as a member.

(SECTION 9) - THE MEMBER WILL UPHOLD THE PRINCIPLE OF APPROPRIATE AND ADEQUATE COMPENSATION FOR THOSE ENGAGED IN SURVEYING SERVICES.

- a. He/she will not undertake or agree to perform any surveying services on a free basis, except for civic, charitable, religious, eleemosynary nonprofit organizations when the professional services are advisory in nature.
- b. The member shall not compete with another member for potential work on the basis of charges by reducing his/her normal fees after having been informed of the charges proposed by the other; nor undertake any work at a price that will not permit a satisfactory professional performance.
- c. He/she will not accept remuneration from either an employee or an employment agency for giving employment.
- d. When hiring other surveyors, he/she shall offer a salary according to the surveyor's qualifications and the recognized standards in the particular geographical area.
- e. When employed as a sales representative, he/she will not offer or give consultation, or advice other than specifically applying to the equipment being sold.

(SECTION 10) - THE MEMBER WILL NOT ACCEPT COMPENSATION, FINANCIAL OR OTHERWISE, FROM MORE THAN ONE INTERESTED PARTY FOR THE SAME SERVICE, OR FOR SERVICES PERTAINING TO THE SAME WORK, UNLESS THERE IS FULL DISCLOSURE TO AND CONSENT OF ALL INTERESTED PARTIES.

- a. He/she will not accept commissions or allowances, directly or indirectly from contractors or their parties dealing with his/her clients or employer in connection with work for which he/she is responsible.

2014 NDSPLS MEMBERSHIP DIRECTORY

(SECTION 11) - THE MEMBER WILL NOT COMPETE UNFAIRLY WITH ANOTHER BY ATTEMPTING TO OBTAIN EMPLOYMENT OR ADVANCEMENT OR PROFESSIONAL ENGAGEMENTS, BY TAKING ADVANTAGE OF A SALARIED POSITION, BY CRITICIZING OTHER MEMBERS OR BY OTHER IMPROPER OR QUESTIONABLE METHODS.

- a. The member will not attempt to supplant another member in a particular employment after becoming aware that definite steps have been taken toward the other's employment.
- b. He/she will not offer to pay, either directly or indirectly any commission, gift, political contribution, or other consideration in order to secure work, exclusive of securing salaried positions through employment agencies. Contributions made to, or on behalf of any particular candidate or political party, either directly or indirectly, should be in a limited amount, and made only after most serious considerations.
- c. He/she shall not solicit or accept any engagements on a contingent fee basis if payment depends on a finding of economic feasibility, or other conclusions by the member.
- d. While in either a private or governmental position, he/she will not accept part-time surveying services without specific consent of his/her employer or government department superior.
- e. The member will not use equipment, supplies, or office facilities of his/her employer to carry on outside private practice without consent.

(SECTION 12) - THE MEMBER WILL NOT ATTEMPT TO INJURE, MALICIOUSLY OR FALSELY, DIRECTLY OR INDIRECTLY, THE PROFESSIONAL REPUTATIONS, PROSPECTS, OR PRACTICE OF ANOTHER MEMBER, NOR WILL HE/SHE INDISCRIMINATELY CRITICIZE ANOTHER MEMBER'S WORK IN PUBLIC. IF HE/SHE BELIEVES THAT ANOTHER MEMBER IS GUILTY OF UNETHICAL OR ILLEGAL PRACTICE, HE/SHE SHALL PRESENT SUCH INFORMATION TO THE PROPER AUTHORITY OR ACTION.

- a. The member in private practice will not review the work of another member for the same client, except with the knowledge of such member, or unless the connection of such member's services have been terminated.
- b. The member in governmental, industrial, or educational employ is entitled to review and evaluate the work of other members when so required by his/her employment duties.

(SECTION 13) - THE MEMBER WILL NOT ASSOCIATE WITH OR ALLOW THE USE OF HIS/HER NAME BY AN ENTERPRISE OF QUESTIONABLE CHARACTER, NOR WILL HE/SHE BECOME PROFESSIONALLY ASSOCIATED WITH MEMBERS WHO DO NOT CONFORM TO ETHICAL PRACTICES, OR WITH PERSONS NOT LEGALLY QUALIFIED TO RENDER THE PROFESSIONAL SERVICES FOR WHICH THE ASSOCIATION IS INTENDED.

- a. He/she will conform with registration laws in his/her practice of surveying.

2014 NDSPLS MEMBERSHIP DIRECTORY

- b. He/she will not use association with a non-surveyor, a corporation, or partnership, as a "cloak" for unethical acts, but must accept personal responsibility for his/her professional act.

(SECTION 14) - THE MEMBER WILL GIVE CREDIT FOR WORK TO THOSE TO WHOM CREDIT IS DUE, AND WILL RECOGNIZE THE PROPRIETARY INTERESTS OF OTHERS.

- a. Wherever possible, he/she will name the person or persons who may be individually responsible for services, technical papers, or other accomplishments.
- b. When a member uses information supplied to him/her by a client, the information remains the property of the client by the member for others without express permission.
- c. Data, records, and notes made by a member and referring exclusively to his/her employer's work are his/her employer's property.

(SECTION 15) - THE MEMBER WILL COOPERATE IN EXTENDING THE EFFECTIVENESS OF THE PROFESSION BY INTERCHANGING INFORMATION AND EXPERIENCE WITH OTHERS, AND WILL ENDEAVOR TO PROVIDE OPPORTUNITY FOR THE PROFESSIONAL DEVELOPMENT AND ADVANCEMENT OF THE PERSONNEL UNDER HIS/HER SUPERVISION.

- a. He/she will encourage his/her employees' efforts to improve their education.
- b. He/she will encourage his/her employees to attend and present papers at professional and technical society meetings.
- c. He/she will urge his/her employees to become registered at the earliest possible date.
- d. He/she will assign duties of a nature to utilize his/her full training and experience. He/she will provide a prospective employee with complete information on working conditions and his/her proposed status of employment, and after employment will keep him/her informed of any changes in them.

2014 NDSPLS MEMBERSHIP DIRECTORY

2014 Alphabetical Membership Listing

ACKERMAN, ROLLY
ACKERMAN, STEVEN
ALBER, JAMES
ALEXANDER, KORY
ALLERDINGS, MERLIN
ANDERSON, AARON
ANDERSON, NATHAN
APPLETON, ROBERT
ATTERTON, CHAD
AUGHTMAN, MARK
BACKOWSKI, JACOB
BACON, RANDY D.
BAFFERT, JOHN G.
BALLUFF, THOMAS
BANSE, THOMAS
BARGMANN, HERBERT W.
BARTHOLOMEW, BRANDEN
BAUER, CORY
BECK, HOLLY
BEEBE, PATRICK
BEGGS, BRYAN
BERARD, ROBBY L.
BERG, CASEY
BERGHERR, SCOTT
BERNTSEN INTERNATIONAL
INC.,
Billman, Brian
BINSTOCK, DANIEL
BLAUERT, RICHARD
BLOOMENRADER, SCOTT D.
BOECHLER, DEREK
BOECHLER, CHRIS
BOEHNING, DUANE
BOERS, DANIEL

BORGEN, JEROME
BOROWICZ, GARRETT
BRECHT, MARY
BREKKE, CHRIS
Breuer, Chad R.
BROSZ, DANNY
BRUCKNER, JOHN
BUSTA, BRIAN
BUZZERD, GREGORY
CARLSON, ARLEE
CASKEY, GARY G.
CLARKE, SHAWN
CLASEMANN, MICHAEL
COMBS, JOHN
COMER, BLAINE
CONTI, ANTONIO
COOPER, JAMES A.
COULOMBE, GEORGE
DALE, DUSTIN
DOLINAR, WILLIAM
ECKROTH, THOMAS
EDWARDS, HUGH
ELDEVIK, RODNEY F.
ERBELE, BOYD
ERICKSON, ALAN
ERICKSON, DAIN
ESTES, JAMES
ESTVOLD, ALAN
FARRIER, WILLIAM
FISCHER, DANIEL V.
FOLEY, CHRIS
FORBES, BRIAN
FOSTER, RICHARD
FOWLDS, JANELE

FREUER, TYLER
FRIEDT, JASON
FRIEDT, JARED
FRISQUE, DOUGLAS
FROHLICH, JEFF P.
FRONTIER PRECISION,
GARZA, HOLLY
GETCHELL, GUNNAR
GLASOE, CURTIS W.
GLASSER, JAMIE
GLINES, KURT
GOLDSACK, NATHAN
GOSBEE, LOU ANN
GRAVES, DEANE
GREER, GARY
GRIMSLEY, ROGER
GUSTAFSON, JASON
HADDICK, WILLIAM
HAGEN, ROGER
HALE, NORMAN
Hall, Susan
HAMPTON, MARCUS
HANSON, MARK
HANSON, CHAD
HART, JAMES
HEATH, BRIAN R.
HECK, JON D.
HEGLUND, DALE
HERZOG, DOUG
HESSELBACH, WILLIAM
HILLIUS, JOE
HOFFART, BRIAN
HOLM, STEVEN

(Continued on page 20)

2014 NDSPLS MEMBERSHIP DIRECTORY

2014 Alphabetical Membership Listing

(Alpha listing Continued from page 19)

HOMISTON, KC	JORGENSEN, KIRK J.	LINK, KENNETH
HORNADAY, RICK L.	JUNG, JAMES	LOOMER, DONALD
HORST, RONALD	KAINZ, ROBERT	MADLER, CHARLES
HOVENDICK, DAVID	KASEMAN, DARYL	MAIN, JASON
HOWE, KEITH L.	KASTELLE, RUSSELL E.	MALONEY, KEVIN
HUMMERT, AARON	KAUTZ, LEROY	MANCHESTER, RONALD W.
HUNSINGER, TREVOR	KISCH, KURT M.	MARKUSEN, DENNIS J.
HUOTARI, RUSS	KITZAN, RUDY	MARQUARDT, ANDRA L.
HURST, LEE	KNOLL, CARMEN	MARSCHALL, TODD
IDE, JOSHUA	Knudsen, Monte	MARTIN, KEVIN
ILLG, ROBERT	KOHLER, RICHARD	MAY, GEORGE
INDVIK, DONALD	KOHLER, ROBERT JOSEPH	MCCORMICK, KEVIN
INGERSOLL, CHRIS	Kopp, Anthony	MCCOY, TRACE
IRWIN, LELAND	KREBS, GERALD J.	MCELWAIN, JEFFERY
ISAACS, MARK	KREBS, MATHIAS	MEIER, DELANE
JACKSON, EUGENE	KREIN, LELAND L	MESSNER, JOSEPH
JACOBSON, MATTHEW	KUMMER, DOUGLAS W.	MORMAN, CHARLES
JANKE, DELBERT	KURLE, WAYNE	MUNSON, ANDREW
JEFFRIES, JERRY L.	LAAVEG, BLAINE	NAGEL, DEREK
JELINEK, JEFF	LAMBRECHT, TOM	NASH, DAVID
JENSEN, CLEONE	LAMBRECHT, MARK	NASSET, DAVE
JENSEN, NICHOLAS	LANDECKER, DAVID	NESS, JASON
JENSEN, TROY	LANG, RYAN	NESS, GARY
JESKE, JOSHUA	LANGERUD, TIM	NIEMILLER, LANDON
JOHNSON, GREGORY	LANGLIE, STEVEN M.	NOLAN, CHANCE
JOHNSON, KRIS	LAPKA, MIKE	NORBY, AARON
JOHNSON, JARED A.	LARSON, ERIC	NORD, THOMAS
JOHNSON, NEAL	LEACH, RICK	NORTON, TODD
JOHS, CLEARY	LEAS, JARRETT	OAKLAND, TREVOR
JORDAN, MICHAEL	LEE, MANKING	OBRIGEWITCH, GREG
JORDHEIM, CHRISTOPHER D.	LESHOVSKY, THOMAS R.	OBRIGEWITSCH, QUENTIN
JORGENSEN, ROB	LIEBOLD, FELIX	O'DONNELL, LOUIS P.
	LINDVIG, JOHN	OLSON, CARL P.
	LINK, RYAN	

(Continued on page 21)

2014 NDSPLS MEMBERSHIP DIRECTORY

2014 Alphabetical Membership Listing

(Alpha listing Continued from page 20)

OLSON, PETER A.	SAUTER, DAN	THOMASSON, SHAWN
OPSAHL, TROY	SCHAAR, TREVOR	THOMPSON, ROSE
ORVIK, GREGG	SCHIRADO, DUSTIN	THOMPSON, ADAM
ORVIK, KENT	SCHLIEMAN, JIM	THORESON, KENT G.
PAULSON, JOHN	SCHMALZ, BRIAN	TORRES, JERRY
PEARSON, RILEY	SCHUHKNECHT, DOUG	TRAVISS, TOM
PEARSON, JASON	SCHWINDT, DAVID	VAN DYKE, ROBERT
PETERKA, DAREN L.	SCOTT, STEVEN K.	VENDER, CARL
PEZOLDT, DOUGLAS	SEIBEL, STANLEY	VOLESKY, STEVEN A
POPADYNETZ, KURTIS	SEMERAD, JUSTIN	WAGNER, DANIEL
PORTWOOD, BRIAN	SHAFFER, JOHNNIE R.	WALSVIK, ADAM
POWERS, JAMES	SHERLOCK, BECKY R.	WALTER, BRIAN
PRIBULA, GERALD	SKARPHOL, CURTIS	WALTER, ALAN M.
PRIBULA, NICHOLAS	SKATTUM, AARON	WAMRE, ROSS R.
PRIVRATSKY, JAMES	SKINNER, DANIEL	WARNER, DENNIS
PROCIVE, ROBERT	SLEMP, JEREMY	WEEKS, MATTHEW L
PUGH, BILL	SLETTEN, ADAM	WEIGEL, TOM
RAY, MICHAEL	SLETVOLD, DUSTY	WELINSKI, MATTHEW
REBSCH, CHARLES	SMALL, MICHAEL	WESTRUM, RODNEY
RICH, GREGORY	SMITH, LARRY J.	WHETHAM, ALLEN E.
RICHTER, JAMES S.	SMITH, LLOYD	WICKLUND, JOHN R.
RINTAMAKI, EDWARD	SNIDER, DURHAM	WIENS, PETER F.
RITTENHOUSE, BRIAN	SOLEM, DAYNE	WILLIAMSON, CLYDE
ROBERTSON, JASON	SOLLID, NORMAN S.	WINKLER, SCOTT A.
ROBERTSON, BRADLEY	STADLER, NATE	WISTED, BRADLEY
ROBINSON, CHRIS	STANHOPE, BOB	WITTER, DARRYL
ROCK, EDWARD	STATTELMAN, NICK	WITTSTOCK, JEROME C.
RONNING, JEFF	STRAIN, MILES	WOOD, JEREMY
RUDOLPH, KIRBY	STROEING, GREGG	WURGLER, JEREMY
RUGLAND, GREG	SULLIVAN, LARRY	ZAHN, ROBERT
RUTZEN, STEPHEN G.	SWANSON, STEVEN	ZELMER, BRUCE
SANSOM, MICHAEL	SWENSON, THOMAS	Zimmerman, Matt
SAUBER, JOHN	SWENSON, MEGAN	ZIMMERMAN, DAVID
	TARNOWSKI, MIKE	ZIMNY, MICHAEL
	TAYLOR, SHELTON	ZISKA, JAKE

2014 NDSPLS MEMBERSHIP DIRECTORY

2014 Membership Listing with LS Number

LS #	Name		
		LS-1556 - LIFE	BEGGS, BRYAN
LS	HURST, LEE	LS-1766	HAGEN, ROGER
LS	HORST, RONALD	LS-1891 - LIFE	JACKSON, EUGENE
LS	BREKKE, CHRIS	LS-1961	ESTVOLD, ALAN
LS-	TRAVISS, TOM	LS-2257	PRIBULA, GERALD
LS-1139 - PE	MEIER, DELANE	LS-2355 - Life	HERZOG, DOUG
LS-1170	KASTELLE, RUSSELL E.	LS-2356	JOHNSON, GREGORY
LS-1174	WALTER, ALAN M.	LS-2357	JUNG, JAMES
LS-1177	KAUTZ, LEROY	LS-2360 - LIFE	MAY, GEORGE
LS-1178 - LIFE	MORMAN, CHARLES	LS-2363	SMITH, LARRY J.
LS-1179	OAKLAND, TREVOR	LS-2391	ACKERMAN, ROLLY
LS-1186 - LIFE	BOEHNING, DUANE	LS-2439	GLASOE, CURTIS W.
LS-1194	MARKUSEN, DENNIS J.	LS-2491	WICKLUND, JOHN R.
LS-1195	WESTRUM, RODNEY	LS-2511	LAMBRECHT, MARK
LS-1196	RITTENHOUSE, BRIAN	LS-2679	BROSZ, DANNY
LS-1202	ERICKSON, ALAN	LS-2681	LOOMER, DONALD
LS-1222	VENDER, CARL	LS-2758 - LIFE	KOHLER, RICHARD
LS-1225	KUMMER, DOUGLAS W.	LS-2870	MADLER, CHARLES
LS-1229 - LIFE	JENSEN, CLEONE	LS-2884	PROCIVE, ROBERT
LS-1232- LIFE	SCHWINDT, DAVID	LS-2958	ACKERMAN, STEVEN
LS-1238 - LIFE	COMBS, JOHN	LS-2997	WHETHAM, ALLEN E.
LS-1242	LINK, KENNETH	LS-2999	ZIMMERMAN, DAVID
LS-1247	JEFFRIES, JERRY L.	LS-3083	SMITH, LLOYD
LS-1263 - LIFE	INDVIK, DONALD	LS-3085	BARTHOLOMEW, BRANDEN
LS-1265 - LIFE	FOSTER, RICHARD	LS-3132	ZIMNY, MICHAEL
LS-1353	BARGMANN, HERBERT W.	LS-3139	FROHLICH, JEFF P.
LS-1406 - LIFE	BORGEN, JEROME		

(Continued on page 23)

2014 NDSPLS MEMBERSHIP DIRECTORY

(LS # listing Continued from page 22)

LS-3141	SANSOM, MICHAEL	LS-3878	PRIVRATSKY, JAMES
LS-3148 Life	KREIN, LELAND L	LS-3880	KASEMAN, DARYL
LS-3199	ROBERTSON, BRADLEY	LS-3881	ORVIK, GREGG
LS-3213	BACON, RANDY D.	LS-3921	BRECHT, MARY
LS-3214	KREBS, MATHIAS	LS-3950	SEIBEL, STANLEY
LS-3237	GRIMSLEY, ROGER	LS-4019	SHAFFER, JOHNNIE R.
LS-3252	MANCHESTER, RONALD W.	LS-4114	OBRIGEWITCH, GREG
LS-3290	BLOOMENRADER, SCOTT D.	LS-4129	GREER, GARY
LS-3340	HEGLUND, DALE	LS-4184	KITZAN, RUDY
LS-3366	PAULSON, JOHN	LS-4185	SWANSON, STEVEN
LS-3367	VOLESKY, STEVEN A	LS-4358 - PE	PETERKA, DAREN L.
LS-3384	ECKROTH, THOMAS	LS-4431	MARSCHALL, TODD
LS-3409	ELDEVIK, RODNEY F.	LS-4432	NASSET, DAVE
LS-3461	NESS, GARY	LS-4597	KISCH, KURT M.
LS-3463	ORVIK, KENT	LS-4623	MARQUARDT, ANDRA L.
LS-3496	LEACH, RICK	LS-4624	NORTON, TODD
LS-3541	HORNADAY, RICK L.	LS-4626	WAMRE, ROSS R.
LS-3542	JORDAN, MICHAEL	LS-4653	HOWE, KEITH L.
LS-3592	JORGENSEN, KIRK J.	LS-4654	JENSEN, TROY
LS-3593	STANHOPE, BOB	LS-4655	O'DONNELL, LOUIS P.
LS-3594	SOLLID, NORMAN S.	LS-4687	OLSON, CARL P.
LS-3612	HOVENDICK, DAVID	LS-4723	SKARPHOL, CURTIS
LS-3626	WEEKS, MATTHEW L	LS-4727	BERARD, ROBBY L.
LS-3659	ZAHN, ROBERT	LS-4730	ALBER, JAMES
LS-3756	ZELMER, BRUCE	LS-4934	BECK, HOLLY
LS-3801	AUGHTMAN, MARK	LS-4973	GOSBEE, LOU ANN
LS-3855	LINDVIG, JOHN	LS-5014	CASKEY, GARY G.
LS-3856	FISCHER, DANIEL V.		

(Continued on page 24)

2014 NDSPLS MEMBERSHIP DIRECTORY

(LS # listing Continued from page 23)

LS-5071	HOFFART, BRIAN	LS-6134	LESHOVSKY, THOMAS R.
LS-5146	SCOTT, STEVEN K.	LS-6153	SKATTUM, AARON
LS-5186	HECK, JON D.	LS-6154	ANDERSON, AARON
LS-5270	FOWLDS, JANELE	LS-6174	MCCORMICK, KEVIN
LS-5280	PORTWOOD, BRIAN	LS-6175	THOMPSON, ADAM
LS-5281	OLSON, PETER A.	LS-6206	SKINNER, DANIEL
LS-5288	JOHS, CLEARY	LS-6262	COULOMBE, GEORGE
LS-5466	HOMISTON, KC	LS-6294	HADDICK, WILLIAM
LS-5476	LANGLIE, STEVEN M.	LS-6357	HANSON, MARK
LS-5501	COOPER, JAMES A.	LS-6373	CARLSON, ARLEE
LS-5572	HANSON, CHAD	LS-6408	RICH, GREGORY
LS-5582	ERICKSON, DAIN	LS-6498	LANDECKER, DAVID
LS-5589	NORBY, AARON	LS-6550	DOLINAR, WILLIAM
LS-5651	WOOD, JEREMY	LS-6551	RUTZEN, STEPHEN G.
LS-5770	LANGERUD, TIM	LS-6571	HOLM, STEVEN
LS-5771	GLASSER, JAMIE	LS-6582	ROCK, EDWARD
LS-5773	JORDHEIM, CHRISTOPHER D.	LS-6609	GRAVES, DEANE
LS-5774	THORESON, KENT G.	LS-6610	REBSCH, CHARLES
LS-5868	JELINEK, JEFF	LS-6611	FORBES, BRIAN
LS-5869	WITTSTOCK, JEROME C.	LS-6612	RUGLAND, GREG
LS-5900	THOMASSON, SHAWN	LS-6703	STROEING, GREGG
LS-5988	BOERS, DANIEL	LS-6704	VAN DYKE, ROBERT
LS-5999	OBRIGEWITSCH, QUENTIN	LS-6718	KOHLER, ROBERT JOSEPH
LS-6045	BOROWICZ, GARRETT	LS-6720	HAMPTON, MARCUS
LS-6050	POWERS, JAMES	LS-6808	MCCOY, TRACE
LS-6064	BALLUFF, THOMAS	LS-6809	SCHMALZ, BRIAN
LS-6086	SCHLIEMAN, JIM	LS-6825	PEZOLDT, DOUGLAS
LS-6122	GUSTAFSON, JASON		

(Continued on page 25)

2014 NDSPLS MEMBERSHIP DIRECTORY

(LS # listing Continued from page 24)

LS-6846	PUGH, BILL	LS-8088	SWENSON, MEGAN
LS-6884	NESS, JASON	LS-8134	MAIN, JASON
LS-6885	SLETVOLD, DUSTY	LS-8158	EDWARDS, HUGH
LS-6918	WURGLER, JEREMY	LS-8218	STATTELMAN, NICK
LS-6948	Breuer, Chad R.	LS-8220	SMALL, MICHAEL
LS-6985	BUZZERD, GREGORY	LS-8231	BERGHERR, SCOTT
LS-7000	WARNER, DENNIS	LS-8250	RAY, MICHAEL
LS-7062	MARTIN, KEVIN	LS-8422	TAYLOR, SHELTON
LS-7176	APPLETON, ROBERT	LS-8423	SOLEM, DAYNE
LS-7191	BERG, CASEY	LS-8424	CLARKE, SHAWN
LS-7193	WAGNER, DANIEL	LS-8426	SNIDER, DURHAM
LS-7390	ZISKA, JAKE	LS-8427	SAUBER, JOHN
LS-7447	LAPKA, MIKE	LS-8441	LIEBOLD, FELIX
LS-7512	HUMMERT, AARON	LS-8444	ILLG, ROBERT
LS-7538	HEATH, BRIAN R.	LS-8587	PRIBULA, NICHOLAS
LS-7540	ESTES, JAMES	LS-8608	ROBINSON, CHRIS
LS-7590	LINK, RYAN	LS-8622	HART, JAMES
LS-7611	COMER, BLAINE	LS-8732	LEAS, JARRETT
LS-7641	CONTI, ANTONIO	LS-8817	HESELBACH, WILLIAM
LS-7664	RINTAMAKI, EDWARD	LS-8831	ATTERTON, CHAD
LS-7668	SULLIVAN, LARRY	LS-8833	GLINES, KURT
LS-7726	BEEBE, PATRICK	LS-9044	GETCHELL, GUNNAR
LS-7810	JACOBSON, MATTHEW	LS-9442	FARRIER, WILLIAM
LS-7836	WITTER, DARRYL		
LS-7969	SWENSON, THOMAS		
LS-7974	NASH, DAVID		
LS-7986	ERBELE, BOYD		
LS-8064	ANDERSON, NATHAN		

2014 NDSPLS MEMBERSHIP DIRECTORY

2014 Membership Listing

ACKERMAN, ROLLY

1907 17TH ST SE
MINOT ND 58701
ACKERMAN SURVEYING AND ASSOC
ID: LS-2391
W: 701/838-0786
H: 701/838-3863
C:
Fax: 701/837-1990
Email: ackerman@minot.com

ACKERMAN, STEVEN

107 2ND ST S
WAHPETON ND 58075
ACKERMAN LAND SURVEYING, INC.
ID: LS-2958
W: 701/642-9404
H: 701/642-5446
C: 701/899-4273
Fax: 701/642-4810
Email: steve@ackermansurvey.com

ALBER, JAMES

8312 WHITE OAK LOOP
BISMARCK ND 58501
MFRA, INC.
ID: LS-4730
W: 7013904293
H: 701/866-0286
C: 7018660286
Fax:
Email: jalber@mfra.com

ALEXANDER, KORY

1907 17TH ST SE
MINOT ND 58701
ACKERMAN SURVEYING & ASSOCI-
ATES
ID: ASC
W: 7018380786
H:
C:
Fax:
Email: koryalexander@hotmail.com

ALLERDINGS, MERLIN

2118 CAUF DR
MINOT ND 58701
KADRMAS, LEE & JACKSON
ID: ASC
W: 7018393383
H: 7017202001
C:
Fax:
Email: merlin.allerdings@kljeng.com

ANDERSON, AARON

7950 HWY 2 EAST, LOT 111
MINOT ND 58701
ACKERMAN SURVEYING
ID: LS-6154
W: 7018380786
H:
C:
Fax:
Email: aaron.anderson@ackermansurveying.com

ANDERSON, NATHAN

700 MAIN AVENUE
FARGO ND 58103
LIGHTOWLER JOHNSON ASSOCIATES
ID: LS-8064
W: 7012931350
H: 7012387445
C: 7012387445
Fax:
Email: nanderson@lja-1.com

APPLETON, ROBERT

10555 W JEWELL AVE, APT 2-202
LAKEWOOD CO 80232
US FISH & WILDLIFE SERVICE
ID: LS-7176
W: 3032368690
H:
C: 7204134037
Fax:
Email: appletonrj@q.com

ATTERTON, CHAD

PO BOX 538
SURREY ND 58785
ACKERMAN SURVEYING
ID: LS-8831
W: 7018529210
H:
C:
Fax:
Email: catterton@srt.com

AUGHTMAN, MARK

99 23RD STREET SUITE B
DICKINSON ND 58601
USDA FOREST SERVICE
ID: LS-3801
W: 701/227-7835
H:
C: 701/290-3542
Fax: 701/227-7701
Email: maughtman@fs.fed.us

BACKOWSKI, JACOB

1024 THIESSE DR
BRAINERD MN 56401
KLJ
ID: ASC
W: 2188286330
H:
C:
Fax:
Email: jake.backowski@kljeng.com

BACON, RANDY D.

PO BOX 111
ABERDEEN SD 58402-0111
HELMS AND ASSOC
ID: LS-3213
W: 605/225-1212
H:
C:
Fax: 605/225-3189
Email: randyb@helmsengineering.com

BAFFERT, JOHN G.

PO BOX 27367
TUCSON AZ 85726-7367
SURV-KAP, LLC
ID: SUS
W: 800/445-5320
H:
C:
Fax: 520/792-2030
Email: johnbaffert@mindspring.com

BALLUFF, THOMAS

18612 XENOLITH STREET NW
ANOKA MN 55303
CARLSON McCAIN, INC.
ID: LS-6064
W: 7634897916
H: 7637532575
C: 7634434644
Fax: 763/4897959
Email: balluff_a@msn.com

BANSE, THOMAS

3020 MANCHESTER ST
BISMARCK ND 58504
ND STATE WATER COMMISSION
ID: ASC
W: 7013285049
H: 7015509019
C:
Fax:
Email: tkbanse@gmail.com

2014 NDSPLS MEMBERSHIP DIRECTORY

BARGMANN, HERBERT W.

1217 RIDGEVIEW LANE
BISMARCK ND 58501
WOLD ENGINEERING
ID: LS-1353
W: 701/258-9227
H: 701/255-2515
C: 701/220-5962
Fax: 701/258-9228
Email: herb@btinet.net

BARTHOLOMEW, BRANDEN

1562 KINGSVIEW DRIVE
GRAND FORKS ND 58201
CITY OF GRAND FORKS
ID: LS-3085
W: 701/746-2647
H: 701/772-5494
C: 218/791-6964
Fax: 701/787-3744
Email: bbartholomew@grandforksgov.com

BAUER, CORY

1717 E INTERSTATE AVE
BISMARCK ND 58501-0564
BASIN ELECTRIC POWER
ID: LSIT-9303 (SD)
W: 7015575724
H:
C:
Fax: 701/557-4322
Email: cbauer@bepc.com

BECK, HOLLY

7001 52ND ST NE
BISMARCK ND 58501
HOLLY BECK SURVEYING AND ENGINEERING, LLC
ID: LS-4934
W: 701/223-3546
H: 701/258-0370
C: 701/400-8768
Fax: 701/224-1337
Email: hollybeck@hollybecksurveying.com

BEEBE, PATRICK

4622 HWY 1804, PO BOX 29
TRENTON ND 58853
SBL ASSOCIATES
ID: LS-7726
W: 7015777251
H:
C: 7015803177
Fax:
Email: pbeebe@sbl.us.com

BEGGS, BRYAN

3001 11TH ST SE
MINOT ND 58701
RETIRED
ID: LS-1556 - LIFE
W:
H: 7018383269
C:
Fax:
Email: bbeggs@wil.midco.net

BERARD, ROBBY L.

PO BOX 104
BURLINGTON ND 58722
ACKERMAN SURVEYING AND ASSOC
ID: LS-4727
W: 701/838-0786
H: 701/839-8526
C:
Fax: 701/837-1990
Email: rberard@srt.com

BERG, CASEY

4050 GARDEN VIEW DRIVE #200
GRAND FORKS ND 58201
ADVANCED ENGINEERING
ID: LS-7191
W: 701/746-8087
H: 701/739-4130
C: 701/740-5847
Fax: 701/746-0370
Email: casey.berg@ae2s.com

BERGHERR, SCOTT

3701 12TH ST N #206
ST. CLOUD MN 56303
WESTWOOD PROFESSIONAL SERVICES, INC.
ID: LS-8231
W: 3202539495
H: 3202596327
C: 6122213720
Fax:
Email: scott.bergherr@westwoodps.com

BERNTSEN INTERNATIONAL INC.,

PO BOX 8670
MADISON WI 53708-8670
BERNTSEN INTERNATIONAL INC.
ID: SUS
W: 608/249-8549
H:
C:
Fax: 608/249-9794
Email: surveymark@berntsen.com

Billman, Brian

3456 E. Century Avenue
Bismarck ND 58501
Bartlett & West
ID: LSI
W:
H: 7013556411
C:
Fax:
Email: bbillman69@gmail.com

BINSTOCK, DANIEL

3240 E THAYER AVE #2
BISMARCK ND 58501
KLJ
ID: ASC
W:
H:
C: 7019894746
Fax:
Email: daniel.binstock@kljeng.com

BLAUERT, RICHARD

3712 LOCKPORT ST
BISMARCK ND 58503
HOUSTON ENGINEERING, INC.
ID: ASC
W: 7013230200
H:
C:
Fax: 701-323-0300
Email: rblauert@houstoneng.com

BLOOMENRADER, SCOTT D.

330 RICE LANE
BILLINGS MT 59105
ID: LS-3290
W:
H: 406/252-2917
C: 4066948650
Fax:
Email: sblmmt@optimum.net

BOECHLER, DEREK

PO BOX 517
SURREY ND 58785
ACKERMAN SURVEYING
ID: ASC
W:
H: 7013405194
C: 7017202488
Fax:
Email: boechler3@hotmail.com

2014 NDSPLS MEMBERSHIP DIRECTORY

BOECHLER, CHRIS

811 64TH AVE NE #24
MINOT ND 58703
ACKERMAN SURVEYING & ASSOC.
ID: ASC
W:
H: 7017207159
C:
Fax:
Email: chrisboechler@gmail.com

BOEHNING, DUANE

3026 24TH AVE S
FARGO ND 58108
RETIRED
ID: LS-1186 - LIFE
W:
H: 701/237-6522
C:
Fax:
Email:

BOERS, DANIEL

2606 GOLDENROD LANE
BOZEMAN MT 59718
MORRISON-MAIERLE, INC
ID: LS-5988
W: 4069226761
H:
C:
Fax:
Email: dboers@m-m.net

BORGEN, JEROME

10223 461 AVE
NEW EFFINGTON SD 57255-6103
RETIRED
ID: LS-1406 - LIFE
W:
H: 605/637-5531
C:
Fax:
Email: zborgens@tnics.com

BOROWICZ, GARRETT

1502 EVERGREEN DRIVE
CROOKSTRON MN 56716
WIDSETH SMITH NOLTING
ID: LS-6045
W:
H:
C: 2185210936
Fax: 218/281-6545
Email: garrett.borowicz@wsn.us.com

BRECHT, MARY

204 COUNTY ROAD 15
BEULAH ND 58523
THE COTEAU PROPERTIES CO
ID: LS-3921
W: 701/873-7265
H: 701/873-7662
C:
Fax: 701/873-7226
Email: mary.brecht@nacoal.com

BREKKE, CHRIS

215 16TH ST SE
MINOT ND 58701
ACKERMAN SURVEYING
ID: PLS
W: 7015001103
H:
C:
Fax:
Email: chris.brekke@ackermansurveying.com

Breuer, Chad R.

1048 14th St. SW
Sidney MT 59270
Erickson Contract Surveying
ID: LS-6948
W:
H: 4064826606
C: 4065319362
Fax:
Email: chad.breuer@ecs-gps.com

BROSZ, DANNY

PO BOX 357
BOWMAN ND 58623
BROSZ ENGINEERING
ID: LS-2679
W: 701/523-3340
H: 701/523-3367
C:
Fax: 701/523-5243
Email: danb@brozengineering.com

BRUCKNER, JOHN

PO BOX 266
BELFIELD ND 58622
INTERSTATE ENGINEERING
ID: ASC
W: 7015752247
H:
C: 4063900293
Fax:
Email:

BUSTA, BRIAN

1201 MAIN AVENUE WEST
WEST FARGO ND 58078-1301
CASS COUNTY HIGHWAY DEPT
ID: ASC
W: 701/298-2378
H: 218/498-0103
C: 701/799-7714
Fax: 701/298-2395
Email: bustab@casscountynnd.gov

BUZZERD, GREGORY

915 E 11TH ST, PO BOX 237
BOTTINEAU ND 58318
Wold Engineering
ID: LS-6985
W: 7012282292
H: 9106197892
C:
Fax:
Email: gbuzzerd@woldengr.com

CARLSON, ARLEE

9001 E BLOOMINGTON FRWY, #11B
BLOOMINGTON MN 55420
SUNDE LAND SURVEYING, LLC
ID: LS-6373
W: 9528812455
H: 7634278139
C: 6123285312
Fax: 952/888-9526
Email: arlee@sunde.com

CASKEY, GARY G.

615 5TH ST SE
E GRAND FORKS MN 56721
KLJ
ID: LS-5014
W: 7017751109
H:
C: 7012138891
Fax:
Email: gary.caskey@kljeng.com

CLARKE, SHAWN

2150 VINEYARD DR
CASTLE ROCK CO 80104
LW SURVEY COMPANY
ID: LS-8424
W:
H: 3038090890
C:
Fax:
Email: S.CLARKE@LWSURVEY.COM

2014 NDSPLS MEMBERSHIP DIRECTORY

CLASEMANN, MICHAEL

308 2ND AVE N
GRAND FORKS ND 58203
CPS, LTD.
ID: LSI
W:
H:
C: 3203606503
Fax:
Email: mclasemann@cpsnd.com

COMBS, JOHN

PO BOX 780 Hilltop Home of Comfort
KILLDEER ND 58640-0455
ID: LS-1238 - LIFE
W:
H: 701/764-5805
C:
Fax:
Email:

COMER, BLAINE

3160 W CLUBHOUSE DR
LEHI UT 84043
CIVIL SCIENCE
ID: LS-7611
W: 8017687200
H: 8013674250
C:
Fax: 801-768-7201
Email: bcomer@civilscience.com

CONTI, ANTONIO

1115 16TH ST SW #2
MINOT ND 58701
AE2S
ID: LS-7641
W: 7018524048
H:
C:
Fax:
Email: antonio.conti@ae2s.com

COOPER, JAMES A.

PO BOX 937
VALLEY CITY ND 58072
KLJ
ID: LS-5501
W: 701/845-4980
H: 701/490-0921
C: 7014904987
Fax:
Email: james.cooper@kljeng.com

COULOMBE, GEORGE

3701 ELLIOT ROAD NE
BEMIDJI MN 56601
NORTHERN ENGINEERING & CON-
SULTING
ID: LS-6262
W: 2184444860
H: 2184449791
C: 2187668831
Fax:
Email: gcoulomb@paulbunyan.net

DALE, DUSTIN

3101 FRONTAGE RD S
MOORHEAD MN 56560
AE2S
ID: LSI
W: 218/299-5610
H: 701/219-1714
C:
Fax: 218/299-5611
Email: dustin.dale@ae2s.com

DOLINAR, WILLIAM

PO BOX 820
GREEN RIVER WY 82935
WILLIAM H. SMITH & ASSOCIATES
P.C.
ID: LS-6550
W: 3078753638
H: 3078751735
C: 3073893361
Fax: 307-875-3640
Email: will@whsmithpc.com

ECKROTH, THOMAS

3456 E. CENTURY
BISMARCK ND 58501
BARTLETT & WEST
ID: LS-3384
W: 7012218415
H: 701/223-5681
C: 7014260279
Fax:
Email: TOM.ECKROTH@BARTWEST.COM

EDWARDS, HUGH

1011 JAY ST #4
BOTTINEAU ND 58318
WOLD ENGINEERING
ID: LS-8158
W: 7012282292
H: 7018710402
C: 7018710402
Fax:
Email: h_edwards@woldengr.com

ELDEVIK, RODNEY F.

1211 MAPLE DR SE
ALEXANDRIA MN 56308
ELDEVIK LAND SURVEYING INC
ID: LS-3409
W: 320/763-7566
H: 320/763-7566
C:
Fax: 320/763-7504
Email: eldevik@rea-alp.com

ERBELE, BOYD

4733 Amber Valley Parkway S
FARGO ND 58104
Apex Engineering Group
ID: LS-7986
W: 7013737978
H: 7017930086
C: 7017930086
Fax:
Email: boyd.erbele@apexenggroup.com

ERICKSON, ALAN

102 DIVISION ST NW
MANDAN ND 58554
ID: LS-1202
W:
H: 701/222-1162
C: 7012025776
Fax:
Email: awerickson@bis.midco.net

ERICKSON, DAIN

4733 AMBER VALLEY PARKWAY S
FARGO ND 58104
APEX ENGINEERS, INC.
ID: LS-5582
W: 7013737973
H: 701/492-2768
C: 701/793-4382
Fax: 701/237-3191
Email: dain.erickson@apexenggroup.com

ESTES, JAMES

634 E BROADWAY #1120
WILLISTON ND 58801
BASIN LAND SURVEY LLC
ID: LS-7540
W: 7015800508
H:
C: 7016418747
Fax:
Email: jim@basinlandsurvey.com

2014 NDSPLS MEMBERSHIP DIRECTORY

ESTVOLD, ALAN

1907 17TH ST SE
MINOT ND 58701
ACKERMAN-ESTVOLD ENGINEERING
ID: LS-1961
W: 701/837-8737
H: 701/838-3827
C: 701/720-4034
Fax: 701/837-1990
Email:
alan.estvold@ackerman-estvold.com

FARRIER, WILLIAM

41 E BROADWAY
DICKINSON, ND 58601
DOWL HKM
ID: NEW PLS
W: 701/300-7018
H: 503/704-9614
C: 701/260-3822
Fax:
Email: wfarrier1963@gmail.com

FISCHER, DANIEL V.

PO BOX 66
LANGDON ND 58249-0066
FISCHER LAND SURVEYING & ENGINEERING
ID: LS-3856
W: 701/256-5728
H: 701/256-2787
C: 701/370-0690
Fax: 701/256-3709
Email: dfischer@utma.com

FOLEY, CHRIS

1024 THIESSE DRIVE
BRAINERD MN 56401
KLJ
ID: LSI
W: 2188286330
H:
C: 2188200592
Fax:
Email: christopher.foley@kljeng.com

FORBES, BRIAN

1414 ELK STREET #202
ROCK SPRINGS WY 82901
D.R. GRIFFIN & ASSOCIATES INC.
ID: LS-6611
W: 3073625028
H: 3073829712
C: 3073894315
Fax: 307/362-1056
Email: bforbes@drgr-wy.com

FOSTER, RICHARD

2 SOLPERS BAY ROAD
BOTTINEAU ND 58318
RETIRED
ID: LS-1265 - LIFE
W:
H: 701/263-4713
C:
Fax:
Email: dkfoster@yahoo.com

FOWLDS, JANELE

1960 PREMIER DR
MANKOTA MN 56001
BOLTON & MENK, INC.
ID: LS-5270
W: 5076254171
H: 5073887218
C: 5073817514
Fax:
Email: janelefo@bolton-menk.com

FREUER, TYLER

204 COUNTY RD 15
BEULAH ND 58523
THE COTEAU PROPERTIES
ID: ASC
W:
H: 7018735432
C:
Fax:
Email: tyler.freuer@nacoal.com

FRIEDT, JASON

2586 CHARLOTTE DR N
MANDAN ND 58554
FALKIRK MINING CO
ID: ASC
W: 701/873-7234
H: 701/400-4031
C: 701/400-4031
Fax:
Email: Jason.Friedt@nacoal.com

FRIEDT, JARED

3712 LOCKPORT ST
BISMARCK ND 58503
HOUSTON ENGINEERING, INC.
ID: LSI
W:
H: 7013230200
C:
Fax:
Email: jfriedt@houstoneng.com

FRISQUE, DOUGLAS

2113 GRIMSRUD DR #205
BISMARCK ND 58501
KADRMAS, LEE & JACKSON
ID: ASC
W: 7014251804
H: 9207373210
C:
Fax:
Email: doug.frisque@kljeng.com

FROHLICH, JEFF P.

622 N MANDAN ST
BISMARCK ND 58501
DAKOTA WESTMORELAND CORP
ID: LS-3139
W: 701/873-4333
H: 701/222-8969
C: 7018708070
Fax:
Email: chefrolake@bis.midco.net

FRONTIER PRECISION,

2020 FRONTIER DR
BISMARCK ND 58504
FRONTIER PRECISION
ID: SUS
W: 701/222-2030
H:
C:
Fax: 701/258-5324
Email: nathank@frontierprecision.com

GARZA, HOLLY

3456 E CENTURY AVE
BISMARCK ND 58501
BARTLETT & WEST
ID: LSI
W: 7012218466
H:
C: 7018990637
Fax:
Email: holly.garza@bartwest.com

GETCHELL, GUNNAR

1 ENGINEERING PLACE
HELENA MT 59602
MORRISON-MAIERLE, INC.
ID: PLS-9044
W: 4066705855
H:
C: 4066705855
Fax:
Email: ggetchell@m-m.net

2014 NDSPLS MEMBERSHIP DIRECTORY

GLASOE, CURTIS W.

1636 32ND ST E
DICKINSON ND 58601
USDA FOREST SERVICE
ID: LS-2439
W: 7019897307
H: 701/225-5796
C: 701/260-9459
Fax: 701/250-4454
Email: cglasoe@fs.fed.us

GLASSER, JAMIE

253 24TH ST E
DICKINSON ND 58601
HIGHLANDS ENGINEERING & SUR-
VEYING
ID: LS-5771
W: 701/483-2444
H:
C:
Fax: 701/483-2610
Email: glasser@highlandseng.com

GLINES, KURT

234 3RD AVE SW
DICKINSON ND 58601
KADRMAS LEE & JACKSON
ID: LS-8833
W: 7014831284
H: 7012909234
C: 7015901752
Fax: 701/483-2795
Email: kurt.glines@kljeng.com

GOLDSACK, NATHAN

909 BASIC AVENUE
BISMARCK ND 58504
SWENSON HAGEN & CO
ID: ASC
W: 701/223-2600
H:
C:
Fax: 701/223-2606
Email: ngoldsack@swensonhagen.com

GOSBEE, LOU ANN

405 COLLINS AVE
MANDAN ND 58554
ND DEPT OF TRANSPORTATION
ID: LS-4973
W: 701/328-4438
H:
C: 701/226-2354
Fax:
Email: lgosbee@nd.gov

GRAVES, DEANE

1405 31ST AVE SE
MINOT ND 58701
ADVANCED SURVEYING LLC
ID: LS-6609
W: 7015096371
H: 2488603776
C: 2488603776
Fax:
Email: deanegraves@gmail.com

GREER, GARY

PO BOX 1007
VERSAILLES KY 40383
ENERGY MANAGEMENT & SERVICES
ID: LS-4129
W: 7134567880
H: 713/868-2755
C: 2817871553
Fax:
Email: ggreer@emseng.com

GRIMSLEY, ROGER

4050 GARDEN VIEW DR #200
GRAND FORKS ND 58201
ADVANCED ENGINEERING
ID: LS-3237
W: 701/746-8087
H: 701/775-5125
C: 701/739-2483
Fax: 701/746-0370
Email: Roger.Grimmsley@ae2s.com

GUSTAFSON, JASON

583 172ND ST
HAMMOND WI 54015
UNIVERSAL PEGASUS
ID: PLS-6122
W:
H:
C: 7153775653
Fax:
Email: gusser2000@hotmail.com

HADDICK, WILLIAM

1865 2nd AVENUE EAST
DICKINSON ND 58601
KADRMAS LEE AND JACKSON INC
ID: LS-6294
W: 7014563139
H: 6128044925
C: 701/840-8567
Fax: 701/845-0252
Email: bill.haddick@kljeng.com

HAGEN, ROGER

1012 44TH AVE N
FARGO ND 58102
HOUSTON ENGINEERING, INC.
ID: LS-1766
W: 701/237-5065
H: 701/235-0083
C:
Fax: 701/237-5101
Email: rhagen@houstoneng.com

HALE, NORMAN

1444 CEDAR ST
STURGIS SD 57785
ID: ASC
W: 605/347-5741
H: 605/347-7610
C: 605/347-1654
Fax: 605/347-5741
Email: normhale@rushmore.com

Hall, Susan

10355 WESTMOOR DRIVE
WESTMINSTER CO 80021
TRIMBLE
ID: SUS
W: 3036358419
H:
C: 4082054448
Fax: 720/887-6101
Email: susan_hall@trimble.com

HAMPTON, MARCUS

14800 28TH AVE N #140
PLYMOUTH MN 55447
MFRA, INC.
ID: LS-6720
W: 7632596661
H:
C:
Fax:
Email: mhampton@mfra.com

HANSON, MARK

9001 E BLOOMINGTON FRWY #118
BLOOMINGTON MN 55420
SUNDE LAND SURVEYING LLC
ID: LS-6357
W: 9528863105
H: 9528863105
C:
Fax:
Email: mark@sunde.com

2014 NDSPLS MEMBERSHIP DIRECTORY

HANSON, CHAD

1531 S RENO DRIVE
BISMARCK ND 58501
ND DOT
ID: LS-5572
W: 7013282564
H:
C: 7014002457
Fax:
Email: cahanson@nd.gov

HART, JAMES

9446 MORCADO CIR
LA MESA CA 91941
WHPACIFIC, INC.
ID: LS-8622
W: 6197977443
H: 6197417724
C: 6197977443
Fax: 858-715-1959
Email: mhart@whpacific.com

HEATH, BRIAN R.

PO BOX 937
VALLEY CITY ND 58072
KLJ
ID: LS-7538
W: 701/845-4980
H:
C:
Fax:
Email: brian.heath@kljeng.com

HECK, JON D.

524 N SYCAMORE AVE SUITE 1
SIOUX FALLS SD 57110
GOLDSMITH HECK ENGINEERS, INC.
ID: LS-5186
W: 605/332-9685
H:
C:
Fax: 605/332-9687
Email: jheck.goldeng@midconetwork.com

HEGLUND, DALE

8100 SIBLEY DR
BISMARCK ND 58504
NDLTAP/UGPTI
ID: LS-3340
W: 7013289857
H:
C: 701-/220-5192
Fax: 701/328-9866
Email: dale.heglund@ndsu.edu

HERZOG, DOUG

1529 CHESTNUT PLACE
GRAND FORKS ND 58201
ID: LS-2355 - Life
W:
H:
C: 701/739-0054
Fax:
Email: daherzog@gra.midco.net

HESELBACH, WILLIAM

1345 W HINSDALE DR
LITTLETON CO 80120
CVL OF COLORADO
ID: LS-8817
W: 7202493542
H: 3037985777
C:
Fax:
Email: lbhesse@msn.com

HILLIUS, JOE

PO BOX 5503
BISMARCK ND 585065503
CITY OF BISMARCK
ID: ASC
W: 7013551505
H: 7018700452
C: 7018700452
Fax: 701/222-6593
Email: jhillius@nd.gov

HOFFART, BRIAN

3565 NORKOTA COURT
GRAND FORKS ND 58201
MINNKOTA POWER
ID: LS-5071
W:
H: 701/746-4215
C:
Fax:
Email: bhoffart@gra.midco.net

HOLM, STEVEN

29926 70TH AVE S
HAWLEY MN 56549
MOORE ENGINEERING, INC.
ID: LS-6571
W: 7012824692
H: 218/532-2559
C: 218/850-0148
Fax:
Email: sholm@mooreengineeringinc.com

HOMISTON, KC

253 24TH ST E
DICKINSON ND 58601
HIGHLANDS ENGINEERING
ID: LS-5466
W: 7014832444
H:
C:
Fax: 7014832610
Email: homiston@highlandseng.com

HORNADAY, RICK L.

704 CONEFLOWER DR
MINOT ND 58701
SELF-EMPLOYED
ID: LS-3541
W: 701/627-3844
H: 701/627-3844
C:
Fax:
Email: hornaday@srt.com

HORST, RONALD

3020 COLUMBIA AVE
LANCASTER PA 17603
RETTEW ASSOC. INC.
ID: PLS
W:
H:
C:
Fax:
Email: rhorst@rettew.com

HOVENDICK, DAVID

507 3RD STREET NE
DEVILS LAKE ND 58301
LSS, INC.
ID: LS-3612
W: 701/662-8065
H: 701/398-3255
C: 701/230-2614
Fax: 701/665-2637
Email: lss@gondtc.com

HOWE, KEITH L.

43391 126th Street
ROSLYN SD 57261
HOWE SURVEYING LLC
ID: LS-4653
W: 605/486-4801
H: 605/486-4801
C: 605/350-0091
Fax: 605/486-4801
Email: howek@lakeareatech.edu

2014 NDSPLS MEMBERSHIP DIRECTORY

HUMMERT, AARON

1309 16TH STREET SE
MANDAN ND 58554
HUMMERT LAND SURVEYING
ID: LS-7512
W:
H:
C: 7014268624
Fax:
Email: hummertsurveying@gmail.com

HUNSINGER, TREVOR

128 SOO LINE DR
BISMARCK ND 58501
KLJ
ID: ASC
W: 7013558400
H: 7012029443
C: 7012200109
Fax:
Email: trevor.hunsinger@kljeng.com

HUOTARI, RUSS

920 12TH ST SW
SIDNEY MT 59270
RICHLAND COUNTY - MONTANA
ID: ASC
W: 406/433-2407
H: 4064821786
C: 406/480-2407
Fax: 406/433-7118
Email: surveyoruss@gmail.com

HURST, LEE

615 5TH ST SE
SIDNEY MT 59270
BIG SKY SURVEYING
ID: LS
W: 4064889452
H:
C: 4064805263
Fax:
Email: leehurst.surveyor@gmail.com

IDE, JOSHUA

2600 14TH AVE SW
MINOT ND 58701
NDDOT
ID: LSI-13097
W: 7018331544
H:
C:
Fax:
Email: joshua.ide@gmail.com

ILLG, ROBERT

925 BASIN AVE #101
BISMARCK ND 58504
SEH
ID: LS-8444
W: 7018391590
H: 2187706647
C:
Fax:
Email: rillg@sehinc.com

INDVIK, DONALD

606 W PINE CIRCLE
BOTTINEAU ND 58318
ID: LS-1263 - LIFE
W: 701/228-2292
H: 701/228-2976
C: 701/228-4361
Fax: 701/228-3938
Email: dindvik@utma.com

INGERSOLL, CHRIS

1505 30TH AVE S
MOORHEAD MN 56560
KLJ
ID: LS-8887
W: 2182870300
H:
C: 7013671684
Fax:
Email: chris.ingersoll@kljeng.com

IRWIN, LELAND

PO BOX 233
NEW SALEM ND 58563
COTEAU PROPERTIES
ID: LSIT-11872
W: 701/873-7236
H: 701/843-8460
C:
Fax:
Email: leland.irwin@nacoal.com

ISAACS, MARK

501 1ST ST NW
MANDAN ND 58554
TOMAN ENGINEERING
ID: ASC
W: 7016636483
H: 7015952079
C:
Fax:
Email: mark@tomanengineering.com

JACKSON, EUGENE

1067 5TH AVE W
DICKINSON ND 58601
ID: LS-1891 - LIFE
W:
H: 701/483-1340
C: 7012907155
Fax: 701/483-2795
Email: genejackson@ndsupernet.com

JACOBSON, MATTHEW

1817 SOUTH AVENUE WEST, SUITE
A
MISSOULA MT 59801
TERRITORIAL LANDWORKS, INC.
ID: LS-7810
W:
H:
C:
Fax:
Email: mattj@territoriallandworks.com

JANKE, DELBERT

PO BOX 290
DICKINSON ND 58601
KADRMAS, LEE & JACKSON
ID: ASC
W:
H:
C: 7015902860
Fax:
Email: del.janke@kljeng.com

JEFFRIES, JERRY L.

RR 4 BOX 520
CHECOTAH OK 74426
GOLDEN FIELD SERVICES INC
ID: LS-1247
W: 918/610-0014
H: 918/473-6723
C: 918/638-3317
Fax: 918/610-0016
Email:
jjjeffries@goldenfieldservices.com

JELINEK, JEFF

800 6TH ST N
WAHPETON ND 58076
NDSCS
ID: LS-5868
W: 701/671-2268
H: 701/642-8222
C: 701/640-1891
Fax: 701/671-2146
Email: jeff.jelinek@ndscs.edu

2014 NDSPLS MEMBERSHIP DIRECTORY

JENSEN, CLEONE

3837 N VALLEY LOOP, BOX 2
BISMARCK ND 58503
ID: LS-1229 - LIFE
W:
H: 7017510618
C:
Fax:
Email: jensenf@bis.midco.net

JENSEN, NICHOLAS

PO BOX 290
DICKINSON ND 58602
KADRMAS, LEE & JACKSON
ID: ASC
W:
H:
C: 3084303118
Fax:
Email: nick.jensen@kljeng.com

JENSEN, TROY

PO BOX 1182
SIDNEY MT 59270
UINTAH ENGINEERING & LAND SUR-
VEYING
ID: LS-4654
W: 406/433-9650
H: 406/488-7330
C: 406/480-0906
Fax: 406/433-9653
Email: tjensen@uintahgroup.com

JESKE, JOSHUA

6201 DAKOTA COUNTRY DR
BISMARCK ND 58503
KLJ
ID: ASC
W:
H:
C:
Fax:
Email: josh.jeske@kljeng.com

JOHNSON, GREGORY

6404 DEERWOOD LANE
BISMARCK ND 58503
ID: LS-2356
W:
H: 701/255-6953
C: 7012202494
Fax:
Email: duckschief@bis.midco.net

JOHNSON, KRIS

128 SOO LINE DRIVE
BISMARCK ND 58501
KADRMAS LEE & JACKSON
ID: LSI
W: 7013558400
H:
C: 7015279177
Fax: 701/355-8481
Email: kris.johnson@kljeng.com

JOHNSON, JARED A.

PO BOX 5005
MINOT ND 58701
WARD COUNTY HWY DEPT
ID: ASC
W: 701/838-2810
H:
C:
Fax: 701/838-3801
Email: jaredjohnson@srt.com

JOHNSON, NEAL

3456 E CENTURY AVE
BISMARCK ND 58503
BARTLETT & WEST
ID: ASC
W: 7012581110
H: 7012234554
C:
Fax: 701/258-1111
Email: neal.johnson@bartwest.com

JOHS, CLEARY

3209 NEVADA ST
BISMARCK ND 58503
CITY OF BISMARCK ENGINEERING
ID: LS-5288
W: 701/355-1516
H: 701/224-1589
C: 701/202-1200
Fax: 701/222-6593
Email: cjohs@nd.gov

JORDAN, MICHAEL

10081 VENTURA LANE
SUMMERSET SD 57718
BROSZ ENGINEERING
ID: LS-3542
W: 6053472722
H: 6052060344
C:
Fax:
Email: mikej@brozengineering.com

JORDHEIM, CHRISTOPHER D.

1406 ELM COULEE DRIVE NE
THOMPSON ND 58278
WIDSETH SMITH NOLTING AND
ASSOC
ID: LS-5773
W: 701/795-1975
H: 701/599-2321
C: 218/779-8696
Fax: 701/795-1978
Email: chris.jordheim@wsn.us.com

JORGENSEN, ROB

3456 E CENTURY AVE
BISMARCK ND 58503
BARTLETT & WEST
ID: ASC
W: 7012218403
H:
C:
Fax:
Email: rob.jorgenson@bartwest.com

JORGENSEN, KIRK J.

PO BOX 290
DICKINSON ND 586020290
KADRMAS LEE AND JACKSON
ID: LS-3592
W: 701/483-1284
H: 701/225-1644
C: 701/260-3638
Fax: 701/483-2795
Email: kirk.jorgenson@kljeng.com

JUNG, JAMES

355 2ND ST NW #307
VALLEY CITY ND 58072
KADRMAS LEE AND JACKSON
ID: LS-2357
W: 701/845-4980
H: 701/845-0961
C: 701/490-5552
Fax: 701/845-0252
Email: james.jung@kljeng.com

KAINZ, ROBERT

1010 4TH AVE SW, PO BOX 937
VALLEY CITY ND 58072
KLJ
ID: ASC
W: 7018454980
H: 7017899473
Fax: 701/845-0252
Email: robert.kainz@kljeng.com

2014 NDSPLS MEMBERSHIP DIRECTORY

KASEMAN, DARYL

517 26TH AVE NW
SIDNEY MT 59270
INTERSTATE ENGINEERING
ID: LS-3880
W: 4064335617
H: 7014257419
C:
Fax:
Email: dkaseman@hotmail.com

KASTELLE, RUSSELL E.

518 MINNESOTA AVE
BRECKENRIDGE MN 56520
KASTELLE LAND SURVEYING
ID: LS-1170
W: 218/643-1429
H: 218/643-3284
C:
Fax: 218/643-1429
Email: rek@wah.midco.net

KAUTZ, LEROY

248 19TH AVE NE
JAMESTOWN ND 58402
INTERSTATE ENGINEERING
ID: LS-1177
W: 701/252-0234
H: 701/952-1177
C: 701/320-4289
Fax: 701-252-0203
Email: ledodkautz@daktel.com

KISCH, KURT M.

9867 REVERE LANE
MAPLE GROVE MN 55369
CARLSON MCCAIN
ID: LS-4597
W: 7634897913
H: 763/425-2955
C: 6122504533
Fax:
Email: kkisch@carlsonmccain.com

KITZAN, RUDY

1420 WEST GARLAND AVENUE
SPOKANE WA 99205
RFK LAND SURVEYING
ID: LS-4184
W: 509/324-7861
H: 509/327-6609
C: 509/990-9071
Fax: 509/327-7249
Email: nkitzan@msn.com

KNOLL, CARMEN

1717 E INTERSTATE AVE
BISMARCK ND 58503
BASIN ELECTRIC POWER COOP
ID: ASC
W: 7015575686
H: 7014265845
C:
Fax:
Email: cknoll@bepc.com

Knudsen, Monte

3456 E. Century Avenue
Bismarck ND 58503
Bartlett & West
ID: LSI
W: 7012581110
H: 9137084098
C:
Fax:
Email: monte.knudsen@bartwest.com

KOHLER, RICHARD

2911 HARDER DR
GILLETTE WY 82718
RETIRED
ID: LS-2758 - LIFE
W: 307/686-6750
H: 307/686-9168
C:
Fax: 307/686-6755
Email: dkohler326@msn.com

KOHLER, ROBERT JOSEPH

1717 OAKLAND DR
BISMARCK ND 58504
MFRA, INC.
ID: LS-6718
W: 7015164434
H: 7015164434
C: 7015164434
Fax: 701/224-1163
Email: brotherbobfbt@gmail.com

Kopp, Anthony

3712 Lockport Street
Bismarck ND 58503
Houston Engineering, Inc.
ID: LSI
W: 7013230200
H:
C:
Fax:
Email: akopp@houstoneng.com

KREBS, GERALD J.

2156 4TH AVE E
DICKINSON ND 58601
WEST PLAINS ELECTRIC CO-OP
ID: ASC
W: 701/225-5111
H: 701/227-8308
C: 701/290-4167
Fax:
Email: gerry@wpec.net

KREBS, MATHIAS

1123 9TH ST E
DICKINSON ND 58602
KADRMAS, LEE, AND JACKSON
ID: LS-3214
W: 701/483-1284
H: 701/483-4931
C: 701/260-3607
Fax: 701/483-2795
Email: matt.krebs@kljeng.com

KREIN, LELAND L

4011 CONNAR DR
BISMARCK ND 58503
ID: LS-3148 Life
W:
H:
C:
Fax:
Email: lkrein@state.nd.us

KUMMER, DOUGLAS W.

3587 166 1/4 AVE SE
MAPLETON ND 58059
ROERS DEVELOPMENT, INC.
ID: LS-1225
W: 7012826413
H:
C: 701/361-1826
Fax: 701/282-2121
Email: dkummer@roers.com

KURLE, WAYNE

128 SIOUX LINE DR
BISMARCK ND 58501
KLJ
ID: ASC
W: 7013558400
H:
C:
Fax:
Email: wayne.kurle@kljeng.com

2014 NDSPLS MEMBERSHIP DIRECTORY

LAAVEG, BLAINE

1201 MAIN AVENUE WEST
WEST FARGO ND 58078
CASS COUNTY HIGHWAY DEPT
ID: ASC
W: 701298/2377
H:
C:
Fax: 701/298-2395
Email: laavegb@casscountynd.gov

LAMBRECHT, TOM

1115 16th St SW #2
MINOT ND 58701
ADVANCED ENGINEERING
ID: LSIT-135630
W: 7018524048
H:
C: 701/740-5325
Fax:
Email: tom.lambrecht@ae2s.com

LAMBRECHT, MARK

4050 GARDEN VIEW DRIVE #200
GRAND FORKS ND 58201
ADVANCED ENGINEERING
ID: LS-2511
W: 701/746-8087
H: 701/775-2789
C: 2187912477
Fax: 701/746-0370
Email: mark.lambrecht@ae2s.com

LANDECKER, DAVID

PO BOX 528
MOORHEAD MN 56561
WENCK ASSOCIATES
ID: LS-6498
W: 7018932326
H: 2188204038
C: 2188204038
Fax: 701/297-9601
Email: landecker.david@gmail.com

LANG, RYAN

1717 E INTERSTATE AVE
BISMARCK ND 58503
BASIN ELECTRIC POWER COOPERATIVE
ID: ASC
W: 7015575785
H:
C:
Fax:
Email: rlang@bepc.com

LANGERUD, TIM

909 BASIN AVE
BISMARCK ND 58504
SWENSON HAGEN AND CO ENG
ID: LS-5770
W: 701/223-2600
H:
C:
Fax: 701/223-2606
Email: tlangrud@swensonhagen.com

LANGLIE, STEVEN M.

3712 LOCKPORT STREET
BISMARCK ND 58503
HOUSTON ENGINEERING, INC.
ID: LS-5476
W: 7013230200
H:
C: 7013904919
Fax: 701/364-1834
Email: slanglie@houstoneng.com

LAPKA, MIKE

609 MAIN AVE S
BROOKINGS SD 57006
CIVIL DESIGN, INC.
ID: LS-7447
W: 6056963200
H: 6056279271
C: 6056903685
Fax:
Email: mlapka@civildes.com

LARSON, ERIC

2321 2ND AVE W #5
WILLISTON ND 58801
AE2S
ID: LSI
W:
H:
C:
Fax:
Email: eric.larson@ae2s.com

LEACH, RICK

PO BOX 290
DICKINSON ND 58602
KADRMAS LEE AND JACKSON
ID: LS-3496
W: 701/483-1284
H:
C: 701/260-3169
Fax: 701/483-2795
Email: rick.leach@kljeng.com

LEAS, JARRETT

1024 THIESSE DR
BRainerd MN 56401
KLJ
ID: LS-8732
W: 2188286330
H: 2189633534
C: 2184433830
Fax:
Email: jarrett.leas@kljeng.com

LEE, MANKING

3300 STONEWALL DR
BISMARCK ND 58503
BARTLETT & WEST
ID: LSI
W: 7012581111
H: 6052018740
C: 6052018740
Fax:
Email: lee57103@msn.com

LESHOVSKY, THOMAS R.

110 8TH AVE SW
MINOT ND 58701
WOLD ENGINEERING, PC
ID: LS-6134
W: 701/852-0338
H: 701/838-8305
C: 701/720-2416
Fax: 701/852-0340
Email: tomsky@srt.com

LIEBOLD, FELIX

1010 4TH AVE SW
VALLEY CITY ND 58072
KADRMAS LEE AND JACKSON
ID: LS-8441
W: 701/845-4980
H: 7013203771
C: 701/490-1340
Fax:
Email: felix.liebold@kljeng.com

LINDVIG, JOHN

1815 SCHAFER ST #301
BISMARCK ND 58501
AE2S
ID: LS-3855
W: 7012210530
H: 701/355-2254
C: 7015951284
Fax: (701) 221-0531
Email: jack.lindvig@ae2s.com

2014 NDSPLS MEMBERSHIP DIRECTORY

LINK, RYAN

308 2ND AVE N
GRAND FORKS ND 58203
CPS, LTD
ID: LS-7590
W: 701/746-7459
H:
C: 7017402430
Fax: 701/746-8948
Email: rlink@cpsnd.com

LINK, KENNETH

204 COUNTY RD 15
BEULAH ND 58523
THE COTEAU PROPERTIES CO.
ID: LS-1242
W: 701/873-7220
H: 701/748-2827
C:
Fax: 701/873-7226
Email: ken.link@nacoal.com

LOOMER, DONALD

4904 PRAIRIE LANE
WILLISTON ND 58801
ACKERMAN-ESTVOLD
ID: LS-2681
W: 7015774127
H: 701/774-3674
C: 7015702241
Fax: 701/577/1535
Email: dloomer@nemont.net

MADLER, CHARLES

218 LITTLE ST
GLEN DIVE MT 59330
CMMadler, LLC
ID: LS-2870
W: 4069410886
H: 406-377-3477
C: 4069410886
Fax:
Email: cmmadler@gmail.com

MAIN, JASON

1907 17TH ST SE
MINOT ND 58701
ACKERMAN SURVEYING & ASSOC.
ID: LS-8134
W: 7018380786
H: 8123430464
C: 7015093773
Fax:
Email: jason.main@ackermansurveying.com

MALONEY, KEVIN

PO BOX 584
TOWNER ND 58788
HOUSTON ENGINEERING, INC.
ID: ASC
W: 7018527931
H:
C: 7015002950
Fax:
Email: kmaloney@houstoneng.com

MANCHESTER, RONALD W.

501 1ST STREET NW
MANDAN ND 58554
TOMAN ENGINEERING CO
ID: LS-3252
W: 701/663-6483
H: 701/663-4000
C: 7014009396
Fax: 701/663-0923
Email: ron@tomanengineering.com

MARKUSEN, DENNIS J.

864 W 12TH STREET
GRAFTON ND 58237
KADRMAS LEE AND JACKSON
ID: LS-1194
W: 701/352-1555
H: 701/352-3774
C: 701/331-1530
Fax: 701/352-3067
Email: dennis.markusen@kljeng.com

MARQUARDT, ANDRA L.

402 7TH ST NW
MANDAN ND 58554
TOMAN ENGINEERING CO
ID: LS-4623
W: 701/663-6483
H: 701/667-2875
C:
Fax:
Email: amarq013@yahoo.com

MARSHALL, TODD

88 MCDUGALL DR
LINCOLN ND 58504
HOUSTON ENGINEERING
ID: LS-4431
W: 7013230200
H: 701/223-2345
C:
Fax:
Email: tmarschall@houstoneng.com

MARTIN, KEVIN

3456 E CENTURY AVE
BISMARCK ND 58503
BARTLETT & WEST
ID: LS-7062
W: 7012581110
H:
C: 2096029711
Fax: 701-258-1111
Email: kevin.martin@bartwest.com

MAY, GEORGE

34142 CAMP CHERITH RD
FRAZEE MN 56544
RETIRED
ID: LS-2360 - LIFE
W:
H: 218/334-4275
C:
Fax:
Email:

MCCORMICK, KEVIN

27106 BEAVER DAM DRIVE
BREEZY POINT MN 564723359
LAND DESIGN SOLUTIONS
ID: LS-6174
W: 2188200854
H: 2185624202
C: 2188200854
Fax:
Email: kevin@landdesignsolution.net

MCCOY, TRACE

708 1ST AVE NE #1
BUFFALO MN 55313
MEYER-ROHLIN LAND SERVICES
ID: LS-6808
W: 7636821781
H: 3205586091
C:
Fax:
Email: trace@meyerrohlin.com

MCELWAIN, JEFFERY

1907 17TH ST SE
MINOT ND 58701
ACKERMAN-ESTVOLD ENGINEERING
ID: ASC
W: 701/837-8737
H: 701/839-6821
C: 701/720-4038
Fax: 701/837-1990
Email: jmcclwain@srt.com

2014 NDSPLS MEMBERSHIP DIRECTORY

MEIER, DELANE

9321 WENTWORTH DR
BISMARCK ND 58503-6507
Retired
ID: PE/LS-1139
W:
H: 701/223-8579
C:
Fax:
Email: drmeier@bis.midco.net

MESSNER, JOSEPH

202 6TH AVE NE
MINOT ND 58701
KADRMAS, LEE & JACKSON
ID: LSI
W: 7018393383
H:
C: 7015785608
Fax: 701-838-3578
Email: joe.messner@kljeng.com

MORMAN, CHARLES

2388 67TH AVE S
FARGO ND 58104
Retired
ID: LS-1178 - LIFE
W:
H:
C:
Fax:
Email: csmorman@cableone.net

MUNSON, ANDREW

3120 E BROADWAY AVE
BISMARCK ND 58501
HOLLY BECK SURVEYING & ENGI-
NEERING
ID: ASC
W:
H:
C:
Fax:
Email:
amunson@hollybecksurveying.com

NAGEL, DEREK

3301 FROST LANE
BISMARCK ND 58503
KLJ
ID: ASC
W: 7013558400
H: 7015271856
C:
Fax:
Email: derek.nagel@kljeng.com

NASH, DAVID

417 HERR AVE
MARTIN ND 58758
ACKERMAN SURVEYING & ASSOC.
ID: LS-7974
W:
H: 4144161178
C:
Fax:
Email: dnash1@wi.rr.com

NASSET, DAVE

PO BOX 272
BOWMAN ND 58623
BROSZ ENGINEERING
ID: LS-4432
W: 701/523-3340
H: 701/523-3166
C:
Fax: 701/523-5243
Email: daven@broszengineering.com

NESS, JASON

1389 140TH AVE NE
HATTON ND 58240
ULTEIG ENGINEERS, INC.
ID: LS-6884
W: 7012808671
H:
C: 7012610916
Fax:
Email: jason.ness@ulteig.com

NESS, GARY

5516 15TH STREET S
FARGO ND 58104
ULTEIG ENGINEERS, INC.
ID: LS-3461
W: 701/280-8573
H: 701/232-2957
C: 701/799-8927
Fax: 701/237-3191
Email: gary.ness@ulteig.com

NIEMILLER, LANDON

909 BASIN AVENUE
BISMARCK ND 58504
SWENSON, HAGEN & CO.
ID: ASC
W: 7012232600
H:
C: 7014008198
Fax:
Email: cniemiller@swensonhagen.com

NOLAN, CHANCE

900 E BLVD AVE
BISMARCK ND 58505
ND STATE WATER COMMISSION
ID: ASC
W: 7013283093
H: 7014260321
C:
Fax:
Email: cnolan@nd.gov

NORBY, AARON

128 SOO LINE DR
BISMARCK ND 58501
KADRMAS LEE AND JACKSON
ID: LS-5589
W: 7013558400
H:
C:
Fax:
Email: aaron.norby@kljeng.com

NORD, THOMAS

3716 KOCH DR #3
BISMARCK ND 58503
HOLLY BECK SURVEYING & ENGI-
NEERING
ID: ASC
W:
H:
C:
Fax:
Email: tnord@hollybecksurveying.com

NORTON, TODD

1815 SCHAFFER STREET SUITE 301
BISMARCK ND 58501
ADVANCED ENGINEERING
ID: LS-4624
W: 701/221-0530
H: 701/843-8719
C:
Fax: 701/221-0531
Email: Todd.Norton@ae2s.com

OAKLAND, TREVOR

4874 HWY 85 #341
WILLISTON ND 58801
OAKLAND ENGINEERING
ID: LS-1179
W: 701/572-9144
H: 701/572-9144
C:
Fax: 701/572-9144
Email: oakland@nemont.net

2014 NDSPLS MEMBERSHIP DIRECTORY

OBRIGEWITCH, GREG

1814 6TH AVE NE
BEULAH ND 58523
THE FALKIRK MINING CO
ID: LS-4114
W: 701/250-2412
H: 7018705469
C: 701/870-5469
Fax:
Email: greg.obrigewitch@falkirk.com

OBRIGEWITSCH, QUENTIN

PO BOX 290
DICKINSON ND 586020290
KADRMAS LEE AND JACKSON
ID: LS-5999
W: 701/483-1284
H:
C:
Fax:
Email: quentin.obrigewitsch@kljeng.com

O'DONNELL, LOUIS P.

2301 8TH AVE NE SUITE 125
ABERDEEN SD 57401
CLARK ENGINEERING
ID: LS-4655
W: 605/225-3494
H: 605/262-3115
C: 605/228-3530
Fax: 605/225-5433
Email: lodonnell@clark-eng.com

OLSON, CARL P.

1208 42ND AVENUE N
FARGO ND 58102
KLJ
ID: LS-4687
W: 218/287-0300
H: 701/239-2518
C: 218/790-2931
Fax: 218/287-6313
Email: carl.olson@kljeng.com

OLSON, PETER A.

PO BOX 729
CULBERTSON MT 592180729
SELF-EMPLOYED
ID: LS-5281
W:
H: 406/787-5215
C: 406/480-1608
Fax:
Email: paolsonfh4@yahoo.com

OPSAHL, TROY

925 10TH AVE E
WEST FARGO ND 58078
MOORE ENGINEERING
ID: LSI-12008
W: 701/282-4692
H: 2188447516
C: 701/793-0195
Fax: 701/282-4530
Email: top-
sahl@mooreengineeringinc.com

ORVIK, GREGG

2900 10TH SW SUITE A
MINOT ND 58702-0250
KADRMAS LEE AND JACKSON
ID: LS-3881
W: 701/839-3383
H: 701/839-1436
C: 701/720-0234
Fax: 701/838-3578
Email: gregg.orvik@kljeng.com

ORVIK, KENT

128 SOO LINE DRIVE
BISMARCK ND 58501
KADRMAS LEE AND JACKSON
ID: LS-3463
W: 701/355-8400
H: 701/222-4536
C: 701/391-8876
Fax: 701/355-8781
Email: kent.orvik@kljeng.com

PAULSON, JOHN

PO BOX 781
BOWMAN ND 58623
BROSZ ENGINEERING
ID: LS-3366
W: 701/523-3340
H: 701/523-5547
C:
Fax: 701/523-5243
Email: johnp@brozengineering.com

PEARSON, RILEY

PO Box 2023
DICKINSON ND 58602
AE2S
ID: ASC
W: 7012259636
H:
C:
Fax:
Email: riley.pearson@ae2s.com

PEARSON, JASON

2000 INDUSTRIAL DR PO BOX 1098
BISMARCK ND 58502
RDO INTEGRATED CONTROLS
ID: SUS
W: 7012235798
H:
C: 7017302052
Fax:
Email: jason.p.pearson@gmail.com

PETERKA, DAREN L.

1026 3RD AVE NE
JAMESTOWN ND 58401
INTERSTATE ENGINEERING INC
ID: LSI
W: 701/252-0234
H: 701/952-5238
C: 701/320-4292
Fax: 701/252-0203
Email: darenp@daktel.com

PEZOLDT, DOUGLAS

1300 N TRANSTECH WAY
BILLINGS MT 59102
SANDERSON STEWART
ID: LS-6825
W: 4066565255
H:
C:
Fax: 4066560967
Email: dpezoldt@sandersonstewart.com

POPADYNETZ, KURTIS

1907 17TH ST SE
MINOT ND 58701
FOCUS CORPORATION
ID: ASC
W: 7018189746
H:
C: 7018189746
Fax:
Email: kurt.popadynetz@focus.ca

PORTWOOD, BRIAN

11301 SE 10TH STREET #219
VANCOUVER WA 98664
BONNEVILLE POWER, US DEPT OF EN-
ERGEY
ID: LS-5280
W:
H: 360/882-3521
C:
Fax:
Email: bportwood@mindspring.com

2014 NDSPLS MEMBERSHIP DIRECTORY

POWERS, JAMES

1917 S HARVARD
OKLAHOMA CITY OK 73108
RED PLAINS SURVEYING CO
ID: LS-6050
W: 4056037842
H: 4053543460
C: 4057065626
Fax: 405/603-7852
Email: mick@rpsurveying.com

PRIBULA, GERALD

14796 450TH AVE NW
E GRAND FORKS MN 56721
PRIBULA ENGINEERING
ID: LS-2257
W: 701/772-7058
H: 218/773-9300
C:
Fax:
Email:

PRIBULA, NICHOLAS

3210 BELMONT RD
GRAND FORKS ND 58201
PRIBULA ENGINEERING & SURVEYING
ID: LS-8587
W: 7017727058
H: 7013888450
C: 7013888450
Fax: 701/772-7058
Email: npribula@gmail.com

PRIVRATSKY, JAMES

PO BOX 290
DICKINSON ND 58602
KADRNAS, LEE, AND JACKSON
ID: LS-3878
W: 701/483-1284
H: 701/225-1045
C: 701/260-2318
Fax: 701/483-2795
Email: jim.privratsky@kljeng.com

PROCIVE, ROBERT

12760 35TH ST SW
BELFIELD ND 58622
INTERSTATE ENGINEERING, INC.
ID: LS-2884
W: 701/575-2247
H: 701/575-4099
C: 701/290-5775
Fax: 701/575-2251
Email: robert.procive@interstateeng.com

PUGH, BILL

PO BOX 121
SHERIDAN WY 82801
WOOD GROUP
ID: LS-6846
W: 3076756427
H: 3076725640
C: 3077515184
Fax:
Email: bill.pugh@woodgroup.com

RAY, MICHAEL

212 HIGHLAND DRIVE
WILLISTON ND 58801
MORRIS & RITCHIE ASSOCIATES
ID: LS-8250
W: 7016095250
H: 8437577830
C: 7016091865
Fax: 701-609-5252
Email: mray@mragta.com

REBSCH, CHARLES

1544 22ND AVE S
FARGO ND 58103
HOUSTON ENGINEERING, INC.
ID: LS-6610
W: 7012375065
H: 7012936674
C:
Fax: 701/237-5101
Email: crebsch@houstoneng.com

RICH, GREGORY

PO BOX 1042
JAMESTOWN ND 58402
TAMARAC LAND SURVEYING, LLC
ID: LS-6408
W: 7013688898
H: 7154160044
C:
Fax:
Email: gre-grich@tamaraclandsurveying.com

RICHTER, JAMES S.

255 N 4TH STREET
PO BOX 5200
GRAND FORKS ND 58206
CITY OF GRAND FORKS
ID: ASC
W: 701/746-2691
H:
C:
Fax: 701/787-3744
Email: jrichter@grandforksgov.com

RINTAMAKI, EDWARD

13046 74TH ST NW
ALAMO ND 58830
SANDERSON STEWART
ID: LS-7664
W: 7015802651
H: 7015284342
C:
Fax:
Email: yoooper_ed@hotmail.com

RITTENHOUSE, BRIAN

15 21ST ST S, SUITE 205
FARGO ND 58103
RITTENHOUSE AND ASSOCIATES
ID: LS-1196
W: 701/237-6542
H: 2184392839
C: 701/238-1719
Fax: 701/232-4103
Email: rittenhouseinc@hotmail.com

ROBERTSON, JASON

PO BOX 237
BOTTINEAU ND 58318
WOLD ENGINEERING, PC
ID: LSI-11598
W: 7012282292
H: 7012282292
C:
Fax: 701/228-3938
Email: jasonrob@woldengr.com

ROBERTSON, BRADLEY

PO BOX 237
BOTTINEAU ND 58318
WOLD ENGINEERING, PC
ID: LS-3199
W: 701/228-2292
H: 701/228-3679
C:
Fax: 701/228-3938
Email: brobert@woldengr.com

ROBINSON, CHRIS

253 24TH ST E
DICKINSON ND 58601
HIGHLANDS ENGINEERING & SURVEY-
ING
ID: LS-8608
W: 7014832444
H:
C: 6143143611
Fax:
Email: robinson@highlandseng.com

2014 NDSPLS MEMBERSHIP DIRECTORY

ROCK, EDWARD

5780 KELSEY DRIVE
SHOREWOOD MN 55331
URS, INC. - BISMARCK
ID: LS-6582
W: 9526460236
H:
C: 6128496270
Fax:
Email: edward.rock@urs.com;
rock3ps@yahoo.com

RONNING, JEFF

128 SOO LINE DRIVE
BISMARCK ND 58501
KADRMAS, LEE AND JACKSON INC
ID: ASC
W: 701/355-8400
H: 701/258-5332
C: 701/391-8898
Fax:
Email:

RUDOLPH, KIRBY

3120 E BROADWAY AVENUE
BISMARCK ND 58501
HOLLY BECK SURVEYING AND ENGI-
NEERING, LLC
ID: ASC
W: 701/223-3546
C:
Fax: 701/224-1337
Email: krudolph@hollybecksurveying.com

RUGLAND, GREG

PO BOX 53
GEYSER MT 59447
UINTAH ENGINEERING
ID: LS-6612
W:
H: 7015096372
C:
Fax:
Email: northarrow@3rivers.net

RUTZEN, STEPHEN G.

2900 10TH ST SW, STE A
MINOT ND 58702
KADRMAS LEE AND JACKSON
ID: LS-6551
W: 701/839-3383
H: 701/578-5359
C:
Fax: 701/838-3578
Email: steve.rutzen@kljeng.com

SANSOM, MICHAEL

308 2ND AVE NORTH
GRAND FORKS ND 58203
CPS, LTD
ID: LS-3141
W: 701/738-4052
H:
C: 2187911676
Fax: 701/746-8948
Email: msansom@cpsnd.com

SAUBER, JOHN

1602 9TH AVE NW
MANDAN ND 58554
SAUBER ENGINEERING
ID: LS-8427
W: 7017515993
H:
C: 7012203809
Fax: 701/663-6577
Email: jsaueng@bis.midco.net

SAUTER, DAN

811 N 32ND ST
BISMARCK ND 58501
STATE WATER COMMISSION
ID: LSI-7606
W: 701/328-2752
H: 701/258-3401
C:
Fax:
Email: dsauter@nd.gov

SCHAAR, TREVOR

3619 CHISHOLM PLACE
BISMARCK ND 58503
THE FALKIRK MINING CO
ID: ASC
W: 7012502605
H: 701/371-7490
C:
Fax:
Email: trevor.schaar@nacoal.com

SCHIRADO, DUSTIN

97 CUSTER DRIVE
LINCOLN ND 58504
BARTLETT & WEST
ID: ASC
W: 7012581110
H: 7015275988
C:
Fax:
Email: dustin.schirado@bartwest.com

SCHLIEMAN, JIM

1401 21ST AVE N
FARGO ND 58102
HOUSTON ENGINEERING, INC.
ID: LS-6086
W: 701/237-5065
H:
C:
Fax: 701-237-5101
Email: jschlieman@houstoneng.com

SCHMALZ, BRIAN

922 29TH ST W
DICKINSON ND 58601
KADRMAS, LEE & JACKSON
ID: LS-6809
W: 7014831284
H:
C:
Fax: 701/483-2795
Email: brian.schmalz@kljeng.com

SCHUHKNECHT, DOUG

3456 E CENTURY AVE
BISMARCK ND 58503
BARTLETT & WEST
ID: ASC
W: 7012218387
H:
C:
Fax:
Email: doug.schuhknecht@bartwest.com

SCHWINDT, DAVID

PO BOX 290
DICKINSON ND 58602
KADRMAS LEE AND JACKSON
ID: LS-1232- LIFE
W: 701/483-1284
H: 701/225-5542
C: 7012602297
Fax: 701/483-2795
Email: dave.schwindt@kljeng.com

SCOTT, STEVEN K.

35283 COUNTY ROAD 127
SIDNEY MT 59270-4230
SCOTT LAND SURVEYING
ID: LS-5146
W: 406/482-9670
H: 406/482-9670
C: 405/480-0689
Fax: 406/482-9109
Email: skspls@middrivers.com

2014 NDSPLS MEMBERSHIP DIRECTORY

SEIBEL, STANLEY

204 COUNTY ROAD 15
BEULAH ND 58523
THE COTEAU PROPERTIES CO.
ID: LS-3950
W: 701/873-7242
H: 701/748-6270
C:
Fax: 701/873-7042
Email: stan.seibel@nacoal.com

SEMERAD, JUSTIN

759 22ND ST W
DICKINSON ND 58601
KADRMAS LEE & JACKSON
ID: ASC
W:
H:
C: 7012607895
Fax:
Email: justin.semerad@kljeng.com

SHAFER, JOHNNIE R.

3030 AIRPORT RD #A
PIERRE SD 57501
BROSZ ENGINEERING INC.
ID: LS-4019
W: 605/224-1123
H:
C: 605/280-3679
Fax: 605/224-0659
Email: johnnies@brozengineering.com

SHERLOCK, BECKY R.

622 2ND ST NE
MINOT ND 58703
KADRMAS LEE AND JACKSON
ID: ASC
W: 7018393383
H: 7017201104
C:
Fax:
Email: becky.sherlock@kljeng.com

SKARPHOL, CURTIS

813 19TH AVE S
FARGO ND 58103
HOUSTON ENGINEERING, INC.
ID: LS-4723
W: 701/237-5065
H: 701/293-0827
C:
Fax: 701/237-5101
Email: cskar-phol@houstonengineeringinc.com

SKATTUM, AARON

3303 FIECHTNER DR
FARGO ND 58103
WENCK ASSOCIATES
ID: LS-6153
W: 7018932324
H: 7013618623
C: 7013618623
Fax:
Email: askattum@wenck.com

SKINNER, DANIEL

2300 BEMIDJI AVE N #101
BEMIDJI MN 56601
KARVAKKO ENGINEERING
ID: LS-6206
W: 2184448004
H: 2188500328
C:
Fax:
Email: dan.skinner70@gmail.com

SLEMP, JEREMY

3456 E CENTURY AVE
BISMARCK ND 58503
BARTLETT & WEST
ID: ASC
W:
H:
C:
Fax:
Email: jeremy.slemp@bartwest.com

SLETTEN, ADAM

4050 GARDEN VIEW DR #200
GRAND FORKS ND 58201
AE2S
ID: ASC
W:
H: 2182305722
C: 2182305722
Fax:
Email: adam.sletten@ae2s.com

SLETVOLD, DUSTY

1998 GOLDENROD LANE
SIDNEY MT 59270
ID: LS-6885
W: 4064884532
H:
C:
Fax:
Email: dsletvold@gmail.com

SMALL, MICHAEL

411 N WEBB RD
WICHITA KS 67206
MKEC ENGINEERING
ID: LS-8220
W: 3166849600
H: 3167752781
C: 3162599888
Fax: 316-684-1426
Email: msmall@mkec.com

SMITH, LARRY J.

909 BASIN AVENUE
BISMARCK ND 58504
SWENSON HAGEN AND CO
ID: LS-2363
W: 701/223-2600
H: 701/258-3827
C:
Fax: 701/223-2606
Email: lsmith@swensonhagen.com

SMITH, LLOYD

PO BOX 50
VALENTINE NE 69201
NIOBRARA VALLEY CONSULTANTS
ID: LS-3083
W: 402/376-2691
H: 402/376-2029
C: 402-376-4190
Fax: 402/376-2692
Email: nvcllc95@gmail.com

SNIDER, DURHAM

1303 14 1/2 ST S
FARGO ND 58103
RITTENHOUSE & ASSOC., INC.
ID: LS-8426
W: 7012376542
H: 7012986237
C:
Fax:
Email: daemonpi@yahoo.com

SOLEM, DAYNE

909 BASIN AVE
BISMARCK ND 58504-6648
SWENSON HAGEN AND CO
ID: LS-8423
W: 701/223-2600
H: 701/255-0935
C:
Fax:
Email: dsolem@swensonhagen.com

2014 NDSPLS MEMBERSHIP DIRECTORY

SOLLID, NORMAN S.

5132 14TH AVE N
GRANVILLE ND 58741
SELF-EMPLOYED
ID: LS-3594
W: 701/624-5664
H: 701/624-5664
C: 7017203795
Fax:
Email: norm.sollid@gmail.com

STADLER, NATE

2638 SHADOW LANE #200
CHASKA MN 55318
BOLTON & MENK, INC.
ID: LS-9240
W:
H: 9524452501
C:
Fax:
Email: natest@bolton-menk.com

STANHOPE, BOB

2010 MONTANA AVE
GLEN DIVE MT 59330
W.B.I. ENERGY TRANSMISSION
ID: LS-3593
W: 406/359-7200
H: 406/365-6339
C: 406/989-1062
Fax: 406/359-7225
Email: bob.stanhope@wbip.com

STATTELMAN, NICK

3170 43RD ST S #100
FARGO ND 58104
ADVANCED ENGINEERING
ID: LS-8218
W: 2182995610
H: 218/230-4358
C: 218/230-4358
Fax: 218/299-5611
Email: Nick.Stattelman@ae2s.com

STRAIN, MILES

13400 68 AVE N
MAPLE GROVE MN 55311
QUANTUM SPACIAL, INC.
ID: SUS
W: 7634209606
H:
C: 7634423398
Fax: 763-420-9584
Email: mstrain@quantumspatial.com

STROEING, GREGG

820 11TH ST E #201
WILLISTON ND 58801
ULTEIG ENGINEERS
ID: LS-6703
W: 7012808714
H: 3202538744
C: 3203335873
Fax:
Email: STROINK56@HOTMAIL.COM

SULLIVAN, LARRY

4550 N 12TH ST
PHOENIX AZ 85014
CVL CONSULTANTS
ID: LS-7668
W: 6026854712
H:
C: 6029207910
Fax:
Email: lsullivan@cvlci.com

SWANSON, STEVEN

4050 GARDEN VIEW DRIVE #200
GRAND FORKS ND 58201
ADVANCED ENGINEERING
ID: LS-4185
W: 701/746-8087
H:
C:
Fax: 701/746-0370
Email: Steve.Swanson@ae2s.com

SWENSON, THOMAS

25070 STATE RD 35
SIREN WI 54872
SWENSON LAND SURVEYING
ID: LS-7969
W: 7153495263
H:
C:
Fax:
Email: swenson@sirentel.net

SWENSON, MEGAN

PO BOX 1042
JAMESTOWN ND 584021042
TAMARAC LAND SURVEYING, LLC
ID: LS-8088
W: 7013688898
H:
C: 7154160044
Fax:
Email: meganswenson@tamaraclandsurveying.com

TARNOWSKI, MIKE

2409 36TH PLACE
WILLISTON ND 58801
INTERSTATE ENGINEERING
ID: ASC
W:
H: 7015808540
C:
Fax:
Email: mike.tarnowski@interstateeng.com

TAYLOR, SHELTON

128 SOO LINE DRIVE
BISMARCK ND 58501
KADRMAS, LEE & JACKSON
ID: LS-8422
W:
H:
C:
Fax:
Email: pex998@gmail.com

THOMASSON, SHAWN

3712 LOCKPORT ST
BISMARCK ND 58501
HOUSTON ENGINEERING, INC.
ID: LS-5900
W: 7013230200
H: 701/799-4055
C:
Fax:
Email: SThomasson@houstoneng.com

THOMPSON, ROSE

1717 E INTERSTATE AVE
BISMARCK ND 58501
BASIN ELECTRIC POWER
ID: ASC
W: 7015575663
H: 701/258-0801
C:
Fax: 701/224-5322
Email: rthompson@bepec.com

THOMPSON, ADAM

407 N RIVER AVE
GLEN DIVE MT 59330
STATELINE SURVEYS
ID: LS-6175
W: 4063771483
H: 406/377-1662
C: 4069393494
Fax:
Email: statelinesurveys@gmail.com

2014 NDSPLS MEMBERSHIP DIRECTORY

THORESON, KENT G.

PO BOX 6
NEW EFFINGTON SD 57255
INTERSTATE ENGINEERING
ID: LS-5774
W: 701/642-5521
H: 605/637-5555
C: 701/899-0998
Fax: 701/642-5521
Email: kentt@iengi.com

TORRES, JERRY

810 2ND ST N #2
BISMARCK ND 58501
KLJ
ID: ASC
W: 7013558400
H: 7014254200
C:
Fax:
Email: jerry.torres@kljeng.com

TRAVISS, TOM

328 N 31ST ST #16
BISMARCK ND 58501
TAIT & ASSOC.
ID: LS-
W:
H: 7019342226
C:
Fax:
Email: tc_trav@yahoo.com

VAN DYKE, ROBERT

200 10TH ST NW
MINOT ND 58703
WGPS
ID: LS-6704
W: 7018371841
H: 7018371183
C:
Fax:
Email: robert.vandyke@woodgroup.com

VENDER, CARL

BOX 239
NAPOLEON ND 585610239
SEMI-RETIRED
ID: LS-1222
W:
H: 7017544100
C:
Fax:
Email: grandpavender@yahoo.com

VOLESKY, STEVEN A

60 8th STREET W
DICKINSON ND 58601
USDA FOREST SERVICE
ID: LS-3367
W: 701/227-7855
H: 701/483-6992
C:
Fax: 701/227-7701
Email: svolesky@fs.fed.us

WAGNER, DANIEL

1525 9th STREET
FARGO ND 58102
KADRMAS LEE AND JACKSON
ID: LS-7193
W: 7012325353
H:
C:
Fax:
Email:

WALSVIK, ADAM

1360 ZURRAFT DR
MENOKEN ND 58558
FALKIRK MINING COMPANY
ID: ASC
W: 7012502614
H:
C: 7018701246
Fax:
Email: adam.walsvik@nacoal.com

WALTER, BRIAN

WARD COUNTY HWY DEPT
ID: ASC
W: 701/838-2810
H: 701/839-1102
C: 701/721-1824
Fax: 701/838-3801
Email: brian.walter@wardnd.com

WALTER, ALAN M.

805 BAVARIA DR
MINOT ND 58702
ACKERMAN-ESTVOLD
ID: LS-1174
W: 7018378737
H: 701/838-5258
C:
Fax: 701/857-4130
Email:

WAMRE, ROSS R.

1024 THIESSE DRIVE
BRAINERD MN 564016532
KADRMAS LEE AND JACKSON
ID: LS-4626
W: 2188286330
H: 2187908111
C: 218/790-8111
Fax: 218/287-6313
Email: ross.wamre@kljeng.com

WARNER, DENNIS

15182 SAG04
WARBA MN 55793
SHORT ELLIOTT HENDRICKSON
ID: LS-7000
W: 2183224518
H: 2184921674
C: 2182599436
Fax:
Email: dwarnar@sehinc.com

WEEKS, MATTHEW L

1717 INTERSTATE AVE
BISMARCK ND 58503
BASIN ELECTRIC POWER COOPERA-
TIVE
ID: LS-3626
W: 7015575659
H: 701/255-2918
C: 701/471-8973
Fax: 701/224-5322
Email: mweeks@bepc.com

WEIGEL, TOM

3120 E BROADWAY AVENUE
BISMARCK ND 58501
HOLLY BECK SURVEYING & ENGI-
NEERING
ID: LSI
W: 7012233546
H: 7014717430
C:
Fax:
Email: tweigel@hollybecksurveying.com

WELINSKI, MATTHEW

1024 THIESSE DRIVE
BRAINERD MN 56401
KLJ
ID: LSI
W: 2188286330
H:
C: 2188213035
Fax:
Email: matt.welinski@kljeng.com

2014 NDSPLS MEMBERSHIP DIRECTORY

WESTRUM, RODNEY

7010 3RD AVE E
WILLISTON ND 58801
WESTRUM'S LAND SURVEYING
ID: LS-1195
W: 701/774-8605
H: 701/774-8605
C: 701/570-0316
Fax: 701/572-7681
Email: rwestrum@nemontel.net

WHETHAM, ALLEN E.

1007 23RD AVE S
GRAND FORKS ND 58201
USDA-NRCS
ID: LS-2997
W: 701/436-4311 X113
H: 701/775-6317
C:
Fax:
Email: allen.whetham@nd.usda.gov

WICKLUND, JOHN R.

1119 UNIVERSITY DRIVE #1016
BISMARCK ND 58504
WICKLUND SURVEYING
ID: LS-2491
W: 701/400-3797
H: 701/400-3797
C: 701/400-3797
Fax:
Email: jjrw2492@aol.com

WIENS, PETER F.

3456 E CENTURY AVE
BISMARCK ND 58503
BARTLETT AND WEST INC
ID: ASC
W: 701/258-1110
H: 701/400-9377
C:
Fax:
Email: pete.wiens@bartwest.com

WILLIAMSON, CLYDE

PO BOX 937
VALLEY CITY ND 58072
KLJ
ID: ASC
W: 701-845-4980
H: 701-845-2719
C:
Fax:
Email: clyde.williamson@kljeng.com

WINKLER, SCOTT A.

642 9TH AVE SE
VALLEY CITY ND 58072
KADRMAS LEE AND JACKSON
ID: ASC
W: 701/845-4980
H: 701/845-1151
C: 701/490-1614
Fax:
Email: scott.winkler@kljeng.com

WISTED, BRADLEY

30637 OLSON ST #305
PEQUOT LAKES MN 56472
S E H, INC.
ID: LSI
W:
H:
C:
Fax:
Email: brwisted@charter.net

WITTER, DARRYL

288 E SUNSET DR
BURBANK WA 99323
WHITE SHIELD, INC.
ID: LS-7836
W:
H: 5096715880
C:
Fax:
Email: dwitter@whiteshield.com

WITTSTOCK, JEROME C.

3701 12TH ST N, SUITE 206
ST CLOUD MN 56303
WESTWOOD PROFESSIONAL SRVCS
ID: LS-5869
W: 320/253-9495
H: 320/274-6225
C: 612/799-1829
Fax: 320/253-8737
Email: jay.wittstock@westwoodps.com

WOOD, JEREMY

141 THIRD ST W
DICKINSON ND 58601
NORTHERN PLAINS ENGINEERING
ID: LS-5651
W: 7014831858
H: 7014835080
C:
Fax:
Email: jwood@nplainseng.com

WURGLER, JEREMY

4440 49TH ST S
FARGO ND 58104
HOUSTON ENGINEERING, INC.
ID: LS-6918
W: 7012375065
H:
C: 7012611392
Fax:
Email: jwurgler@houstoneng.com

ZAHN, ROBERT

1310 RIVERWOOD DR
BISMARCK ND 58504
ND DEPT OF TRANSPORTATION
ID: LS-3659
W: 701/328-2149
H: 701/221-2663
C:
Fax: 701/328-4545
Email: rzahn@nd.gov

ZELMER, BRUCE

3456 E CENTURY AVE
BISMARCK ND 58503
BARTLETT AND WEST INC
ID: LS-3756
W: 701/258-1110
H:
C: 701/226-2961
Fax: 701/258-1111
Email: bruce.zelmer@bartwest.com

Zimmerman, Matt

3456 E. Century Avenue
Bismarck ND 58503
Barlett & West
ID: LSI
W: 7012581110
H: 6053107622
C:
Fax:
Email: matt.zimmerman@bartwest.com

ZIMMERMAN, DAVID

309 GEORGETOWN DR
GLEN DIVE MT 59330
UINTAH ENGINEERING & LAND SUR-
VEYING
ID: LS-2999
W: 406/433-9650
H: 406/365-2155
C: 406/480-4359
Fax: 406/433-9653
Email: dzimmerman@uintahgroup.com

2014 NDSPLS MEMBERSHIP DIRECTORY

ZIMNY, MICHAEL

211 WEST SWEET AVENUE
BISMARCK ND 585045569
MERIDIAN LAND SURVEYS
ID: LS-3132
W: 701/258-2424
H: 701/258-9750
C: 701/471-1861
Fax: 701/258-9750
Email: mikeyz@btinet.net

ZISKA, JAKE

6084 ANNA BROWN ROAD
HELENA MT 59602
WWC ENGINEERING
ID: LS-7390
W: 4064433962
H:
C: 4065814834
Fax:
Email: jziska@wwcengineering.com

2014 NDSPLS MEMBERSHIP DIRECTORY

Membership Data

YEAR	LIFE	NSPS	PLS	LSIT	NEW PLS	ASSOC	SUS	STUDENT	TOTAL
1979	0		78	0		?	?	?	133
1980	0		93	0		63	7	6	169
1981	0		107	0		73	9	2	191
1982	0		109	0		56	8	0	173
1983	0		104	0		61	8	1	174
1984	0		0	0		0	0	0	0
1985	0		107	0		38	6	0	151
1986	0		106	0		44	7	4	161
1987	0		101	0		46	6	4	157
1988	0		94	0		37	6	6	143
1989	0		88	0		44	7	0	139
1990	0		88	0		32	7	2	129
1991	0		76	0		28	5	2	111
1992	0		83	0		23	6	0	112
1993	0		68	9		21	5	0	103
1994	3		102	11		27	4	0	147
1995	3		108	11		25	7	2	156
1996	3		116	7		27	8	3	164
1997	1		114	8		21	8	1	153
1998	1		126	9		21	7	0	164
1999	1		112	8		26	8	1	156
2000	2		130	11		33	7	14	197
2001	6		126	11		28	4	8	183
2002	5		148	11		36	5	3	208
2003	6		132	10		36	6	1	191
2004	8		145	11	9	40	9	3	225
2005	10		133	17	7	45	9	2	223
2006	10		135	18	7	50	8	3	231
2007	11		133	23	3	47	7	1	225
2008	9		139	18	9	55	8	1	239
2009	12		136	17	30	59	8	4	266
2010	13		145	26	10	60	8	1	263
2011	15		153	27	14	64	8	1	282
2012	16		184	26	2	74	10	1	339
2013	16		195	26	2	61	8	1	309
2014	14	139	198	23	3	59	6	0	303

As of 05/22/14

**North Dakota Society of
Professional Land Surveyors**
1811 E. Thayer Avenue
Bismarck, ND 58501

**Presort Standard
U.S. Postage
PAID
Permit #222
Bismarck, ND 58501**