

PRESORTED
STANDARD
U.S. POSTAGE PAID
Permit No. 419
Bismarck, ND 58501

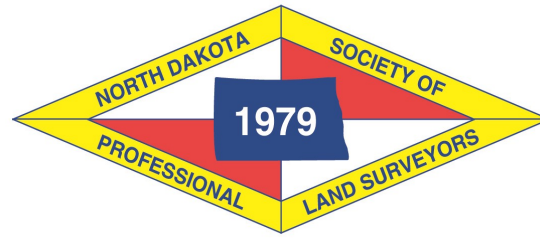

2018 FALL EDUCATION SEMINAR

November 28-29, 2018

Bismarck State College
National Energy Center of Excellence
1500 Edwards Avenue
Bismarck, ND 58501

North Dakota Society of Professional Land Surveyors

Box 7370
Bismarck, ND 58507
Phone: 701-223-3184
Email: info@ndspls.org
Website: www.ndspls.org

About our Presenters



Jan Van Sickle has many years of experience in GIS, GPS, surveying, mapping and imagery. He holds a Ph.D. in geospatial engineering from the University of Colorado and is a Senior Lecturer at Penn State University and teaches at the University of Colorado Denver. He has been an advisor in geospatial matters for several notable companies and began working with GPS in the early 1980s when he supervised control work using the Macrometer, the first commercial GPS receiver.

He has led nationwide seminars based on his three books, *GPS for Land Surveyors*, *Basic GIS Coordinates and Surveying Solved Problems*. He led the team that collected, processed and reported control positions for more than 120 cities around the world for the ortho-rectification of satellite imagery now utilized in a global web utility. He managed the creation of the worldwide T&E sites for two major earth observation satellites which are used for frequent accuracy assessments. He conducted a spatial accuracy comparison study for Digital Globe in Durban, South Africa, Seoul, South Korea and Rio De Janeiro, Brazil.

He created an imagery-based system of deriving road centerlines that meet the stringent Advanced Driver Assistance specifications and developed a method of forest inventory to help quantify that depleted resource in Armenia. He assisted the supervision of the first GPS survey of the Grand Canyon for the photogrammetric evaluation of sandbar erosion along the Colorado. He has done 3D mapping with terrestrial photogrammetry and LiDAR as well as Building Information Modeling. He was involved in the creation of a BIM of the White House in Washington DC. He was a member of the team of authors for the Geospatial Technology Competency Model for the Department of Labor. He has conducted training at the NAVCEN in Alexandria for the USCG. He has provided technical assistance in the reconstruction of the geodetic network of Nigeria. He has managed the gravity/magnetic and hyperspectral/multispectral analysis of Borzou VII a concession block in the South Gobi in Mongolia. He writes the From Scratch blog for the Spar Point Group.

He has been a licensed professional Land Surveyor for thirty-six years.



Dave Zenk is a Geodesist with the National Geodetic Survey, serving as Regional Geodetic Advisor for the Northern Plains Region (MN, ND, SD, IA, NE). He holds Bachelor of Science Degrees in Civil Engineering and Mechanical Engineering from the University of Minnesota and a Master's Degree in Land Surveying from Oregon State University. He has served as adjunct faculty at the University of Minnesota Geography Department and at Saint Cloud State University Geography Department. He is a past Chair of the Minnesota GIS/LIS Consortium. He is currently serving as Editor of the MSPS "Minnesota Surveyor" magazine. He is licensed as a Registered Land Surveyor and Professional Engineer in the State of Minnesota.

NGS is preparing to release new datums in 2022. Surveyors need to understand and prepare for them. This session will offer a policy update on SPCS2022, GEOID18, NATRF2022/NAPGD2022 - new datums and the NCAT - coordinate conversion tool.



NDSPLS 2018 FALL EDUCATION SEMINAR

Registration Form

The deadline for registrations is **November 12, 2018**. All registrations postmarked after November 12 will be assessed a \$25 late registration fee. NO REFUNDS or substitutions will given after November 12, 2018. Late registrations will also be accepted on site. One form per person — **please type or write legibly.**

Special Accommodations: NDSPLS is committed to providing access to all individuals attending the conference. Those needing any special accommodations or dietary restrictions should email info@ndspls.org prior to November 12th, 2018.

Name _____		
Firm _____		
Address _____		
City _____	State _____	Zip _____
Phone _____	E-mail _____	

Registration Fees:

By Check

Registration Fee includes lunches on Wednesday, November 28 and Thursday, November 29

NDSPLS Members	\$170.00 _____
Non-Members	\$210.00 _____

TOTAL _____

Those using Pay Pal or Credit Card, please go to our website: www.ndspls.org

Payment Information:

___ Check Enclosed (Mail to: NDSPLS, Box 7370, Bismarck, ND 58507)

Agenda

November 27, 2018

7:00 -9:00 PM.....Board of Director's Meeting
Hampton Inn & Suites
2020 Schafer Street, Bismarck

November 28, 2018 - (8 PDHs)

8:00 a.m..... Registration
8:30 a.m..... Jan VanSickle —
Best Practices for GPS Today
10:10 a.m..... Break
10:20 a.m..... Session continues (4 PDHs)
Noon Lunch
1:00 p.m..... Jan VanSickle -
Error Analysis and Least-Squares (2PDHs)
3:00 p.m..... Break
3:15 p.m..... Dave Zenk -
SPCS 2022—policy update, GEODI18,
NATRF2022/NAPGD2022 - new datums
NCAT - coordinate conversion tool (2PDHs)
5:00 p.m..... Sessions End

November 29, 2018 - (8 PDHs)

8:00 a.m..... Registration
8:30 a.m..... Jan VanSickle
Coordinates & Geodesy
10:10 a.m..... Break
10:20 a.m..... Session continues (4 PDHs)
Noon Lunch
1:00 p.m..... Jan VanSickle
GPS Modernization & GNSS
3:00 p.m..... Break
3:15 p.m..... Session continues (4 PDHs)
5:00 p.m..... Wrap-up & Adjourn

PDH Credits: Participants who attend the seminar will be awarded 16 PDHs for this program. You must attend the entire A.M. or P.M. session to earn the 4 hour PDH. Be sure to sign in at the sessions.

Room Reservations

A block of rooms have been reserved at the Hampton Inn & Suites Bismarck—Northwest, 2020 Schafer Street, Bismarck, ND. Rooms will be held until November 5, 2018. Please indicate that you are with the Land Surveyors when making your room reservation. The hotel telephone number is 701-751-5656. The web page address for our group reservations is: https://secure3.hilton.com/en_US/hp/reservation/book.htm?execution=elsl

Room Rates

King.....\$114.00 + tax
Queen (2).....\$114.00 + tax

For More Information

For more information regarding seminar details please contact:

Jason Main (701.838.0786) or
Larry Smith (701.220.9843)
Education Chairman

or

Staiger Consulting Group
NDSPLS Executive Director Team
701.223.3184
Info@ndspls.org

Mail all registrations to:
NDSPLS Fall Education Seminar
PO Box 7370
Bismarck, ND 58507

