

PRESORTED
STANDARD
U.S. POSTAGE PAID
Permit No. 419
Bismarck, ND 58501

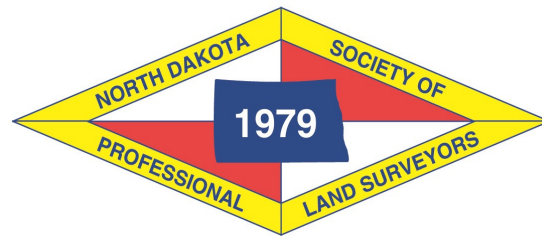

2019 FALL EDUCATION SEMINAR

December 4-5, 2019

Bismarck State College
National Energy Center of Excellence
1500 Edwards Avenue
Bismarck, ND 58501

North Dakota Society of Professional Land Surveyors
Box 7370
Bismarck, ND 58507
Phone: 701-223-3184
Email: info@ndspls.org
Website: www.ndspls.org

About our Presenter



Warren Ward began surveying in Colorado for his father in 1972. He became licensed in Colorado in 1989, and Oklahoma in 2015.

He is currently acting as the elected county surveyor of Grand County, Colorado, a part time unfunded position he has held since 1991. He makes most of his income as a privateer surveyor. As a county surveyor, Ward testified in several lawsuits for the county. He has also testified in several lawsuits as a consultant to the State Board, in legal actions against surveyors.

Ward became involved in PLSC as a Board Member in 1994, and held the positions of Vice President, President of PLSC and Colorado Governor to NSPS until 2014. He has served as President of both the Colorado and National Associations of County Surveyors.

Ward has been an active member of the PLSC Legislative Committee since 1996. He has testified to the Colorado Legislature regarding every Bill of interest to surveyors introduced every year since 1996. He has authored, and co-authored several statute laws pertaining to land surveying. He is currently a member of the NSPS Trig-Star committee and he is an original contributing author to xyHt Magazine.

Warren will be presenting “*Monuments Make the Math and 1,001 Reasons Why Surveyors Plant Pin Gardens Anyway*” which includes the following sessions:

Session 1: Unraveling A Pingarden: Do we determine which of the multiple monuments we find represents the legal property corner, do we determine which of the multiple monuments we find represents the best, most precise measurement, or do we set a new monument according to our calculation?

Session 2: The Legal Process of Surveying: Is a property line the culmination of a perfect, precise, field measurement, or is a perfect, precise field measurement the culmination of a property line?

Session 3: Surveying as the Creator of a Country: How the U.S. judicial system followed the path-finding survey crews across the Nation, upholding the order that is taken for granted by society. How the setting of multiple monuments cause the precise opposite of the order that we are expected to promote as a profession.

Session 4: Current and Future Laws: Every State allows only licensed surveyors to set monuments that bear the seal of a licensed professional assuming the liability for a property corner. How did the current laws come into effect? How can current statute law be utilized to reduce the number of pingardens? How can the statutes be improved to promote order and retracement by reducing the confusion of multiple monuments?



