

2019 MEMBERSHIP DIRECTORY

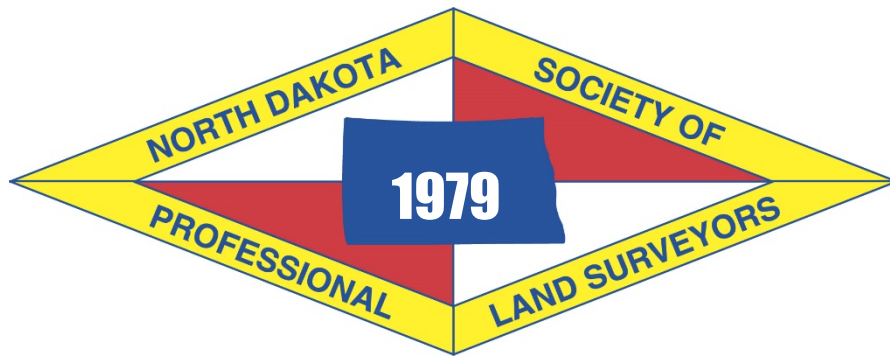

NORTH DAKOTA SOCIETY OF PROFESSIONAL LAND SURVEYORS

Affiliate of the National Society of Professional Surveyors

Table of Contents

Officers and Directors	2
Committees and Chairmen.....	2
Survey Excellence Awards.....	3
Past Presidents	3
Membership Listing.....	4
Membership Data.....	28
Membership Application	29

PO Box 7370
Bismarck, ND 58507
Phone: 701-222-3184
Email: info@ndspls.org
Website: www.ndspls.org

2019 Officers & Directors

President

Jason Main

President Elect

Tom Leshovsky

Vice President

Carl Olson

Secretary

Aaron Hummert

Treasurer

Tom Weigel

Past President

Ed Rintamaki

Flatlanders Chapter

Ryan Link

Badlands Chapter

Robert Procive

Great Plains Chapter

Jeff Jelinek

Missouri Breaks Chapter

Tim Sorensen

Missouri River Chapter

Robert Illg

Northern Lights

Gregg Orvik

NSPS Director

Curt Glasoe

2019 Committees & Chairmen

Admin. Secretary Steve Ackerman & Gary Ness

Awards..... Chris Jordheim

2019 Convention Flatlanders Chapter

Education Tom Leshovsky & Larry Smith

Education Assistance Program..... Matt Weeks

Ethics..... Mike Sansom

GIS..... Aaron Norby

Manual of Practice for Land Surveying in ND..... Greg Johnson

Historical..... LeRoy Kautz & Russ Kastle

LSI Ken Link

Industry Committee Ed Rintamaki

Legislation & Bylaws..... Aaron Hummert & Curt Glasoe

MembershipCarl Olson

Nominations Ed Rintamaki

Policy & Procedures Manual Great Plains Chapter

Public Information Todd Norton

Right of Entry Jason Ness

TrigStar Jeff Jelinek

UAV Committee Greg Obrigewitsch

Web Site Steve Langlie

Young Surveyors Jason Ness

NDSPLS Administrative Office

PO Box 7370

Bismarck, ND 58501

Staiger Consulting Group

Administrative Secretary

Phone: 701.223.3184

Email: info@ndspls.org

Website: www.ndspls.org

SURVEY EXCELLENCE AWARD

Russell E. Kastle	1987
Carl S. Vender	1988
Harold G. Lusk	1989
Alan W. Erickson	1990
Kenneth J. Link	1992
Doug Herzog	1996
Greg Johnson	1997
Steve Ackerman	1998
Ray LeClerc	1999
Mark Aughtman	2002
Rolly Ackerman	2003
Larry Smith	2004
Rick Leach	2005
Larry Smith	2006
Leland Krein	2008
LeRoy Kautz	2010
Brian Portwood	2013
Curt Glasoe	2014
Matt Weeks	2015
Bruce Zelmer	2016
LeRoy Kautz	2017
Aaron Hummert	2019

PAST PRESIDENTS

T. S. Madson	Feb 16, 1979
DeLane R. Meier	1979 1981
Carl S. Vender	1981 1983
Kenneth J. Link	1983 1984
Rodney A. Westrum	1984 1985
Rolly B. Ackerman	1985 1986
Douglas A. Herzog	1986 1987
Gregory L. Johnson	1987 1988
Michael P. Fandrich	1988 1989
Curtis W. Glasoe	1989 1990
Brian J. Rittenhouse	1990 1991
Donald F. Kaufman	1991 1992
Larry J. Smith	1992 1993
Rodney A. Westrum	1993 1994
Leo J. Horgan	1994 1995
Gary Bean	1995 1996
Steve Ackerman	1996 1997
Michael Zimny	1997 1998
Gary Ness	1998 1999
Robert D. Zahn	1999 2000
Roger Grimsley	2000 2001
Matt Weeks	2001 2002
Michael Sansom	2002 2003
Mark Aughtman	2003 2004
Rick Leach	2004 2005
Kent Orvik	2005 2006
Jim Alber	2006 2007
Steve Volesky	2007 2008
Dan Fischer	2008 2009
Robert Procive	2009 2010
Holly Beck	2010 2011
Kirk Jorgenson	2011 2012
Tim Langerud	2012 2013
Chris Jordheim	2013 2014
Steve Langlie	2014 2015
Gregg Orvik	2015 2016
Aaron Hummert	2016 2017
Charles Rebsch	2017 2018
Ed Rintamaki	2018 2019

Ackerman, Rolly

Ackerman Surveying & Assoc.
1907 17th St SE
Minot, ND 58701-
ID: LS-2391
W: 701/838-0786
H: 701/838-3863
C:
Email: ackerman@minot.com

Ackerman, Steven

Interstate Engineering
107 2nd St S
Wahpeton, ND 58075-
ID: LS-2958
W: (701) 642-5521
H: 701/642-5446
C: 701/899-4273
Email: steve.ackerman@interstateeng.com

Alber, James

Sambatek
8312 White Oak Loop
Bismarck, ND 58501-
ID: LS-4730
W: (701) 663-0718
H: 701/866-0286
C: (701) 866-0286
Email: jalber@sambatek.com

Alexander, Kory

Houston Engineering
18 3rd St SE Suite 100
Minot, ND 58701-
ID: STU
W: (701) 838-0786
H: 7018527931
C:
Email: kalexander@houstoneng.com

Anderson, Aaron

Ackerman Surveying
7950 Hwy 2 East, Lot 111
Minot, ND 58701-
ID: LS-6154
W: (701) 838-0786
H:
C:
Email: a-j-anderson@hotmail.com

Anderson, Matt

KLJ
1036 41st Ave W
West Fargo, ND 58078-
ID: LS-27104
W: (218) 287-0300
H:
C: (701) 566-2480
Email: matt.anderson@kljeng.com

Anderson, Nathan

Lightowler Johnson Associates
1315 5th Avenue North
Moorhead, MN 56560-
ID: LS-8064
W: (701) 293-1350
H: 7012387445
C: (701) 238-7445
Email: nanderson@lja-1.com

Anderson, Levi

SHE
4719 Shelburn Street, St. 6
Bismarck, ND 58503-
ID:
W:
H: 7015502713
C:
Email: lmanderson@sehinc.com

Appleton, Robert

US Fish & Wildlife Service
10555 W Jewell Ave, Apt 10-303
Lakewood, CO 80232-
ID: LS-7176
W: (303) 829-8847
H:
C: (720) 413-4037
Email: appletonrj@q.com

Atterton, Chad

Ackerman Surveying
PO Box 538
Surrey, ND 58785-
ID: LS-8831
W: (701) 852-9210
H:
C:
Email: catterton@srt.com

Aughtman, Mark

USDA Forest Service
99 23rd Street Suite B
Dickinson, ND 58601-
ID: LS-3801
W: 701/227-7835
H:
C: 701/290-3542
Email: maughtman@fs.fed.us

Austin, Nathaniel

Wold Engineering, PC
110 8th Ave SW
Minot, ND 58701-
ID: LS-10415
W: (701) 852-0338
H:
C: (701) 228-8049
Email: naustin@srt.com

Backman, Logan

Interstate Engineering
507 Bookwalter Ave
Wilton, ND 58579-
ID: ASC
W: (701) 663-5455
H:
C: (701) 202-4679
Email: logan.backman@interstateeng.com

Backowski, Jacob

KLJ
1024 Thiesse Dr
Brainerd, MN 56401-
ID: LS
W: (218) 828-6330
H:
C:
Email: jake.backowski@kljeng.com

Baltzer, Terry

Swenson, Hagen & Co.
909 Basin Ave
Bismarck, ND 58504-
ID: LS-3595
W: 701/223-2600
H: 701/258-7053
C:
Email: tbaltzer@swensonhagen.com

Barber, Brett

Houston Engineering
2013 30th Ave S
Fargo, ND 58103-
ID: LSI - 148161
W: (218) 205-0520
H:
C: (218) 205-0520
Email: brettkbarber@gmail.com

Bartholomew, Branden

City of Grand Forks
1562 Kingsview Dr
Grand Forks, ND 58201-
ID: LS-3085
W: 701/746-2647
H: 701/772-5494
C: 218/791-6964
Email: bbartholomew@grandforksgov.com

Beck, Holly

Holly Beck Surveying & Engineering
1431 Eagle Crest Loop
Bismarck, ND 58503-
ID: LS-4934
W: 701/223-3546
H: 701/258-0370
C: 701/400-8768
Email: hollybeck@hollybecksurveying.com

Beebe, Patrick

Williams County Highway Dept
PO Box 1305
Williston, ND 58802-
ID: LS-7726
W: (701) 577-4521
H:
C: (701) 580-3177
Email: patb@co.williams.nd.us

Beggs, Bryan

Retired
3001 11th St SE
Minot, ND 58701-
ID: LS-1556 - LIFE
W:
H: 7018383269
C:
Email: bbeggs@wil.midco.net

Berg, Casey

Advanced Engineering
4050 Garden View Dr #200
Grand Forks, ND 58201-
ID: LS-7191
W: 701/746-8087
H: 701/739-4130
C: 701/740-5847
Email: casey.berg@ae2s.com

Bergherr, Scott

Westwood Professional Services, Inc.
11621 Yarmouth Lane
Frisco, TX 75034-
ID: LS-8231
W: (469) 304-2211
H:
C: (612) 221-3720
Email: scott.bergherr@westwoodps.com

Binstock, Daniel

KLJ
PO Box 1157
Bismarck, ND 58502-
ID: ASC
W:
H:
C: (701) 545-2330
Email: daniel.binstock@kljeng.com

Blauert, Richard

Bartlett & West
3456 E Century Ave
Bismarck, ND 58503-
ID: ASC
W: (701) 258-1110
H:
C: (218) 988-2831
Email: rich.blauert@bartwest.com

Bloomenrader, Scott

330 Rice Lane
Billings, MT 59105-
ID: LS-3290
W:
H: 406/252-2917
C: (406) 694-8650
Email: sbloomenrader@aol.com

Boehning, Duane

Retired
3026 24th Ave S
Fargo, ND 58108-
ID: LS-1186 - LIFE
W:
H: 701/237-6522
C:
Email:

Borgen, Jerome

Retired
10223 461 Ave
New Effington, SD 57255-6103
ID: LS-1406 - LIFE
W:
H: 605/637-5531
C:
Email: zborgens@tnics.com

Brackey, Leon

Mountrail-Williams Electric Co-Op
1814 16th Ct W
Williston, ND 58801-
ID: 10135
W: (701) 577-3765
H: 7015720692
C: (701) 609-3115
Email: lbrackey@gmail.com

Brecht, Mary

The Coteau Properties
204 County Road 15
Beulah, ND 58523-
ID: LS-3921
W: 701/873-7265
H:
C:
Email: mary.brecht@nacoal.com

Brekke, Chris

Ackerman Surveying
215 16th Street SE
Minot, ND 58701-
ID: LS-9187
W: (701) 857-9174
H:
C:
Email: chris.brekke@ackermansurveying.com

Brown, Charles

Golden Field Services
4315 Country Club Drive
Midland, TX 79703-
ID: LS-10328
W:
H:
C: (919) 464-3824
Email: crbrown1155@gmail.com

Bullinger, Benjamin

Wold Engineering, PC
915 East 11th Street
Bottineau, ND 58318-
ID: ASC
W: (701) 871-7542
H:
C: (701) 201-0190
Email: ben_bullinger@woldengr.com

Busta, Brian

Cass County Highway Department
120 Main Ave W
West Fargo, ND 58078-1301
ID: ASC
W: 701/298-2378
H: 218/498-0103
C: 701/799-7714
Email: bustab@casscountynd.gov

Buzzerd, Gregory

Wold Engineering
915 E 11th St, PO Box 237
Bottineau, ND 58318-
ID: LS-6985
W: (701) 228-2292
H: 9106197892
C:
Email: gbuzzerd@woldengr.com

Caillier, Adam

Widseth Smith Nolting & Assoc.
2850 24th Ave S #201
Grand Forks, ND 58201-
ID: ASC
W: (701) 795-1975
H: 7012136917
C: (701) 317-0743
Email: adam.caillier@wsn.us.com

Carlson, Arlee

Sunde Land Surveying, LLC
9001 E Bloomington Frwy, #11B
Bloomington, MN 55420-
ID: LS-6373
W: (952) 881-2455
H: 7634278139
C: (612) 328-5312
Email: arlee@sunde.com

Caskey, Gary

KLJ
615 5th St SE
E Grand Forks, MN 56721-
ID: LS-5014
W: (701) 775-1109
H:
C: (701) 213-8891
Email: gary.caskey@kljeng.com

Cermak, Eric

Bartlett & West
3456 E Century Ave
Bismarck, ND 58503-
ID: ASC
W: (701) 258-1110
H:
C: (701) 425-7237
Email: eric.cermak@bartwest.com

Cichos, Nick

Interstate Engineering
1903 12th Ave SW
Jamestown, ND 58401-
ID: ASC
W: 701/252-0234
H: 701/320-9045
C: 701/320-4293
Email: nickcichos@gmail.com

COMBS, JOHN

PO BOX 780 Hilltop Home of Comfort
KILLDEER, ND 58640-0455
ID: LS-1238 - LIFE
W:
H: 701/764-5805
C:
Email:

Cooper, James

KLJ, Inc.
1463 I-94 Business Loop East
Dickinson, ND 58601-
ID: LS-5501
W: (701) 751-8378
H: 701/490-0921
C:
Email: jcooper@mooreengineeringinc.com

Coulombe, George

Coulombe Consulting
3701 Elliot Road NE
Bemidji, MN 56601-
ID: LS-6262
W: (218) 760-2508
H: 2184449791
C: (218) 760-2508
Email: cconsult@paulbunyan.net

Crow, Wayne

Ackerman-Estvold
3210 27th St W; Suite 200
Williston, ND 58801-
ID: LS-8517
W: (701) 577-4127
H: 7016516021
C: (701) 570-0362
Email: wayne.crow@ackerman-estvold.com

Dolinar, John Ike

William H Smith and Associates Inc
2215 Sims St
Dickinson, ND 58601-
ID:
W: (307) 389-1376
H:
C:
Email: ike@whsmithpc.com

Duchsherer, Jacob

Moore Engineering, Inc.
3319 Butterfield Drive
Bismarck, ND 58503-
ID: ASC
W: (701) 720-8662
H:
C:
Email: jduchsherer@mooreengineeringinc.com

Eldevik, Rodney

Eldevik Land Surveying, Inc.
1211 Maple Dr SE
Alexandria, MN 56308-
ID: LS-3409
W: 320/763-7566
H: 320/763-7566
C:
Email: eldevik@rea-alp.com

Elkin, Kelly

Houston Engineering
135 Sims Ste 204
Dickinson, ND 58602-
ID: ASC
W: (701) 323-0200
H:
C:
Email: Kelkin@houstoneng.com

Erbele, Boyd

Apex Engineering Group
4733 Amber Valley Parkway S
Fargo, ND 58104-
ID: LS-7986
W: (701) 373-7978
H: 7017930086
C: (701) 793-0086
Email: boyd.erbele@apexenggroup.com

Erickson, Alan

102 Division St NW
Mandan, ND 58554-
ID: LS-1202 - LIFE
W:
H: 701/222-1162
C: (701) 425-7769
Email: awerickson@bis.midco.net

Erickson, Dain

Apex Engineering Group
4733 Amber Valley Parkway South
Fargo, ND 58104-
ID: LS-5582
W: (701) 373-7973
H: 701/492-2768
C: 701/793-4382
Email: dain.erickson@apexenggroup.com

Estvold, Alan

16845 Norell Ave N
Marine on St. Croix, MN 55047-
ID: LS-1961
W:
H: 6514332887
C: (651) 491-2113
Email: aestvold@gmail.com

Fischer, Daniel

Fischer Land Surveying & Engineering
PO Box 66
Langdon, ND 58249-0066
ID: LS-3856
W: 701/256-5728
H: 701/256-2787
C: 701/370-0690
Email: dfischer@utma.com

Floden, Gerald

Retired
PO Box 321
Perham, MN 56573-
ID: LS-2036 - LIFE
W:
H:
C: 701/793-3355
Email: Gerry@gfloden.com

Flynn, Cody

City of Bismarck-Engineering
4760 N. 19th Street, Apt. 301
Bismarck, ND 58503-
ID: ASC
W: (701) 355-1531
H:
C: (701) 202-5339
Email: cody.flynnn@gmail.com

Forbes, Brian

D.R. Griffin & Associates, Inc.
1414 Elk Street #202
Rock Springs, WY 82901-
ID: LS-6611
W: (307) 362-5028
H: 3073829712
C: (307) 389-4315
Email: bforbes@drg-wy.com

Fosse, Alana

Minnkota Power Cooperative

Friedt, Jared

Houston Engineering, Inc.
5703 Copper Ridge Lane
Bismarck, ND 58504-
ID: LSI
W: (701) 323-0200
H: 7013230200
C:
Email: jfriedt@houstoneng.com

Frohlich, Jeff

622 N Mandan St
Bismarck, ND 58501-
ID: LS-3139
W: (701) 226-7954
H:
C: (701) 226-7954
Email: chefrolake@bis.midco.net

Glasoe, Curtis

Retired
1636 32nd ST E
Dickinson, ND 58601-
ID: LS-2439
W:
H: 701/225-5796
C: 701/260-9459
Email: curtglasoe@ndsupernet.com

Graham, Nicholas

Houston Engineering
111 Delaware St
Bismarck, ND 58504-
ID:
W: (701) 323-0200
H: 7013403934
C:
Email: ngraham@houstoneng.com

Graves, Deane

UINTAH
1716 Valley Bluffs Dr.
Minot, ND 58701-
ID: LS-6609
W: (701) 838-2314
H: 2488603776
C: (248) 860-3776
Email: deanegraves@gmail.com

Grimsley, Roger

Retired
5697 Pinehurst Drive
Grand Forks, ND 58201-
ID: LS-3237
W: 701/746-8087
H: 701/775-5125
C: 701/739-2483
Email: rgrimsley7@gmail.com

Grueneich, Jacob

NDSCS Student
636 Parkway Dr
Wahpeton, ND 58075-
ID: STU
W:
H: 7016405931
C: (701) 642-2723
Email: jacobgrueneich@hotmail.com

Haddick, William

Ulteig
1980 Oak Glen Trail
Stillwater, MN 55082-
ID: LS-6294
W: (651) 415-3985
H: 6128044925
C: 701/840-8567
Email: BJ4915@AOL.COM

Hagedorn, Tim

Mountain Plains, LLC
5657 Expedition Drive
Lolo, MT 59847-
ID: LS-9457
W: (406) 493-2581
H: 4065466901
C: (701) 934-0024
Email: thagedorn@mtnplains.com

HASTIG, BRYAN

INTERSTATE ENGINEERING
2019 Marian Drive
Bismarck, ND 58501-
ID: ASC
W:
H: 7015279140
C: (406) 891-0607
Email: bhastig@hotmail.com

Hearon, Eric

KLJ
1463 I-94 Business Loop E
Dickinson, ND 58601-
ID: LS-9654
W: (701) 456-3121
H: 7757725104
C: (701) 713-0362
Email: eric.hearon@kljeng.com

Heath, Brian

KLJ
1010 4th Ave SW
Valley City, ND 58072-
ID: LS-7538
W: (701) 845-9419
H:
C:
Email: brian.heath@kljeng.com

Heck, Jon

KLJ
524 N Sycamore Ave, # 1
Sioux Falls, SD 57110-
ID: LS-5186
W: 605/332-9685
H:
C:
Email: jon.heck@kljeng.com

Heglund, Dale

NDLTAP/UGPTI
8100 Sibley Drive
Bismarck, ND 58504-
ID: LS-3340
W: (701) 328-9857
H:
C: (701) 318-6893
Email: dale.heglund@ndsu.edu

Hennessy, James

Houston Engineering, Inc.
18 3rd St SE #100
Minot, ND 58701-
ID: LS-8961
W: (701) 852-7931
H: 3072726630
C: (307) 272-6630
Email: jhennessy@houstoneng.com

Herzog, Doug

1529 Chestnut Place
Grand Forks, ND 58201-
ID: LS-2355 - Life
W:
H:
C: 701/739-0054
Email: daherzog@gra.midco.net

Hillius, Joe

Coeau Properties
204 County Road 15
Beulah, ND 58523-
ID: ASC
W: (701) 873-2281
H:
C: (701) 870-0452
Email: joe.hillius@nacoal.com

Hoffart, Brian

Minnkota Power
5301 32nd Avenue S
Grand Forks, ND 58201-
ID: LS-5071
W:
H:
C: (701) 739-6024
Email: bhoffart@minnkota.com

Holm, Steven

Moore Engineering, Inc.
29926 70th Ave S
Hawley, MN 56549-
ID: LS-6571
W: (701) 282-4692
H: 218/532-2559
C: 218/850-0148
Email: sholm@mooreengineeringinc.com

Hornaday, Rick

Hornaday Land Surveying
704 Coneflower Drive
Minot, ND 58701-
ID: LS-3541
W: (701) 839-5502
H: 7018395502
C:
Email: hornaday@srt.com

Huenefeld, Curtis

Holly Beck Surveying & Engineering
929 Calvert Drive
Bismarck, ND 58503-
ID:
W: (701) 223-3546
H: 7019555645
C:
Email: chuenefeld@hollybecksurveying.com

Hummert, Aaron

Interstate Engineering
1901 31st St NW
Mandan, ND 58554-
ID: LS-7512
W: (701) 426-8624
H: 7016635455
C: (701) 426-8624
Email: aaron.hummert@interstateeng.com

Huotari, Russ

Richland County - Montana
920 12th Street SW
Sidney, MT 59270-
ID: LIFE
W: 406/433-2407
H: 4064821786
C: 406/480-2407
Email: surveyoruss@gmail.com

Illg, Robert

SEH
4719 Shelburne Street #6
Bismarck, ND 58503-5677
ID: LS-8444
W: (701) 354-7121
H:
C: (218) 770-6647
Email: rillg@sehinc.com

Indvik, Donald

Retired
606 W Pine Circle
Bottineau, ND 58318-
ID: LS-1263 - LIFE
W:
H: 701/228-2976
C: (701) 201-0194
Email: dindvik@utma.com

Ingersoll, Chris

KLJ
1604 4th Street S
Moorhead, MN 56560-
ID: LS-8887
W: (218) 287-0300
H:
C: (701) 367-1684
Email: chris.ingersoll@kljeng.com

Irwin, Leland

Coteau Properties
204 County Rd 15
Beulah, ND 58523-
ID: LSIT-11872
W: 701/873-7236
H: 701/843-8460
C:
Email: leland.irwin@nacoal.com

Isaacs, Mark

Toman Engineering
3304 14th Ave SE
Mandan, ND 58554-
ID: LS-9628
W: (701) 595-2079
H: 7015952079
C:
Email: mark@tomanengineering.com

Jackson, Eugene

1067 5th Avenue W
Dickinson, ND 58601-
ID: LS-1891 - LIFE
W:
H: 701/483-1340
C: (701) 290-7155
Email: genejackson@ndsupernet.com

Jacobson, Matthew

Territorial Landworks, Inc.
1817 South Avenue West, Suite A
Missoula, MT 59801-
ID: LS-7810
W: (406) 721-0142
H:
C:
Email: mattj@territoriallandworks.com

Janes, Jason

Janes Surveying Inc.
PO Box 146
Palmyra, MO 63461-
ID:
W: (576) 769-7020
H:
C:
Email: jason@janessurveying.com

Janke, Delbert

KLJ
PO Box 290
Dickinson, ND 58601-
ID: ASC
W:
H:
C: (701) 590-2860
Email: del.janke@kljeng.com

Jeffries, Jerry

Golden Field Services
419526 E 1070 Rd
Checotah, OK 74426-1174
ID: LS-1247
W: 918/610-0014
H: 918/473-6723
C: 918/638-3317
Email: jljeffries@goldenfieldservices.com

Jensen, Nicholas

Kadrmass, Lee & Jackson
1463 I-94 Business Loop East
Dickinson, ND 58601-
ID: ASC
W:
H:
C: (308) 430-3118
Email: nick.jensen@kljeng.com

Jensen, Troy

Uintah Engineering & Land Surveying
104 2nd Ave SW, Suite 300
Sidney, MT 59270-
ID: LS-4654
W: 406/433-9650
H: 406/488-7330
C: 406/480-0906
Email: tjensen@uintahgroup.com

Jensen, Cleone

3837 N Valley Loop, Box 2
Bismarck, ND 58503-
ID: LS-1229 - LIFE
W:
H: 7017510618
C:
Email: jensenf@bis.midco.net

Johanneck, Patrick

Houston Engineering
1401 21st Avenue N
Fargo, ND 58102-
ID:
W:
H:
C:
Email:

Johnson, Jared

Ward County Hwy Dept.
PO Box 5005
Minot, ND 58701-
ID: ASC
W: 701/838-2810
H:
C:
Email: jaredjohnson@srt.com

Johnson, Gregory

Gregory Johnson Surveying
6404 Deerewood Lane
Bismarck, ND 58503-
ID: LS-2356
W:
H: 701/255-6953
C: (701) 220-2494
Email: duckschief@bis.midco.net

Johnson, Matthew

KLJ
1010 4th Ave Sw
Valley City, ND 58072-
ID: ASC
W: (701) 845-9415
H:
C: (701) 890-5341
Email: matthew.johnson@kljeng.com

Johs, Cleary

City of Bismarck
3209 Nevada Street
Bismarck, ND 58503-
ID: LS-5288
W: 701/355-1516
H: 701/224-1589
C: 701/202-1200
Email: cjohs@bismarcknd.gov

Jones, James

Apex Engineering
2103 12th Street W
West Fargo, ND 58078-
ID: STU
W:
H: 7015522731
C: (701) 552-2731
Email: james.jones2902@gmail.com

Jordan, Michael

Brosz Engineering
10081 Ventura Lane
Summerset, SD 57718-
ID: LS-3542
W: (605) 347-2722
H: 6052060344
C:
Email: mikej@broszengineering.com

Jordheim, Christopher

Widseth Smith Nolting & Assoc.
1406 Elm Coulee Dr NE
Thompson, ND 58278-
ID: LS-5773
W: 701/795-1975
H: 701/599-2321
C: 218/779-8696
Email: chris.jordheim@wsn.us.com

Jorgenson, Kirk

KLJ
1463 I-94 Business Loop East
Dickinson, ND 58601-
ID: LS-3592
W: 701/483-1284
H: 701/225-1644
C: 701/260-3638
Email: kirk.jorgenson@kljeng.com

Jung, James

Retired
51430 176th Ave Way
Pine Island, MN 55963-6720
ID: LS-2357 LIFE
W:
H: 7018401781
C: (701) 840-1781
Email: jamesjung80@gmail.com

Kainz, Robert

KLJ
1010 4th Ave SW
Valley City, ND 58072-
ID: ASC
W: (701) 890-6093
H: 7017899473
C:
Email: robert.kainz@kljeng.com

Kastelle, Russell

Kastelle Land Surveying
518 Minnesota Ave
Breckenridge, MN 56520-
ID: LS-1170
W: 218/643-1429
H: 218/643-3284
C:
Email: rek@wah.midco.net

Kautz, Leroy

Interstate Engineering
248 19th Ave NE
Jamestown, ND 58402-
ID: LS-1177
W: 701/252-0234
H: 701/952-1177
C: 701/320-4289
Email: ledodkautz@daktel.com

Kieso, Robert

Helms & Associates
221 Brown County #19
Aberdeen, SD 57401-
ID: LS-7228
W: (605) 225-1212
H: 6053802711
C: (605) 380-2711
Email: bobk@helmsengineering.com

Kisch, Kurt

Ulteig
9867 Revere Lane
Maple Grove, MN 55369-
ID: LS-4597
W: (651) 415-6667
H: 763/425-2955
C: (612) 250-4533
Email: kurt.kisch@ulteig.com

Kohler, Robert

BEPC
1309 E Divide Ave
Bismarck, ND 58501-
ID: LS-6718
W: (701) 516-4434
H: 7015164434
C: (701) 516-4434
Email: rkohler@bepc.com

Kohler, Richard

Retired
2911 Harder Drive
Gillette, WY 82718-
ID: LS-2758 - LIFE
W: 307/686-6750
H: 307/686-9168
C:
Email: dkohler326@msn.com

Krebs, Mathias

Retired
1123 9th St E
Dickinson, ND 58602-
ID: LS-3214 LIFE
W:
H: 701/483-4931
C: 701/260-3607
Email: matt.krebs97@gmail.com

KREIN, LELAND L

4011 CONNAR DR
Bismarck, ND 58503-
ID: LS-3148 Life
W:
H:
C:
Email: lkrein@state.nd.us

Krug, Patrick

CPS, LTD
308 2nd Ave N
Grand Forks, ND 58201-
ID: LS-3289
W: (701) 746-7459
H:
C: (701) 330-1009
Email: pat.krug@cpsengineering.net

Krumm, Hope

Houston Engineering
2300 46th Ave SE, 216
Mandan, ND 58554-
ID: ASC
W: (701) 323-0200
H:
C: (701) 851-0121
Email: hkrumm@houstoneng.com

Krumwiede, Michael

SCG
PO Box 7370
Bismarck, ND 58507-7370
ID:
W:
H: 7012233184
C:
Email: mike@scgnd.com

LACOUNT, RON

ROLAC CONTRACTING INC
PO BOX 1872
MINOT, ND 58702-
ID: LS-1151 - LIFE
W: 701/839-6525
H: 701/839-8786
C: 701/833-3763
Email: ronald@rolac-nd.com

Lambrecht, Mark

Advanced Engineering
4050 Garden View Dr #200
Grand Forks, ND 58201-
ID: LS-2511
W: 701/746-8087
H: 2187912477
C: (218) 791-2477
Email: mark.lambrecht@ae2s.com

Langerud, Tim

Swenson, Hagen & Co.
909 Basin Ave
Bismarck, ND 58504-
ID: LS-5770
W: 701/223-2600
H:
C:
Email: tlangerud@swensonhagen.com

Langlie, Steve

Bartlett & West
3456 E Century Ave
Bismarck, ND 58503-
ID: LS-5476
W: (701) 258-1110
H:
C: (701) 390-4919
Email: stevelanglie5476@gmail.com

Leach, Rick

KLJ
1463 I-94 Business Loop East
Dickinson, ND 58601-
ID: LS-3496
W: 701/483-1284
H:
C: 701/260-3169
Email: rick.leach@kljeng.com

Leas, Jarrett

KLJ
1024 Thiesse Dr
Brainerd, MN 56401-
ID: LS-8732
W: (218) 828-6330
H: 2189633534
C: (218) 443-3830
Email: jarrett.leas@kljeng.com

LECLERC, RAY

RETIRED
5616 BELMONT ROAD
GRAND FORKS, ND 58201-3201
ID: LS-1149 - LIFE
W:
H: 701/772-5714
C:
Email:

Leshovsky, Thomas

Wold Engineering, PC
110 8th Ave SW
Minot, ND 58701-
ID: LS-6134
W: 701/852-0338
H: 701/838-8305
C: 701/720-2416
Email: tomsky@srt.com

Liebold, Felix

KLJ
1010 4th Ave SW
Valley City, ND 58072-
ID: LS-8441
W: 701/845-4980
H: 7013200059
C: 701/490-1340
Email: felix.liebold@kljeng.com

Lindvig, John (Jack)

Retired
418 West Reno Avenue
Bismarck, ND 58504-
ID: LS-3855
W:
H: 701/355-2254
C: (701) 595-1284
Email: yellowx2@bis.midco.net

Link, Ryan

CPS, LTD
308 2nd Ave N
Grand Forks, ND 58203-
ID: LS-7590
W: 701/746-7459
H:
C: (701) 740-2430
Email: ryan.link@cpsengineering.net

Link, Kenneth

613 4th Street NE
Hazen, ND 58545-
ID: LS-1242
W:
H: 701/748-2827
C:
Email: kenlink@westriv.com

Loomer, Donald

4904 Prairie Lane
Williston, ND 58801-
ID: LS-2681
W:
H: 701/774-3674
C: (701) 770-2576
Email: dloomer@nemont.net

Main, Jason

Ackerman Surveying & Assoc.
1907 17th Street SE
Minot, ND 58701-
ID: LS-8134
W: (701) 838-0786
H: 8123430464
C: (701) 509-3773
Email: jason.main@ackermansurveying.com

Manchester, Ronald

Toman Engineering Co
501 1st St NW
Mandan, ND 58554-
ID: LS-3252
W: 701/663-6483
H: 701/663-4000
C: (701) 400-9396
Email: ron@tomanengineering.com

Markusen, Dennis

KLJ
864 W 12th Street
Grafton, ND 58237-
ID: LS-1194
W: 701/352-1555
H: 701/352-3774
C: 701/331-1530
Email: dennis.markusen@kljeng.com

Marquardt, Andra

Toman Engineering Co
402 7th St NW
Mandan, ND 58554-
ID: LS-4623
W: 701/663-6483
H: 701/667-2875
C:
Email: amarq013@yahoo.com

Marschall, Todd

Houston Engineering
88 McDougall Drive
Lincoln, ND 58504-
ID: LS-4431
W: (701) 323-0200
H: 701/223-2345
C:
Email: tmarschall@houstoneng.com

Martin, Kevin

Bartlett & West
3456 E Century Ave
Bismarck, ND 58503-
ID: LS-7062
W: (701) 258-1110
H:
C: (701) 226-1261
Email: kevin.martin@bartwest.com

May, George

Retired
34142 Camp Cherith RD
Frazee, MN 56544-
ID: LS-2360 - LIFE
W:
H: 218/334-4275
C:
Email:

McCormick, Kevin

Land Design Solutions
11821 Lane Trail
Crosslake, MN 56442-
ID: LS-6174
W: (218) 820-0854
H:
C: (218) 820-0854
Email: kevin@landdesignsolution.net

McCoy, Trace

Meyer-Rohlin Land Services
708 1st Ave NE #1
Buffalo, MN 55313-
ID: LS-6808
W: (763) 682-1781
H: 3205586091
C:
Email: trace@meyerrohlin.com

McDonald, Dan

ND State Water Commission
900 E Boulevard Ave
Bismarck, ND 58506-
ID: ASC
W: 701/328-3093
H:
C: (701) 202-6748
Email: dmcdonald@nd.gov

McElwain, Jeffery

Ackerman-Estvold Engineering
1907 17th St SE
Minot, ND 58701-
ID: ASC
W: 701/837-8737
H: 701/839-6821
C: 701/720-4038
Email: jmcElwain@srt.com

McGaughey, Ethan

Student
1302 14th Street SE
Grand Forks, MN 56721-
ID:
W:
H: 2187914380
C: (218) 791-4380
Email: ethan.mcgaughey1@gmail.com

McKenzie, Malcolm

McKenzie Snyder, Inc.
996 18th Ave Cir N
Moorhead, MN 56560-
ID: ASC
W: (703) 298-5196
H: 7032985196
C:
Email: allojohn1@gmail.com

Mead, Todd

KLJ
4585 Coleman Street
Bismarck, ND 58503-
ID: LSIT
W: (701) 355-8400
H: 7012907756
C: (651) 491-9572
Email: todd.mead@kljeng.com

Moore, Courtney

Widseth Smith Nolting
3535 31st Street South, Ste 203
GRAND FORKS, ND 58201-
ID: ASC
W:
H:
C:
Email: courtney.moore@wsn.us.com

Morgenstern, Les

Ducks Unlimited
6820 Endicott Dr
Bismarck, ND 58503-
ID: ASC
W: (701) 355-3564
H: 7013912250
C:
Email: lmorgenstern@ducks.org

Morman, Charles

Retired
2388 67th Ave S
Fargo, ND 58104-
ID: LS-1178 - LIFE
W:
H:
C:
Email: csmorman@cableone.net

Nagel, Derek

KLJ
1025 Airport Road
Bismarck, ND 58503-
ID: ASC
W: (701) 355-8400
H: 7015271856
C:
Email: derek.nagel@kljeng.com

Nash, David

JSD Professional Services, Inc.
N52W35045 Lake Dr
Okauchee, WI 53069-
ID: LS-7974; LS-2085 WI
W:
H: 4144161178
C:
Email: dnash1@wi.rr.com

Neiber, Braeden

Widseth Smith Nolting
3750 Rummele Road
Grand Forks, ND 58201-
ID: ASC
W: (701) 864-0484
H:
C: (701) 403-4278
Email: braeden.neiber@wsn.us.com

Nelson, Kevin

Wenck Associates
5004 Cornice Drive
Bismarck, ND 58503-
ID: LS-3638
W: (701) 751-6137
H: 7012582818
C: (701) 333-8164
Email: vinnyg@midco.net

Nelson, Joshua

Wenck Associates
3513 21st ST S
Fargo, ND 58104-
ID: LSI
W: (701) 306-9685
H: 7013069685
C: (701) 306-9685
Email: jnelson@wenck.com

Ness, Jason

Mead & Hunt, Inc.
1389 140th Ave NE
Hatton, ND 58240-
ID: LS-6884
W: (701) 566-6452
H:
C: (218) 779-8239
Email: jason.ness@meadhunt.com

Ness, Gary

Mead & Hunt
8 Seventh St N
Fargo, ND 58102-
ID: LS-3461
W: (701) 566-6451
H:
C: 701/799-8927
Email: gary.ness@meadhunt.com

Nighswonger, Jeffrey

Ralph L. Wadsworth
7585 S. 1000 E
Midvale, Utah 84047-
ID:
W:
H: 7014496963
C:
Email:

Norby, Aaron

KLJ
3106 Wisconsin Drive
Bismarck, ND 58503-
ID: LS-5589
W: (701) 355-8400
H: 7012232756
C:
Email: aaron.norby@kljeng.com

Norton, Todd

AE2S
1815 Schafer Street #301
Bismarck, ND 58501-
ID: LS-4624
W: 701/221-0530
H: 701/843-8719
C:
Email: Todd.Norton@ae2s.com

Obrigewitch, Greg

The Falkirk Mining Company
1513 Prairie Hawk Drive
Bismarck, ND 58503-
ID: LS-4114
W: 701/250-2412
H: 7018705469
C: 701/870-5469
Email: greg.obrigewitch@nacoal.com

Obrigewitsch, Quentin

KLJ
1463 I-94 Business Loop East
Dickinson, ND 58601-
ID: LS-5999
W: 701/483-1284
H:
C:
Email: quentin.obrigewitsch@kljeng.com

Obrigewitsch, Geoff

KLJ, Inc.
12424 23rd Street SW
Belfield, ND 58622-
ID:
W:
H:
C:
Email: geoff.obrigewitsch@kljeng.com

Olson, Joseph

Webster, Foster & Weston
1616 Mill Road
Grand Forks, ND 58201-
ID: ASC
W: (701) 775-3263
H:
C:
Email: josepho@wfwengineers.com

Olson, Peter

Self-Employed
PO BOX 729
Culbertson, MT 59218-0729
ID: LS-5281
W:
H: 406/787-5215
C: 406/480-1608
Email: paolsonfh4@yahoo.com

Olson, Carl

KLJ
1208 42nd Ave N
Fargo, ND 58102-
ID: LS-4687
W: 218/287-0300
H: 701/239-2518
C: 218/790-2931
Email: carl.olson@kljeng.com

Orvik, Kent

Retired
10129 Ewing Lane N
Brooklyn Park, MN 55443-
ID: LS-3463
W:
H: 7012224536
C: (612) 404-4268
Email: kent.orvik@hotmail.com

Orvik, Gregg

KLJ
2900 10th SW Ste A
Minot, ND 58702-0250
ID: LS-3881
W: 701/839-3383
H: 701/839-1436
C: 701/720-0234
Email: gregg.orvik@kljeng.com

Osse, Zane

Swenson, Hagen & Company
909 Basin Avenue
Bismarck, ND 58503-
ID:
W: (701) 223-2600
H: 7018058944
C:
Email: zosse@swensonhagen.com

Paulson, John

Brosz Engineering
PO Box 781
Bowman, ND 58623-
ID: LS-3366
W: 701/523-3340
H: 701/523-5547
C:
Email: johnp@broszengineering.com

Portwood, Brian

6918 NE 66th Street
Vancouver, WA 98661-
ID: LS-5280
W: (360) 619-6495
H: 3602580808
C:
Email: bportwood@mindspring.com

Powers, James

Red Plains Surveying Company
1917 S Harvard
Oklahoma City, OK 73128-
ID: LS-6050
W: (405) 603-7842
H: 4053543460
C: (405) 706-5626
Email: mick@rpsurveying.com

Prevost, William

KLJ, Inc.
8209 26th Avenue NW
Lansford, ND 58750-
ID:
W:
H: 7015002559
C:
Email: williamprevost@kljeng.com

Pribula, Nicholas

Pribula Engineering, PLLC
3210 Belmont Rd
Grand Forks, ND 58201-
ID: LS-8587
W: (701) 772-7058
H: 7013888450
C: (701) 388-8450
Email: npribula@gmail.com

Pribula, Ben

Pribula Engineering, PLLC
208 3rd Ave NW
East Grand Forks, MN 50721-
ID: LSI
W:
H:
C: (701) 739-5980
Email: ben.pribula@gmail.com

Privratsky, James

1053 Dell Avenue
Dickinson, ND 58601-
ID: LS-3878 Life
W:
H: 701/225-1045
C: 701/260-2318
Email: ajjjsm@ndsupernet.com

Procive, Robert

Interstate Engineering, Inc
12760 35th St SW
Belfield, ND 58622-
ID: LS-2884
W: 701/575-2247
H: 701/575-4099
C: 701/290-5775
Email: robert.procive@interstateeng.com

Rebsch, Charles

Houston Engineering
4101 Ashton Court S
Fargo, ND 58104-
ID: LS-6610
W: (701) 237-5065
H: 7012936674
C: (701) 412-3235
Email: crebsch@houstoneng.com

Richter, James

City of Grand Forks
255 N 4th St, PO Box 5200
Grand Forks, ND 58206-
ID: ASC
W:
H:
C:
Email: jrichter@grandforksgov.com

Rintamaki, Edward

49th Latitude Land Survey, LLC
13046 74th St NW
Alamo, ND 58830-
ID: LS-7664
W: (701) 580-2651
H: 7015284342
C: (701) 580-2651
Email: erintamaki@49latitudelandsurvey.com

Robertson, Bradley

Wold Engineering, PC
PO Box 237
Bottineau, ND 58318-
ID: LS-3199
W: 701/228-2292
H: 701/228-3679
C:
Email: brobert@woldengr.com

Robinson, Chris

Highlands Engineering & Surveying
319 24th St E
Dickinson, ND 58601-
ID: LS-8608
W: (701) 483-2444
H:
C: (701) 260-5036
Email: robinson@highlandseng.com

Rosas, Antonio

Bartlett & West
3456 E Century Ave
Bismarck, ND 58503-
ID: ASC
W: (701) 258-1110
H:
C: (701) 527-4131
Email: antonio.rosas@bartwest.com

Rosenthal, Jack

Compass Consultants
150 2nd St SW
Perham, MN 56573-
ID: LS-8425
W: (218) 850-0207
H: 2188500207
C:
Email: jack.rosenthal@trustcompass.com

Rude, Steven

AE2S
103 1st Ave W #300
Dickinson, ND 58601-
ID: LS-6261
W: (701) 225-6564
H:
C:
Email: steve.rude@ae2s.com

Rudolph, Kirby

Holly Beck Surveying & Engineering
1027 N. 29th Street
Bismarck, ND 58501-
ID: ASC
W: 701/223-3546
H: 7012264801
C:
Email: krudolph@hollybecksurveying.com

Sagsveen, David

Bismarck State College
1530 Columbia Drive
Bismarck, ND 58504-

ID: ASC
W: (701) 224-5443
H: 7012504824

C:
Email: david.sagsveen@bismarckstate.edu

Sailer, Shelley

AE2S

,
ID:
W:
H:

C:
Email:

Sanderson, Soren

City of Bismarck
800 Lincoln Ct SE
Mandan, ND 58554-

ID: ASC
W: (701) 214-2842
H:

C: (701) 214-2842
Email: ssanderson@bismarcknd.gov

Sansom, Michael

CPS, LTD
308 2nd Ave N
Grand Forks, ND 58203-

ID: LS-3141
W: 701/738-4052
H:

C: (218) 791-1676
Email: mike.sansom@cpsengineering.net

Sauber, John

Sauber Engineering
1602 9th Ave NW
Mandan, ND 58554-

ID: LS-8427
W: (701) 751-5993
H:

C: (701) 220-3809
Email: jsauber@sauberengineering.com

Schaar, Trevor

The Falkirk Mining Co.
5422 Dietrich Pl
Bismarck, ND 58503-

ID: LSI
W: (701) 250-2605
H: 7013917498

C:
Email: trevor.schaar@nacoal.com

Schirado, Dustin

Bartlett & West
3456 E. Century Ave
Bismarck, ND 58503-

ID: ASC
W: (701) 258-1110
H: 7015275988

C:
Email: dustin.schirado@bartwest.com

Schlieman, Jim

Houston Engineering, Inc.
1401 21st Ave N
Fargo, ND 58102-

ID: LS-6086
W: 701/237-5065
H:

C:
Email: jschlieman@houstoneng.com

SCHWINDT, DAVID

KADRMAS LEE AND JACKSON
PO BOX 290
DICKINSON, ND 58602-

ID: LS-1232- LIFE
W: 701/483-1284
H: 701/225-5542

C: (701) 260-2297
Email: dave.schwindt@kljeng.com

Seibel, Stanley

The Coteau Properties
204 County Road 15
Beulah, ND 58523-

ID: LS-3950
W: 701/873-7242
H: 701/748-6270

C:
Email: stan.seibel@nacoal.com

Sherlock, Becky

KLJ
1701 12th Street SW
Minot, ND 58701-
ID: ASC
W: (701) 839-3383
H: 7017201104
C:
Email: becky.sherlock@kljeng.com

Skarphol, Curtis

17135 54th Street SE
Horace, ND 58047-9600
ID: LS-4723
W:
H: 701/293-0827
C:
Email: cskarphol@houstonengineeringinc.com

Skipton, Bruce

Apex Engineering Group
2702 Serenity Drive
St. Cloud, MN 56301-
ID: LS-8251
W: (701) 373-7976
H:
C: (218) 760-1130
Email: bruceskipton@gmail.com

Sletvold, Dusty

1998 Goldenrod Lane
Sidney, MT 59270-
ID: LS-6885
W: (406) 488-4532
H: 4064884532
C:
Email: dsletvold@gmail.com

Small, Michael

MKEC Engineering
15931 E. Plymouth Road
Wichita, KS 67230-
ID: LS-8220
W: (316) 684-9600
H: 3167752781
C: (316) 259-9888
Email: msmall@mkec.com

Smith, Larry

SES Geomatics
2321 Harding Avenue
Bismarck, ND 58501-2233
ID: LS-2363
W: (701) 220-9843
H: 701/258-3827
C: (701) 220-9843
Email: ljs2363@midco.net

Solem, Dayne

Barlett & West
3456 E Century Ave
Bismarck, ND 58503-
ID: LS-8423
W: (701) 258-1110
H:
C: (701) 400-2785
Email: dayne.solem@bartwest.com

Sorenson, Timothy

Hansen Thorp Pellinen Olson, Inc.
7510 Market Place Drive
Eden Prairie, MN 55344-
ID: LS-8610
W: (701) 774-3080
H:
C: (701) 570-4636
Email: Tsorenson@htpo.com

Sorsenson, Tim

Advanced Engineering
1102 Main Street
Williston, ND 58801-
ID:
W: (701) 774-3080
H: 7015704636
C:
Email: Tim.Sorenson@AE2S.com

Stadler, Nate

Bolton & Menk, Inc.
2638 Shadow Lane #200
Chaska, MN 55318-
ID: LS-9240
W: (612) 756-0957
H:
C:
Email: natest@bolton-menk.com

Stanhope, Bob

W.B.I. Energy Transmission
2010 Montana Ave
Glendive, MT 59330-
ID: LS-3593
W: 406/359-7200
H: 406/365-6339
C: 406/989-1062
Email: bob.stanhope@wbienergy.com

Stattelman, Nick

AE2S
4170 28th Avenue S
Fargo, ND 58104-
ID: LS-8218
W: (218) 299-5610
H: 218/230-4358
C: 218/230-4358
Email: Nick.Stattelman@ae2s.com

Stephens, Brooke

ND DOT
3270 45th Avenue
New Salem, ND 58563-
ID:
W:
H: 7012141829
C:
Email: bsicble@live.com

Stern, Matthew

Swenson, Hagen & Co.
909 Basin Ave
Bismarck, ND 58504-
ID: LS-8299
W: (701) 223-2600
H: 7019341969
C:
Email: mstern@swensonhagen.com

Strain, Miles

Quantum Spatial, Inc.
18391 Smith Ct
Elk River, MN 55330-
ID: SUS
W: (763) 420-9606
H:
C: (763) 442-3398
Email: mstrain@quantumspatial.com

Stroeing, Gregg

Bolton & Menk
4298 Red River Trail SW
Pillager, MN 56473-
ID: LS-6703
W: (701) 280-8714
H:
C: (320) 333-5873
Email: greggstroeing@gmail.com

Swanson, Steven

AE2S
4050 Garden View Drive #200
Grand Forks, ND 58201-
ID: LS-4185
W: 701/746-8087
H:
C:
Email: Steve.Swanson@ae2s.com

Taney, Maguire

Holly Beck Surveying
2130 S 12th Street
Bismarck, ND 58504-
ID:
W: (701) 223-3546
H:
C: (575) 915-4218
Email: mtaney@hollybecksurveying.com

Tarnowski, Mike

Apex Engineering Group
3306 Jordan Street
Bismarck, ND 58503-
ID: LSI
W: (701) 580-8540
H:
C: (701) 580-8540
Email: mike.tarnowski@apexenggroup.com

Taylor, Shelton

KLJ
4306 Boulder Ridge Road
Bismarck, ND 58503-
ID: LS-8422
W: (701) 355-8712
H:
C: (701) 989-4570
Email: pex998@gmail.com

Taylor, Ricky

William H Smith and Associates Inc.
2215 Sims Street
Dickinson, ND 58601-
ID: LS-10650
W: (701) 483-1436
H:
C: (307) 389-7019
Email: rtaylor@whsmithpc.com

Ternes, James P.

ND SWC
900 E. Boulevard Avenue
Bismarck, ND 58501-
ID:
W: (701) 328-2304
H: 7018700810
C:
Email: jpternes@nd.gov

Thiel, Alex

Moore Engineering
925 10th Avenue E
West Fargo, ND 58078-
ID:
W: (701) 282-4692
H:
C:
Email: athiel@mooreengineeringinc.com

Thomasson, Shawn

Moore Engineering, Inc.
13138 Loon Lane
Lake Park, MN 56554-9100
ID: LS-5900
W: (701) 499-5890
H:
C:
Email: sthomasson@mooreengineeringinc.com

Thomsen, Dan

Swenson, Hagen & Co.
909 Basin Ave
Bismarck, ND 58504-
ID: ASC
W: (701) 223-2600
H:
C:
Email: dthomsen@swensonhagen.com

Vender, Carl

Semi-Retired
6029 Linck Circle
Shepherd, MT 59079-4416
ID: LS-1222
W:
H: 4063730997
C:
Email: grandpavender@yahoo.com

Voegele, Dennis

Retired
3629 Wolf Creek Road
Coleharbor, ND 58531-
ID: LS-2925 - LIFE
W:
H: 701/442-5726
C:
Email: voegele@westriv.com

Volesky, Steven

USDA Forest Service
60 8th St W
Dickinson, ND 58601-
ID: LS-3367
W: 701/227-7855
H: 701/483-6992
C:
Email: svolesky@fs.fed.us

Vosberg, Dusty

Interstate Engineering
1016 1st Street S
Wahpeton, ND 58075-
ID: LSI
W: (701) 642-5521
H:
C: (701) 640-9423
Email: dustyvosberg@gmail.com

Walter, Alan

Ackerman-Estvold
805 Bavaria Drive
Minot, ND 58702-
ID: LS-1174
W: (701) 837-8737
H: 701/838-5258
C:
Email: alan.walter@ackerman-estvold.com

Walter, Brian

Ward County Hwy Dept.
PO Box 5005
Minot, ND 58701-
ID: ASC
W: 701/838-2810
H: 701/839-1102
C: 701/721-1824
Email: brian.walter@wardnd.com

Wamre, Ross R.

Survey Mapping Solutions INC.
14652 85th Ave
Little Falls, MN 56345-
ID: LS-4626
W: (218) 850-8334
H: 2188508334
C:
Email: rossw@surveymapsolutions.com

Weeks, Matthew

Compass Rose Consulting
3131 Arizona Avenue
Bismarck, ND 58503-
ID: LS-3626
W: (701) 471-8973
H: 701/255-2918
C: 701/471-8973
Email: mweeks@compassrosend.com

Weeks, JW

AE2S
1815 Schafer St #301
Bismarck, ND 58501-
ID: LS-10638
W: (701) 221-0530
H:
C: (701) 955-5829
Email: jw.weeks@ae2s.com

Westrum, Rodney

Westrum's Land Surveying
7010 3rd Ave E
Williston, ND 58801-
ID: LS-1195
W: (701) 774-8605
H: 7017740316
C: (701) 580-6327
Email: rwestrum@nemontel.net

Whetham, Allen

Retired
1007 23rd Ave S
Grand Forks, ND 58201-
ID: LS-2997
W:
H: 7013309403
C:
Email: azwhetham@yahoo.com

Wicklund, John

Wicklund Surveying
1119 University Dr #1016
Bismarck, ND 58504-
ID: LS-2491
W: 701/400-3797
H: 701/400-3797
C: 701/400-3797
Email: jjrw2492@aol.com

Wiens, Peter

Bartlett & West
3456 E Century Ave
Bismarck, ND 58503-
ID: ASC
W: 701/258-1110
H: 701/400-9377
C:
Email: pete.wiens@bartwest.com

Winkler, Scott

KLJ
1010 4TH Avenue SW
Valley City, ND 58072-
ID: ASC
W: 701/845-4980
H: 701/845-1151
C: 701/490-1614
Email: scott.winkler@kljeng.com

Wisted, Bradley

Short Elliott Hendrickson, Inc
7712 White Overlook Drive
Breezy Point, MN 56472-
ID: LS-9841
W: (218) 290-2273
H: 2182902273
C:
Email: bwisted@sehinc.com

Wittstock, Jerome

Westwood Professional Svcs
PO Box 464
River Falls, WI 54022-
ID: LS-5869
W:
H:
C: 612/799-1829
Email: jay.wittstock@westwoodps.com

Wurgler, Jeremy

Houston Engineering, Inc.
4440 49th St S
Fargo, ND 58104-
ID: LS-6918
W: (701) 237-5065
H:
C: (701) 261-1392
Email: jwurgler@houstoneng.com

Young, Mark

Roughrider Electric Coop
PO Box 93
Dickinson, ND 58602-
ID: LS-10661
W: (701) 690-6470
H: 7013002336
C: (701) 300-2336
Email: myoung@roughriderelectric.com

Zelmer, Bruce

Bartlett & West, INC
3456 E Century Ave
Bismarck, ND 58503-
ID: LS-5672
W: (701) 221-8349
H:
C: 701/226-2961
Email: bruce.zelmer@bartwest.com

Zeltinger, Brett

KLJ
4585 Coleman Street
Bismarck, ND 58503-
ID: PLS-27331
W: (701) 355-8400
H:
C: (701) 721-6247
Email: brett.zeltinger@kljeng.com

Zimny, Michael

Meridian Land Surveys
1022 E Divide Ave #G
Bismarck, ND 58501-1902
ID: LS-3132
W: 701/258-2424
H: 701/258-9750
C: 701/471-1861
Email: dlandsurveys@netscape.net

Membership Data

YEAR	LIFE	NSPS	PLS	LSI	NEW PLS	ASSOC	SUS	STUDENT	TOTAL
1979	0		78	0		?	?	?	133
1980	0		93	0		63	7	6	169
1981	0		107	0		73	9	2	191
1982	0		109	0		56	8	0	173
1983	0		104	0		61	8	1	174
1984	0		0	0		0	0	0	0
1985	0		107	0		38	6	0	151
1986	0		106	0		44	7	4	161
1987	0		101	0		46	6	4	157
1988	0		94	0		37	6	6	143
1989	0		88	0		44	7	0	139
1990	0		88	0		32	7	2	129
1991	0		76	0		28	5	2	111
1992	0		83	0		23	6	0	112
1993	0		68	9		21	5	0	103
1994	3		102	11		27	4	0	147
1995	3		108	11		25	7	2	156
1996	3		116	7		27	8	3	164
1997	1		114	8		21	8	1	153
1998	1		126	9		21	7	0	164
1999	1		112	8		26	8	1	156
2000	2		130	11		33	7	14	197
2001	6		126	11		28	4	8	183
2002	5		148	11		36	5	3	208
2003	6		132	10		36	6	1	191
2004	8		145	11	9	40	9	3	225
2005	10		133	17	7	45	9	2	223
2006	10		135	18	7	50	8	3	231
2007	11		133	23	3	47	7	1	225
2008	9		139	18	9	55	8	1	239
2009	12		136	17	30	59	8	4	266
2010	13		145	26	10	60	8	1	263
2011	15		153	27	14	64	8	1	282
2012	16		184	26	2	74	10	1	339
2013	16		195	26	2	61	8	1	309
2014	14	139	198	23	3	59	6	0	303
2015	12	170	212	20	1	77	5	1	328
2016	12	154	204	18	5	70	2	26	337
2017	14	132	191	18	1	61	5	2	292
2018	18	117	153	10	0	48	2	2	235
2019	22	138	142	9	1	50	2	1	227



NDSPLS ADMINISTRATIVE OFFICE
 PO Box 7370
 Bismarck, ND 58507
 Phone: 701-223-3184
 E-mail: info@ndspls.org
 Website: www.ndspls.org

Membership Application

(please check which year you are applying for membership)

2018 2019 2020 2021

Name _____ North Dakota Registration # _____

Employer _____

Mailing Address (Preferred address to receive Society correspondence) _____

City/State/Zip _____ Year of Birth _____

Phone (Business) _____ (Home) _____ (Cell) _____

E-mail _____

Education (years completed)

High School _____ College _____ Other _____

Diplomas, Certificates, or Degrees _____

Name of School _____

Experience in land surveying profession (number of years)

Pre-Professional _____ Professional _____ Total _____

Class of Membership Applied for:

(Please review **Membership Categories** to the right to verify your membership status)

- Professional & ND Resident (PLS) - \$165.00 Associate (ASC) - \$20.00
 Professional - Nonresident (PLS) - \$125.00 Honorary (HON) - \$0.00
 Sustaining (SUS) - \$200.00 Life (LIFE) - \$0.00
 Land Surveyor Intern (LSI) - \$75.00 Student (STU) - \$5.00
 NDPS Member - \$40.00 (optional for all except PLS/ND Resident)

I agree to observe the By-Laws of the North Dakota Society of Professional Land Surveyors and to support it in its endeavors.

Date _____ Signature _____

NOTE: NDSPLS annual dues are for the calendar year
 January 1 - December 31

Return this form with your payment to:

NDSPLS, PO Box 7370., Bismarck, ND 58507

AFFILIATE OF NATIONAL SOCIETY OF PROFESSIONAL SURVEYORS

Membership Categories

The members of this Society shall be those persons who a) shall be eligible for membership under the provisions of the classes of members listed below; and b) shall have been elected to membership, upon the recommendation of the Membership Committee.

- ◆ Professional (PLS) - Those members who are registered land surveyors pursuant to the laws of the state of North Dakota.
- ◆ Land Surveyor Intern (LSI) - Those members who have met the requirements pursuant to the laws of the state of North Dakota.
- ◆ Associate (ASC) - Those members who are registered and in good standing as land surveyors either in any state of the United States other than North Dakota or in any province of Canada or are those members who have an affiliate interest in the surveying profession.
- ◆ Sustaining (SUS) - Those members, either individuals, partnerships, or corporations who or which are engaged either in the manufacture or distribution of surveying instruments or equipment, or in the compilation or reproduction of maps, or in the performance of services for land surveyors.
- ◆ Student (STU) - Those members who are full-time students studying surveying.
- ◆ Honorary (HON) - Those members who have attained unusual professional recognition by their contributions to the profession of land surveying.
- ◆ LIFE (LIFE) - Those members who have attained 60 years of age and have retired from active practice as land surveyors and who have paid dues for each of the nine years preceding and also in the year which they attained such age or so retired, whichever is later.
- ◆ NSPS Member - Those members who are or would like to be members of the National Society of Professional Surveyors.